

NOTE:

1. REFER TO PRODUCT DATA SHEETS FOR SPECIFIC APPLICATION METHODS.

This detail is for general informational purposes only. The project design professional determines, in its sole discretion, whether this detail or a functionally equivalent detail is best suited for the project with respect to any architecture, engineering, and design requirements, including any local building code requirements. If this document is not reviewed and the product is not approved for use by a licensed design professional, the customer agrees that the detail may contain substantive flaws requiring correction, and hereby releases Schul International Co., LLC d/b/a Willseal from any and all liability related to the design and installation of the product. This detail is subject to change without notice. Contact Willseal to ensure you have the most recent version.

Willseal Protector Plate™ - Hinged



Willseal Technical Support: 800-274-2813

Detail: Floor to Floor Joint

Drawn by: KAB

Revision #: 1

Checked by: AM

Revised by: HDE

Scale: 6" = 1'-0"

Date: 10/30/2025

www.tremcocpg.com

File Name:

WPP-H-FF-01



Construction Products Group

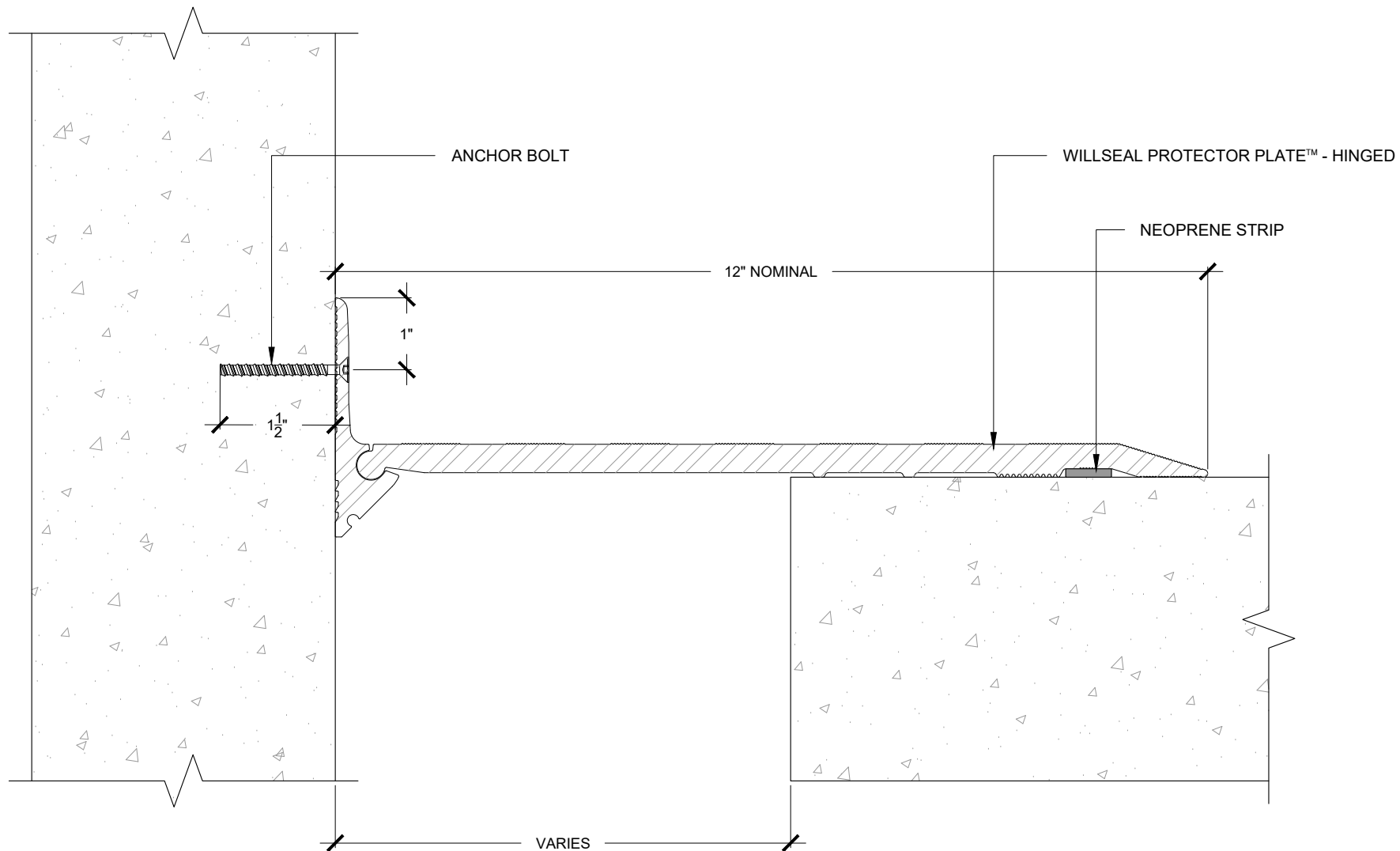

NOTE:

1. REFER TO PRODUCT DATA SHEETS FOR SPECIFIC APPLICATION METHODS.

This detail is for general informational purposes only. The project design professional determines, in its sole discretion, whether this detail or a functionally equivalent detail is best suited for the project with respect to any architecture, engineering, and design requirements, including any local building code requirements. If this document is not reviewed and the product is not approved for use by a licensed design professional, the customer agrees that the detail may contain substantive flaws requiring correction, and hereby releases Schul International Co., LLC d/b/a Willseal from any and all liability related to the design and installation of the product. This detail is subject to change without notice. Contact Willseal to ensure you have the most recent version.

Willseal Protector Plate™ - Hinged



Willseal Technical Support: 800-274-2813

Detail: Floor to Wall Joint

Drawn by: KAB

Revision #: 1

Checked by: AM

Revised by: HDE

Scale: 6" = 1'-0"

Date: 10/30/2025

www.tremcocpg.com

File Name:

WPP-H-FW-01



Construction Products Group