

# PROGLAZE® ETA

Minimize Risk & Maximize Control of Air & Moisture Infiltration with this Ribbed Silicone Extrusion

## Product Overview

Proglaze® ETA is a solution to seal complex connections and transitions within the building envelope to prevent air and moisture infiltration. It is uniquely suited to seal critical areas where leaks are most likely to occur; particularly those sensitive to construction tolerances, applicator inconsistencies, movement and varying geometries. Maintaining continuity throughout these connections ensures the longevity of structural components as well as improving indoor air quality, energy efficiency, and maintenance requirements.

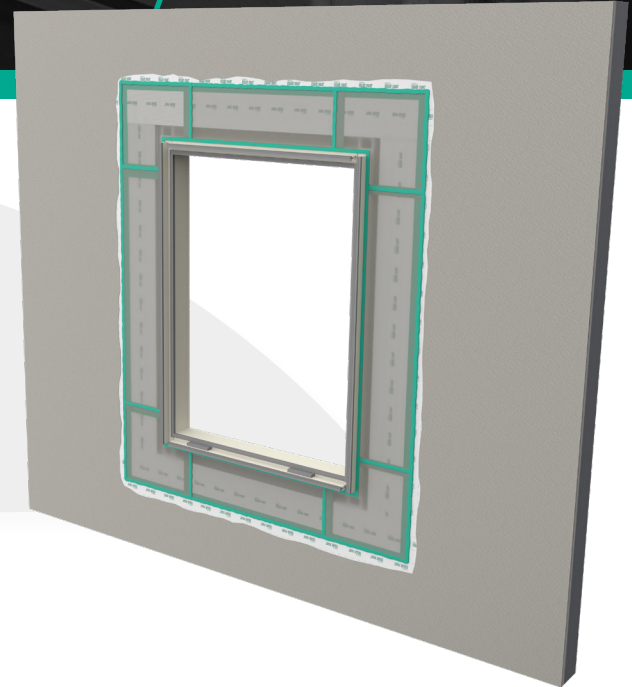

## Features & Benefits

- Ideal for bridging continuously between window or wall systems and the adjacent air and vapor barrier materials
- Spans and seals across irregular window geometries
- Absorbs both thermal movement and wind-loading stresses
- Ribbed surface ensures a complete seal with minimum sealant thickness
- Translucent silicone material allows for visual confirmation that proper amount of sealant is applied to the correct location
- Ease of installation reduces labor time and cost
- Fully compatible with most window sealant and glazing materials
- Several different configurations available for optimal flexibility in various applications
- 20-year warranty when used as directed



# Tested Connections, Proven Performance

Proglaze ETA has demonstrated performance success via protection against air infiltration, water-resistance and structural performance under seismic and dynamic wind load conditions, in some of today's most demanding projects and environments.



<ul style="list-style-type: none"> <li>• Use at Children's Hospital of Wisconsin in Milwaukee was predicted to provide energy savings of up to 20%</li> </ul>	
<ul style="list-style-type: none"> <li>• Successfully spanned the irregular and unsupported floor deflection joints at Rush University Medical Center in Chicago</li> </ul>	<ul style="list-style-type: none"> <li>• Bonds to the face of ExoAir® 100 and ExoAir 110AT. Bonds to the cured surface of ExoAir 130, ExoAir 230 and Securock® ExoAir® 430</li> </ul>
<ul style="list-style-type: none"> <li>• Exceeded performance demands for air barrier to curtain wall connections at Wisconsin Institute for Discovery at the University of Wisconsin-Madison in the biomedical research facilities where a controlled, airtight environment was necessary</li> </ul>	<ul style="list-style-type: none"> <li>• Variety of fully tested systems and sizes available with a dedicated design engineering and support team available for new or unique situations</li> </ul>

## Recommended Applications

**Proglaze ETA System 1** is a standard design, with dart, for flush windows. This system assembly is mechanically attached to the window and/or curtain wall's structural framing to ensure a durable connection and seal.

**Proglaze ETA System 2** features an off-set lock-in dart. The off-set dart design shields the window frame preventing air and water infiltration. This system is mechanically attached to the window and/or curtain wall's structural framing to ensure a durable connection and seal.

**Proglaze ETA System 3** features a small lock-in dart which is attached to a pressure bar mullion to ensure a durable connection and positive seal. The opposite edge of the extrusion will span onto the air and vapor barrier.

**Proglaze ETA System 4** utilizes single and double ribbed silicone extrusions of varying widths without darts and single ribbed silicone extrusions with double darts to maximize adaptability for complex geometries.

**Proglaze ETA 3D Molded Corner** connections are designed to facilitate transitions when construction sequencing has the surrounding façade being installed prior to the wall or window system. They allow complex connections to the wall or window system, which may be recessed or set proud from the plane of the weather barrier surface.

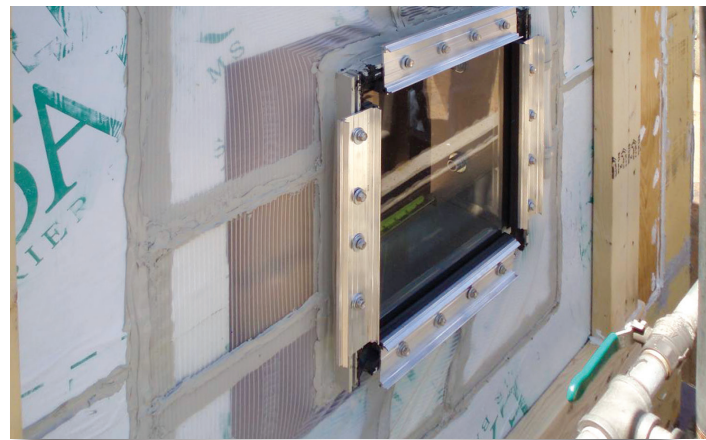

Tremco Commercial Sealants & Waterproofing | 3735 Green Road | Beachwood, OH 44122 | US: 800.852.9068 | CAN: 800.363.3213 | tremcosealants.com

Tremco Construction Products Group (CPG) brings together Tremco CPG Inc. and its Dryvit and Nudura brands; Willseal; Prebuck LLC; Tremco Barrier Solutions, Inc.; Weatherproofing Technologies, Inc. and its Pure Air Control Services and Canam Building Envelope Specialists offerings; and Weatherproofing Technologies Canada, Inc.



Construction Products Group

Use of the ® symbol indicates registration with the US Patent & Trademark Office and the Canadian Intellectual Property Office.  
© Tremco CPG Inc. 2024

0724/PGETASS

tremcocpg.com