



TILT-UP AND PRECAST CONCRETE SOLUTIONS

Comprehensive Solutions for the Production and Restoration of Precast and Tilt-Up Concrete, Backed by Single-Source Warranty Options



EUCLID CHEMICAL



COMPREHENSIVE SOLUTIONS FOR TILT-UP AND PRECAST CONCRETE

Whether for new prefabricated concrete construction or the restoration of existing concrete structures or applications, Euclid Chemical and Tremco Construction Products Group (CPG) offer a complete set of products and systems designed for the long-term performance of tilt-up and precast concrete projects.

Euclid Chemical provides high-performance concrete admixtures, fiber reinforcement, curing compounds & sealers, with concrete protection, repair and decorative solutions. Tremco CPG produces durable expansion joints, a full line of sealant solutions, and a variety of architectural wall coatings and finishes.

When used together in a new construction or restoration system, the strength of our combined product portfolio means we can meet the unique demands of any project, regardless of type, location, extent of damage present, schedule, facility service life, durability required, budget considerations, and more.



OUR COMBINED SYSTEMS INCLUDE:

- Vertical and Overhead Repair Mortars
- Horizontal Repair Mortars
- Fast-setting Repair Mortars for Quick Turnaround
- Cathodic Protection
- Penetrating Sealers
- Epoxies for Bonding and Anchoring
- Sealants, Joint Fillers and Crack Repair
- Pre-Compressed, Self-Expanding, Traffic-Grade Foam Expansion Joints
- Waterproofing Membranes
- High-Performance Traffic Coatings
- Architectural Wall Coatings



PRODUCTS DESIGNED FOR FAST INSTALLS AND LASTING PERFORMANCE

Many of our products are engineered to expedite installations and get your project completed as quickly as possible:

- Euclid Chemical rapid turnaround concrete repair products like VersaSpeed™ 100, EucoRepair™ V100 and EucoRepair™ SCC Fast are user-friendly and fast-setting in horizontal, vertical or overhead applications
- Willseal pre-compressed, self-expanding foam expansion joints can be installed quickly - or even in low temperatures
- Tremco high-performance sealants like Dymonic® 100 and the Spectrem® and Vulkem® product families are versatile enough to be used on any tilt-up or precast application for durable, water-tight seals for the long haul

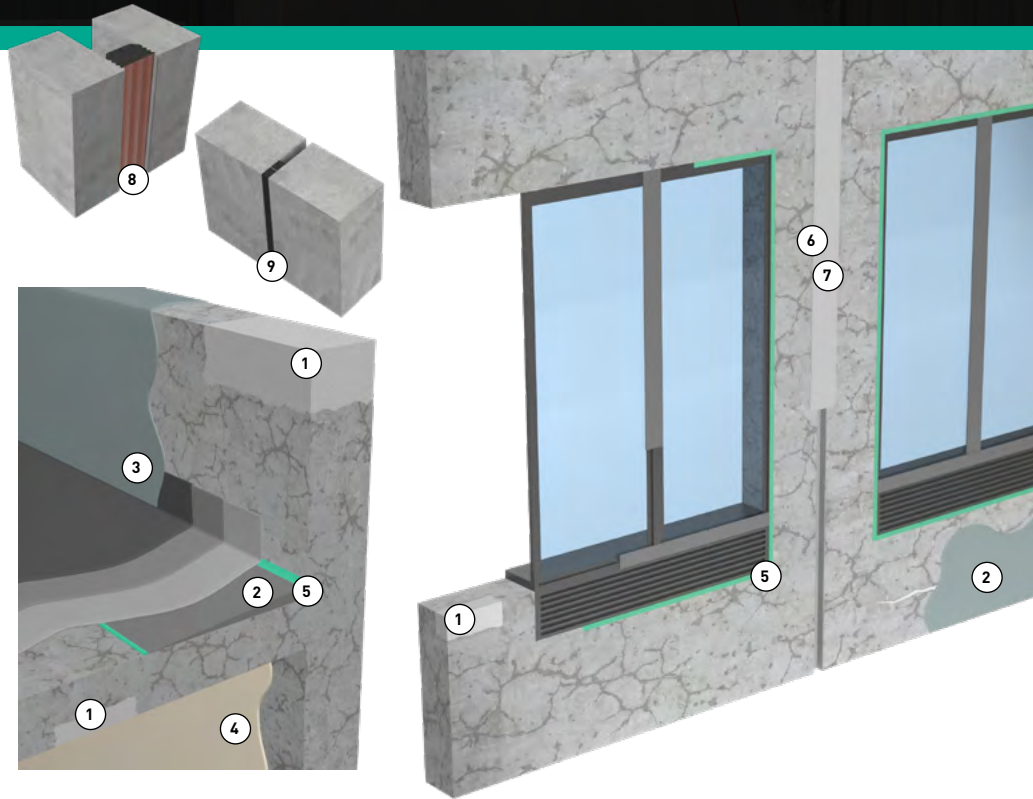

#	PRODUCT	DESCRIPTION
EUCLID CHEMICAL	1 EUCOREPAIR V100	Micro-fiber reinforced, fast setting, very low shrinkage mortar for trowel applied vertical and overhead concrete repair
	2 VERSASPEED™ LS 100	Longer setting repair mortar that provides a speedy cure with extended working time
	3 TAMMSCRETE™	Single-component, polymer-modified, cement based material used for achieving a smooth finish on precast, cast-in-place, tilt-up or other unfinished concrete surfaces with imperfections
	4 TAMMSCOAT	High-build, water-based acrylic coating to protect and enhance masonry and concrete surfaces with long-lasting durability and aesthetic appeal
	EUCOWELD 2.0	Liquid latex bonding agent for cement-based repair mortars and concrete that produces epoxy-like strength
	TAMMSPATCH II	Two-component polymer reinforced cementitious mortar for repairs 1/8" to 1"
	EUCOREPAIR SCC FAST/SCC	Microfiber reinforced self-consolidating concrete repair that allows for form and pour/pump repairs
	AQUASTAIN T-96	Penetrating, water-based polymer stain that enhances and protect precast and cast-in-place concrete with a uniform, long-lasting color finish
	BARCADE SILANE 100 C	Pure silane penetrating sealer that shields precast and cast-in-place concrete from water intrusion, deicing chemicals, and harsh conditions
	DURAL 100 & DURAL 106	Epoxy adhesives designed specifically for use in precast segmental construction. Choose shorter open contact time (Dural 100) or longer (106)
TREMCO CPG	DRYVIT WALL COATINGS	Architectural wall coatings designed to meet any performance, application, aesthetic or budget requirement
	5 DYMONIC® 100	High-performance, medium-modulus, low-VOC, UV stable, non-sag polyurethane sealant for expansion & control joints, caulking and more
	DYMONIC® FC	Fast-curing, durable, flexible hybrid sealant with excellent performance in precast concrete panel joints. Silane end-capped polymer technology
	6 SPECTREM® 1	High-performance, moisture-cure silicone joint sealant with exceptional physical properties. An adhesive for Spectrem Restoration Overlay
	7 SPECTREM® RESTORATION OVERLAY	Patented silicone dense rubber extrusions solution for restoring leaking skylights, sloped glazing, pressure bar and zipper/lockstrip systems
	VULKEM® 116	An excellent general-purpose sealant designed for use on poured and pre-cast concrete, masonry and similar construction joints
	DYMERIC® 240FC	Two-component polyurethane sealant for use on new or restoration precast & tilt-up concrete & masonry projects
	8 WILLSEAL® COLOR CORESEAL-V	Compressible, closed cell foam joint sealant with durable traffic-grade sealant coating. Capable of +/-25% movement from the mean gap size
	WILLSEAL® FR-V	Pre-compressed, open cell foam joint sealant capable of FR ratings for 1-, 2-, or 3-hour, with traffic-grade sealant coating. Capable of +/-50% movement from the mean gap size
	9 WILLSEAL® PF100/PF200	Pre-compressed, self-expanding foam joint seals, designed specifically for use in prefabricated applications including precast, tilt-up, panelization, EIFS and more

SYSTEMS BACKED WITH LEADING WARRANTIES AND TECHNICAL SUPPORT



INDUSTRY-LEADING WARRANTY OPTIONS

Because products from Euclid Chemical and the Tremco CPG companies undergo rigorous testing for compatibility and superior long-term performance, you get the peace of mind that comes from unparalleled warranty options.

Standard material warranties are offered for time-tested Euclid Chemical and Tremco products. Extended, **industry-leading labor & material warranty options** are available when an applicator combines the proven performance of both product lines.

And the strength of our relationship means the warranty is truly single source: one document, one point of contact, one less thing to worry about.



HANDS-ON FIELD TECH SUPPORT

On-site conditions always vary, presenting unforeseen challenges on the project. Euclid Chemical and Tremco CPG's 200+ years of combined experience means our local technical field representatives have the expertise to determine the ideal solution for your project.

We routinely collaborate with key project stakeholders to diagnose and recommend solutions for even the most complex projects.

Lean on our expertise for pre-construction meetings, mockups and details, technical documents, compatibility testing, surface preparation, on-site product training, sequence of installation guidance and more.

Euclid Chemical and Tremco Construction Products Group are part of RPM International, Inc.

Tremco Construction Products Group brings together Tremco Incorporated's Commercial Sealants & Waterproofing and Roofing and Building Maintenance operating divisions; Dryvit Systems, Inc.; Nudura Inc.; Willseal; Weatherproofing Technologies Inc. and Weatherproofing Technologies Canada, Inc.



EUCLID CHEMICAL

The Euclid Chemical Company
19215 Redwood Road | Cleveland, OH 44110
216.531.9222 | 800.321.7628
www.euclidchemical.com



Tremco CPG, Inc.
3735 Green Road | Beachwood, OH 44122
216.292.5000 | 800.321.7906
www.tremcocpg.com

© 2025 Tremco CPG Inc. All rights reserved. All registered trademark symbols relate to a claim of registration in the United States.

© 2025 The Euclid Chemical Company. This material is provided for informational purposes only. The Euclid Chemical Company expressly disclaims any liability relating to the use of this material. Nothing stated herein shall give rise to or constitute any warranty by The Euclid Chemical Company, express or implied, including but not limited to any implied warranty of merchantability or fitness for a particular purpose. The information provided in this material is not intended to be all inclusive, as the manner in which any product is used or handled may involve other or additional considerations that are not addressed herein.

L-0082 | 04/25

