

NOTE: REFER TO TREMCO'S PUBLISHED APPLICATION INSTRUCTIONS FOR ACCEPTABLE JOINT SIDE WALL SUBSTRATE CONDITIONS PRIOR TO INSTALLATION

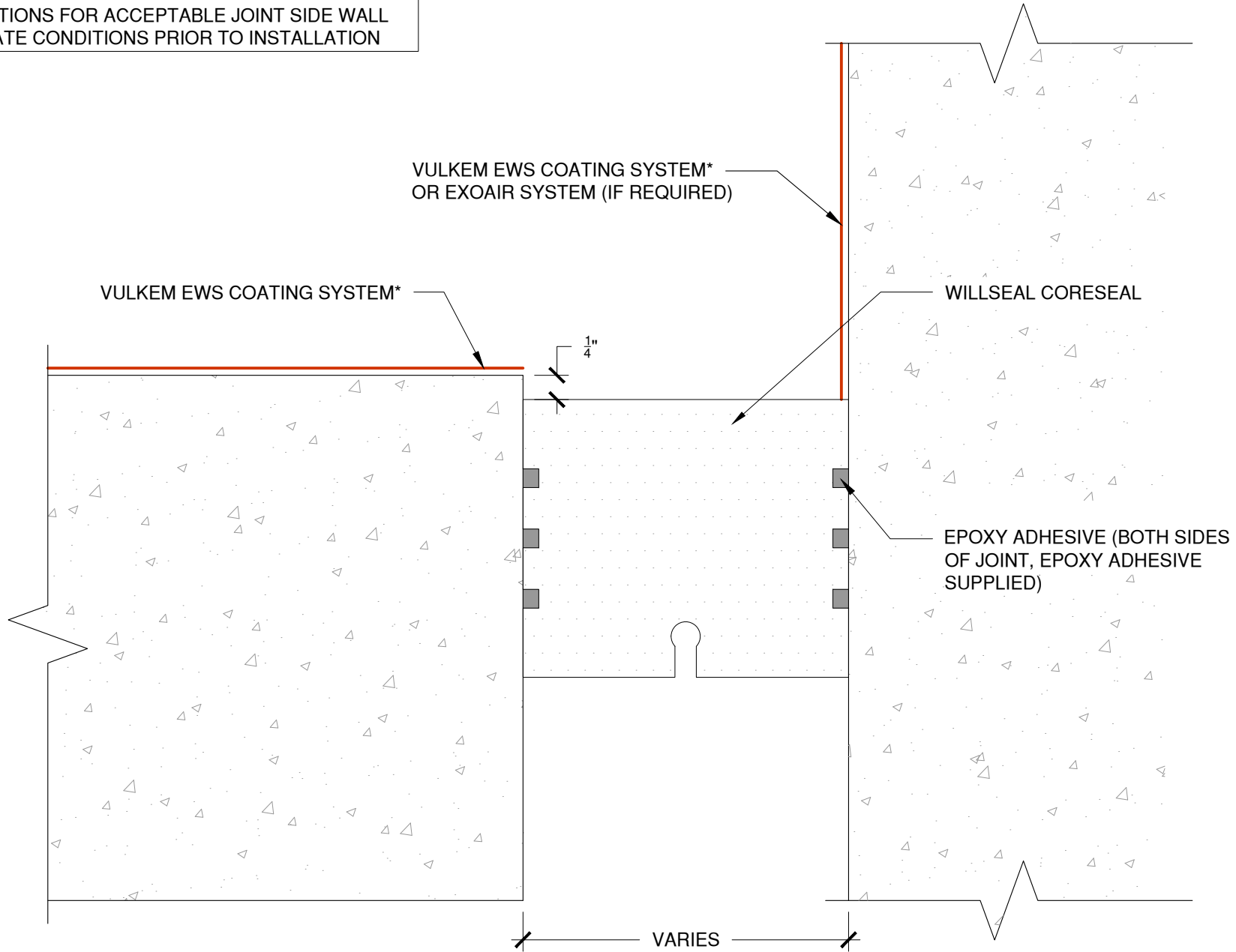

\*A component of the Vulkem®EWS Traffic Coating System with PUMA (polyurethane methacrylate)



Project:  
 Detail: Willseal Coreseal at Floor to Wall Expansion Joint with Vulkem EWS System

This detail is intended for conceptual purposes only.

Drawn by: KAB

Checked by: NF/SP

Scale: NTS

Date: 7/6/2020

File Name:

WC-FW-EWS-01