

## TYPICAL VAPOR BARRIER UNDER SLAB

# VaporLock-m™

METHANE BARRIER

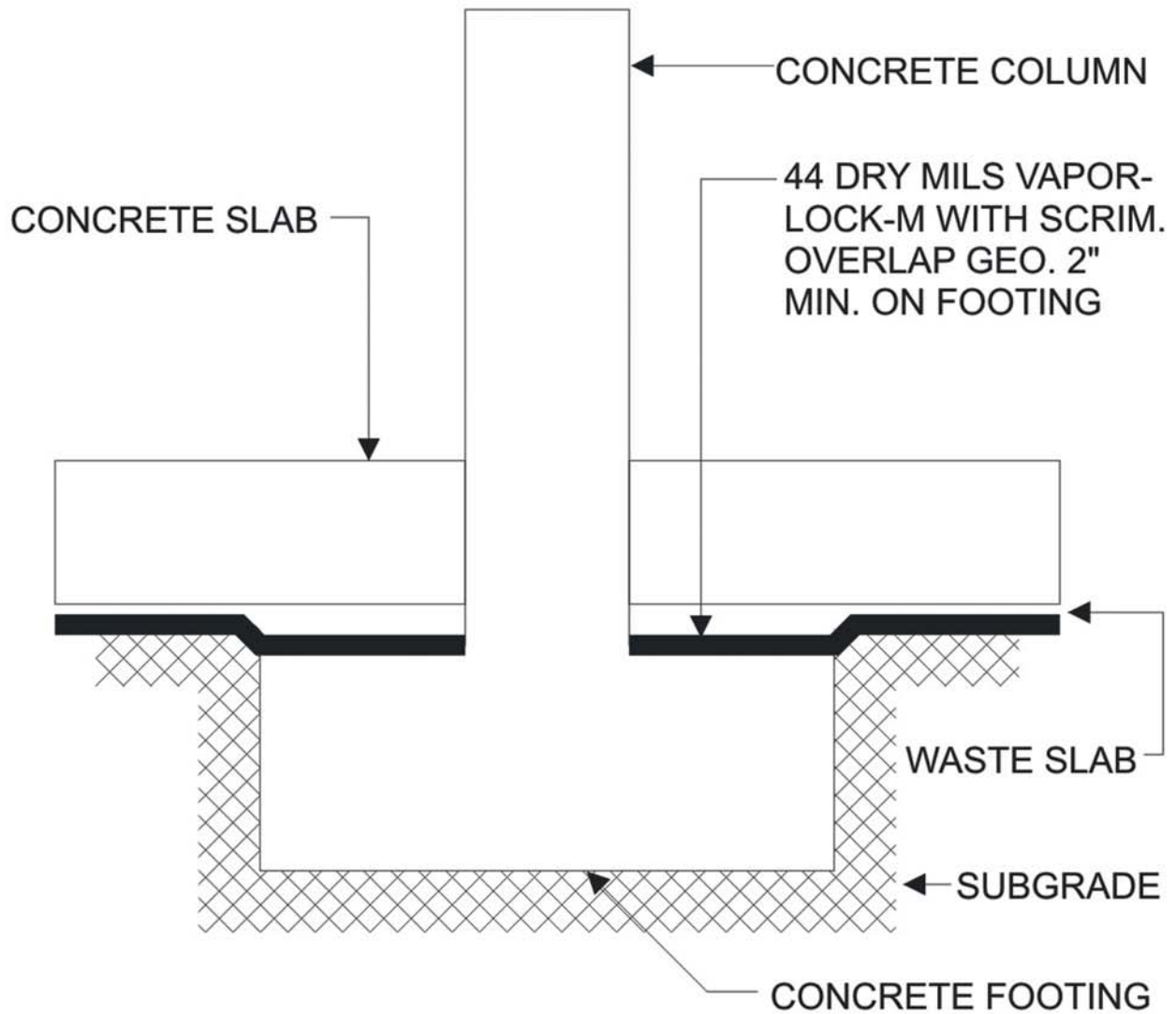

## GAS BARRIER @ INTERIOR COLUMN FOOTINGS

# VaporLock-m™

METHANE BARRIER

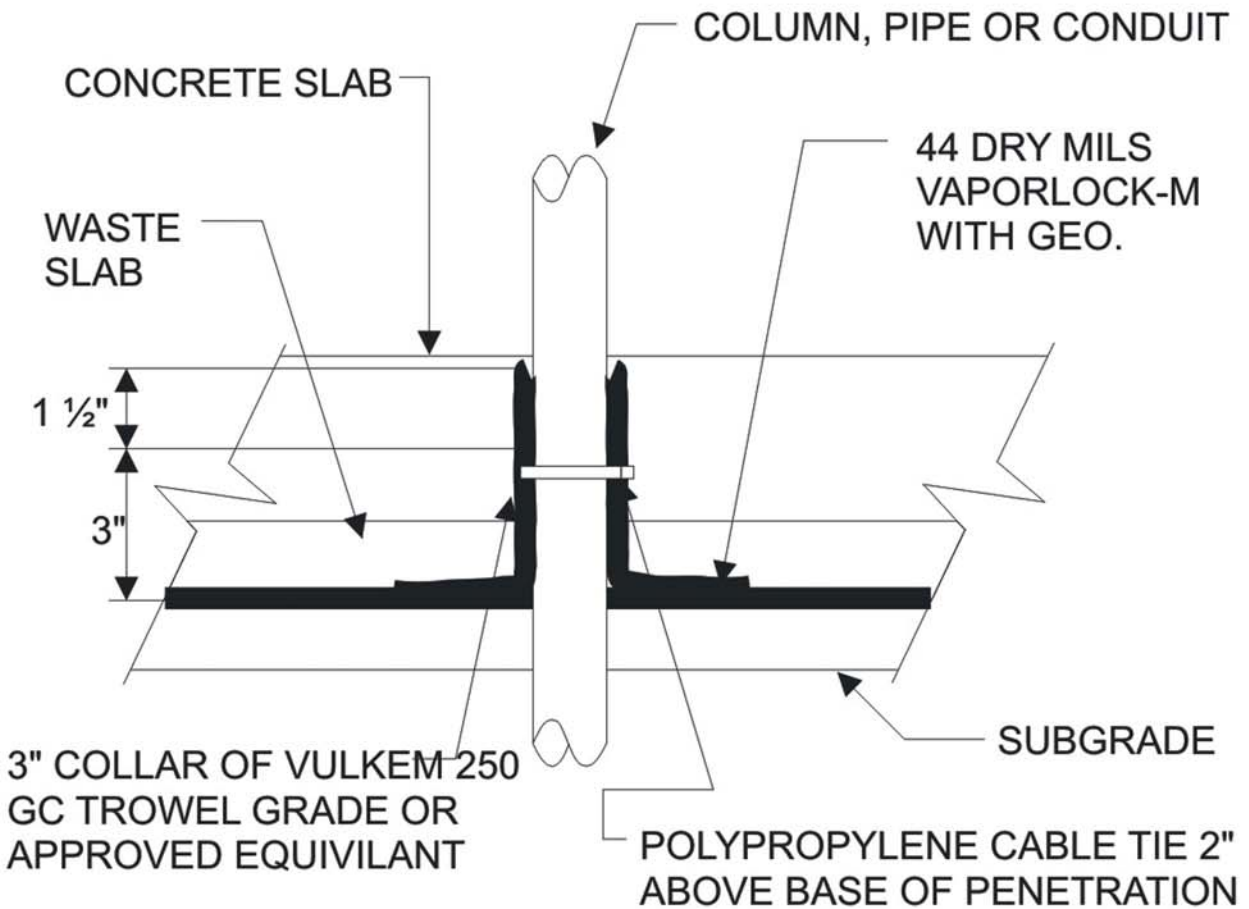

NOTE: AS ALTERNATIVE, WRAP COLUMN, PIPE OR CONDUIT WITH NEOPRENE STRAP (1/8" THICK, 1/2" WIDER THAN CLAMP) AND FASTEN WITH SS CLAMP

## GAS VAPOR BARRIER PENETRATION DETAIL

# VaporLock-m™

METHANE BARRIER

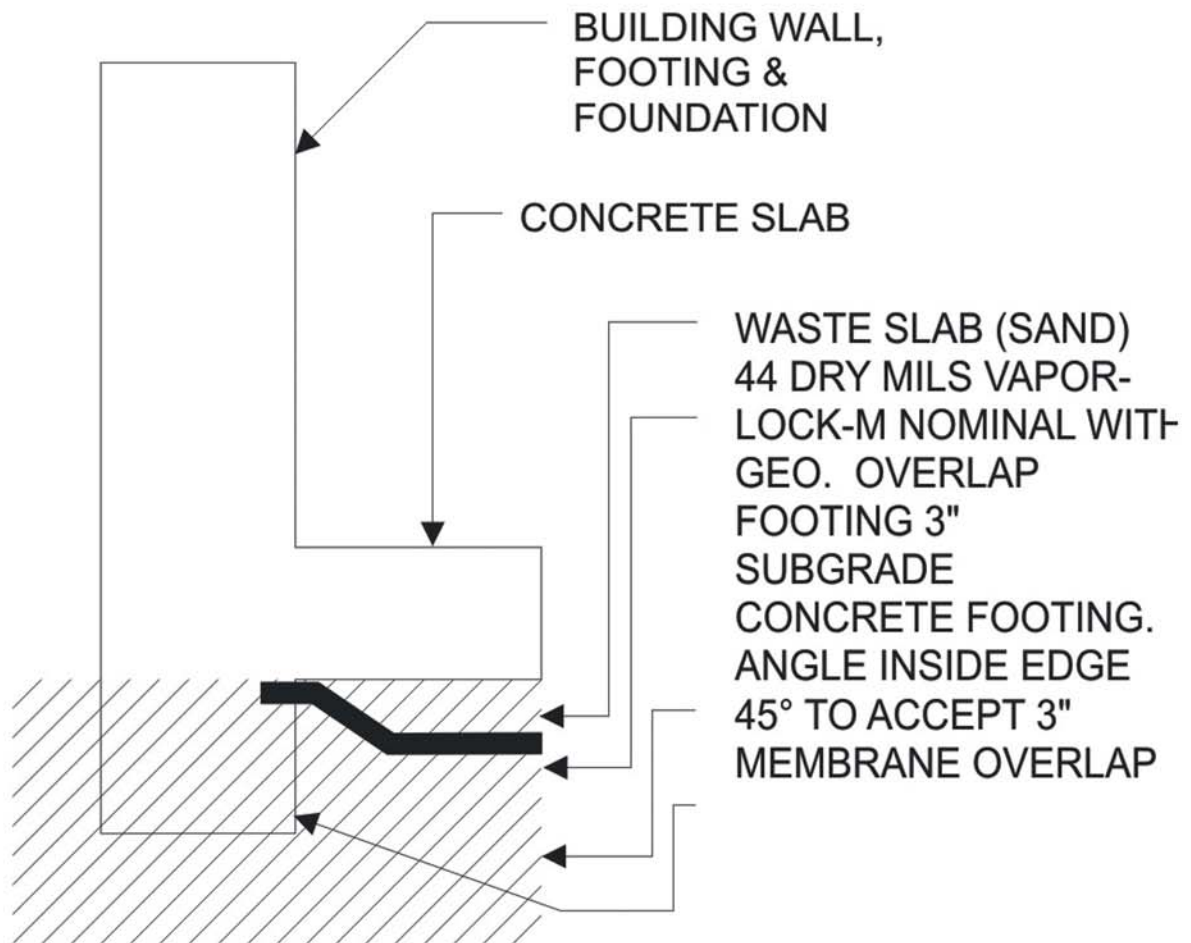

## GAS VAPOR BARRIER @ FOOTINGS