

TREMDrain 6000

- 1) TREMDrain 6000
- 2) Tytar 3401 G or approved carrier sheet
- 3) TREMproof 260 at 60 dry mils of >

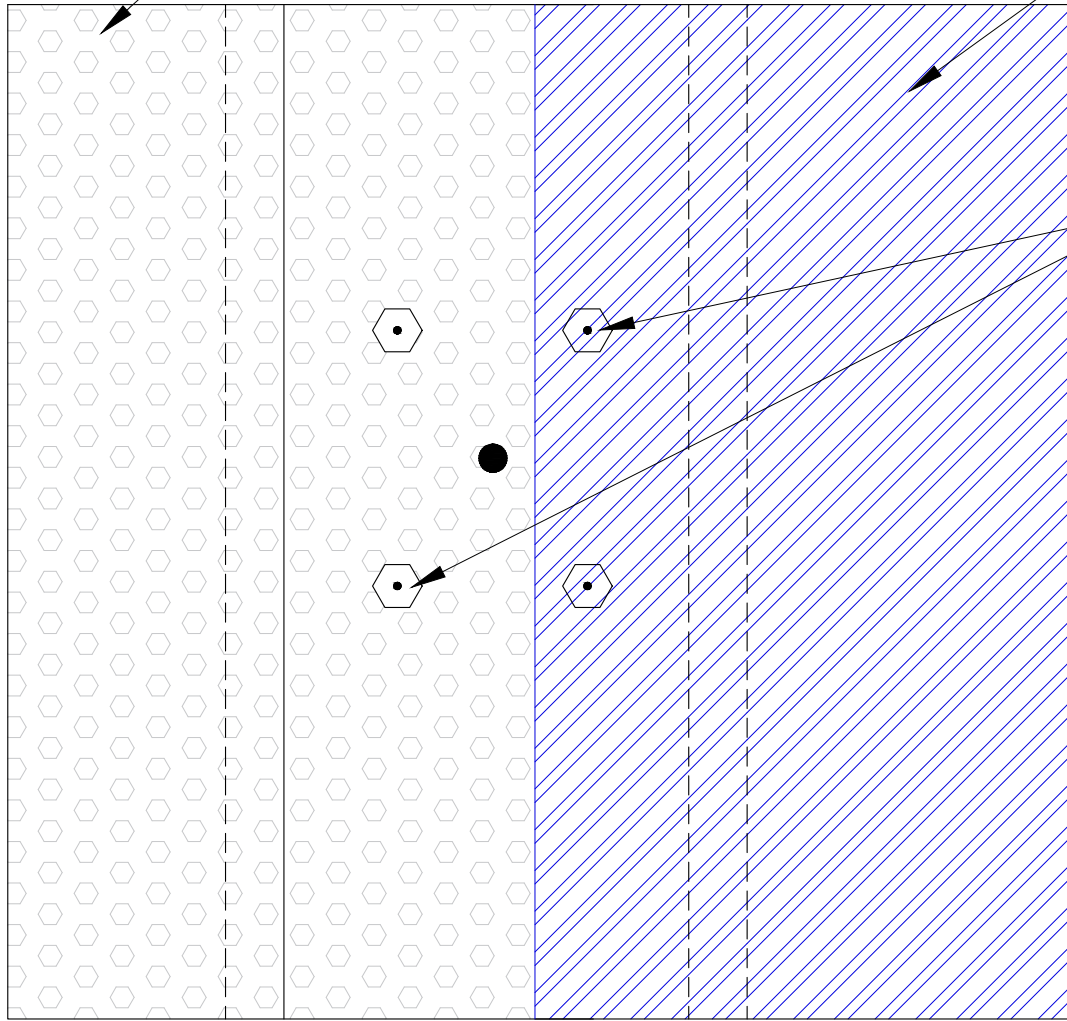

2-3" min. hexagonal or square pin/washer to prevent deflection

TREMDrain 6000 not to flex more than 1" around dowel detail/openings. 2-3" min. pins/washers to be installed around dowel openings to prevent drainage board deflection. The number of pins/washers and spacing to be determined by site conditions.

All dowel pins/washers to be sealed/covered with TREMproof 260 at 90 dry mils. Reference penetration details for proper detailing.

Note: Not intended for submerged or hydrostatic head conditions

TREMCO
 www.tremcosealants.com
 3735 Green Road * Beachwood, OH 44122
 Phone : 866-209-2404 * Fax: 216-766-5535

Project:
 Detail: TREMproof 260 at Mechanically Pinning of TREMDrain 6000 around Dowel Penetrations

This detail is intended for conceptual purposes only.

Drawn by: **KAB** Checked by: **WH** Scale: **None**

Sheet Number:
 Date: **11/5/2019**

File Name:
F-BSW-G-03