

NOTE: VULKEM 950 NF MAY BE USED AS TOPCOAT IN AREAS WITH NO U.V.

TREMCO PUMA TC*

TREMCO PUMA WC*, SEEDED TO REFUSAL WITH AGGREGATE

TREMCO PUMA BC*

TREMCO PUMA PRIMER*

- 1) CLEAN/WIPE EXISTING VULKEM SYSTEM WITH VULKEM PUMA CLEANER
- 2) TREMCO PUMA PRIMER
- 3) LAP 2" WITH TREMCO PUMA TC

VULKEM 346 OR 951NF TOP COAT

VULKEM 346, 950NF 951NF OR VULKEM EPOXY WC INTERMEDIATE COAT W/AGGREGATE

VULKEM 350NF OR 360NF BASE COAT

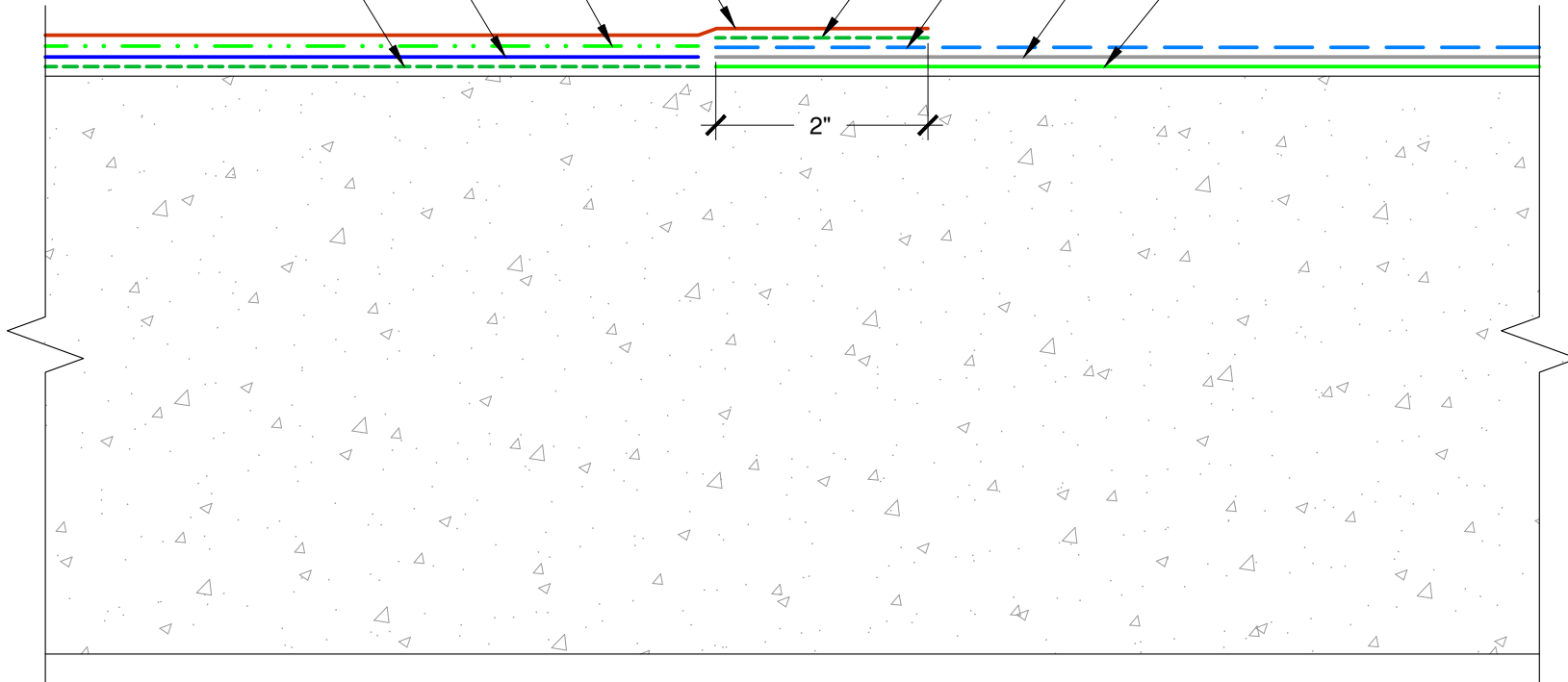

The architecture, engineering, and design of the project using the Tremco products are the responsibility of the project's design professional. All products and systems must comply with local building codes and standards. This detail is for general information and guidance only and Tremco specifically disclaims any liability for the use of this detail. The project design professional determines, in its sole discretion, whether this detail or a functionally equivalent detail is best suited for the project. This detail is subject to change without notice. Contact Tremco to ensure you have the most recent version.

*A COMPONENT OF THE VULKEM® EWS TRAFFIC COATING SYSTEM WITH PUMA (POLYURETHANE METHACRYLATE)

Vulkem Vehicular Coating



Tremco Technical Support: 866-209-2404

Detail: Vulkem EWS System to Vulkem Vehicular System

Drawn by: KAB

Checked by: EL

Scale: NTS

Date: 1/18/2023

File Name:

DC-V-T-03



Construction Products Group

www.tremcocpg.com