

PRIME WITH TREMPRIME  
NON-POROUS PRIMER

DYMONIC 100

VULKEM 350NF OR 360NF  
DETAIL COAT

VULKEM 346 OR 951NF  
TOP COAT

VULKEM 346, 950NF, 951NF OR VULKEM EPOXY WC  
INTERMEDIATE COAT W/AGGREGATE

VULKEM 350, 350NF OR 360NF  
BASE COAT

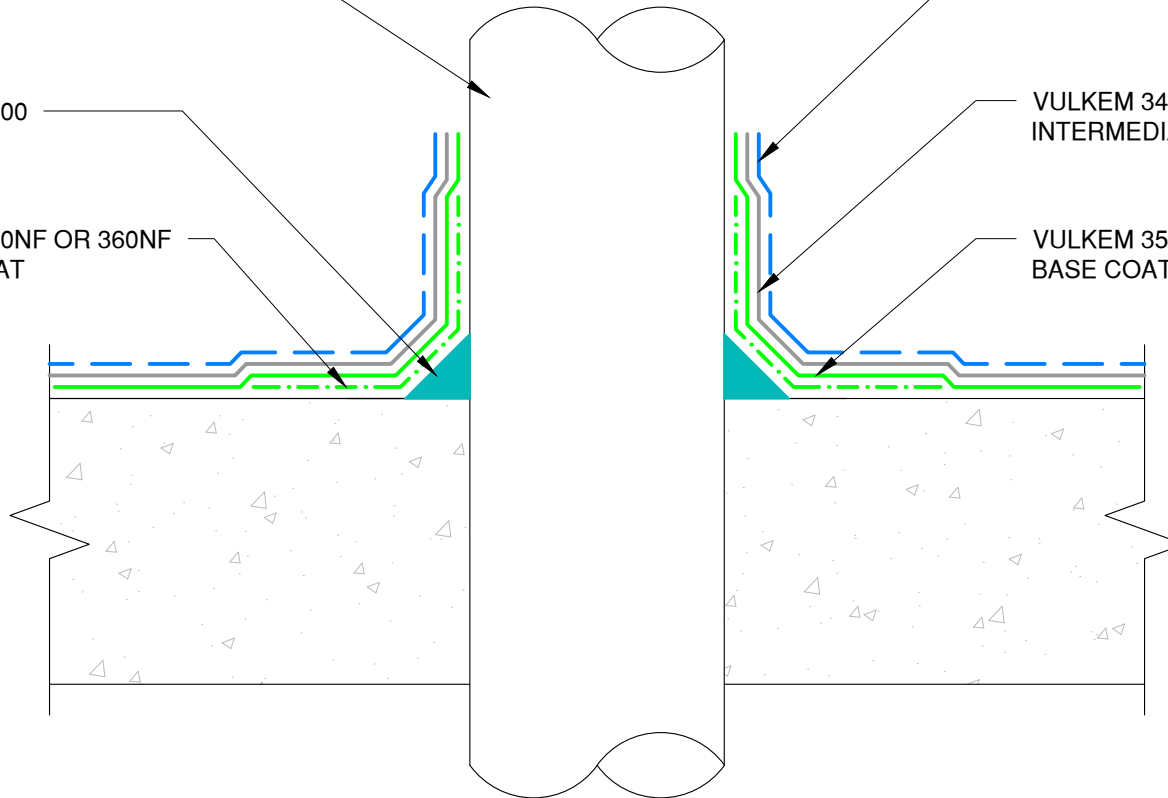

NOTE: VULKEM 950NF MAY BE USED AS A  
TOPCOAT IN AREAS WITH NO U.V.



3735 Green Road, Beachwood, OH 44122  
Phone : 866-209-2404

Detail: Vulkem Vehicular System at Penetration

Sheet Number:

File Name:

DC-V-P-01

This detail is intended for conceptual purposes only.

Drawn by: KAB

Checked by: WH

Scale: None

Date: 4/21/2020