

PRIME WITH TREMPRIME  
NON-POROUS PRIMER

DYMONIC 100

VULKEM 351, 351NF OR 951NF  
TOP COAT W/AGGREGATE

VULKEM 350, 350NF, 350FC OR 360NF  
BASE COAT

VULKEM 350, 350NF, 350FC OR 360NF  
DETAIL COAT

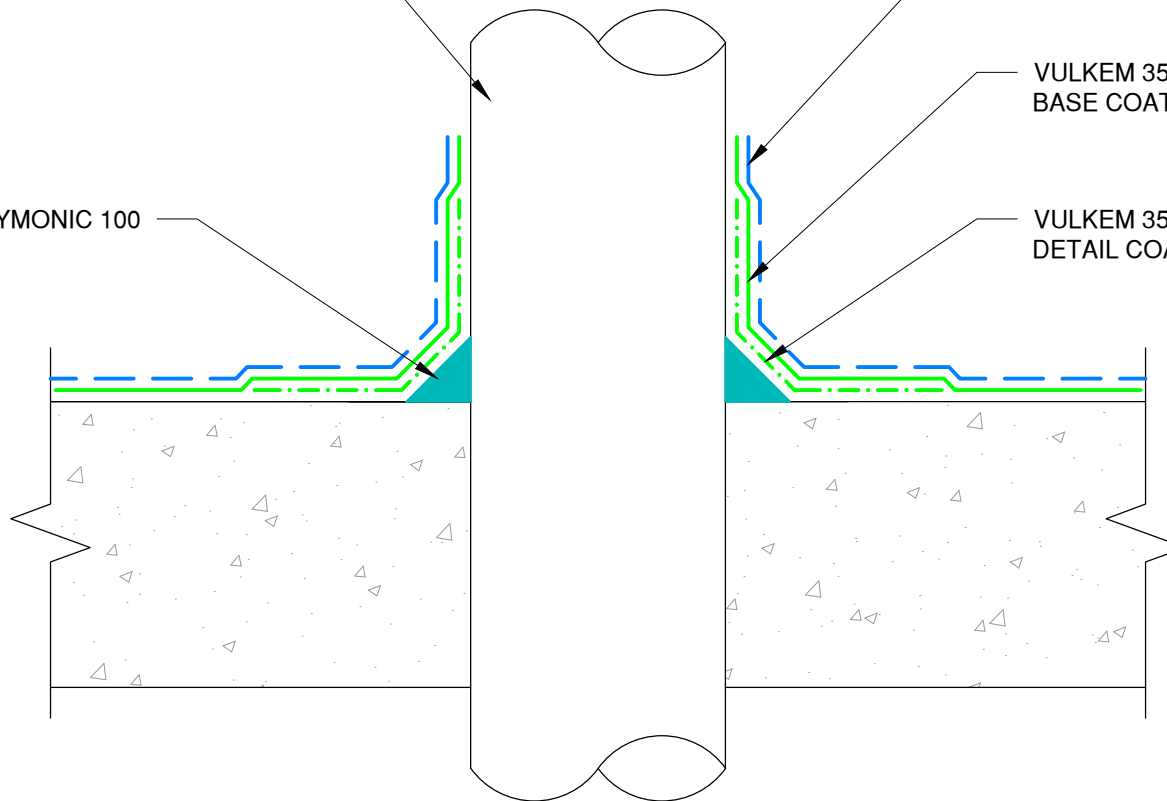

NOTE: VULKEM 950NF MAY BE USED AS A  
TOPCOAT IN AREAS WITH NO U.V.

*The architecture, engineering, and design of the project using the Tremco products are the responsibility of the project's design professional. All products and systems must comply with local building codes and standards. This detail is for general information and guidance only and Tremco specifically disclaims any liability for the use of this detail. The project design professional determines, in its sole discretion, whether this detail or a functionally equivalent detail is best suited for the project. This detail is subject to change without notice. Contact Tremco to ensure you have the most recent version.*

### Vulkem Pedestrian Coating



www.tremcosealants.com  
Tremco Technical Support: 866-209-2404

Detail: Treatment of Metal Penetration in Pedestrian System

Drawn by: KAB

Checked by: WH

Scale: NTS

Date: 10/20/2021

File Name:

DC-P-P-02



Construction Products Group

Tremco Construction Products Group companies: Dryvit Systems, Inc.; Nudura Inc.; Prebuck LLC; Schul International Co., LLC d/b/a/ Willseal; Tremco Incorporated