

Metal post

Dymonic 100 or approved
Tremco sealant and backer rod

Detail coat of TREMproof 250GC
at 30 mils with embedded
reinforcing fabric as specified

Tile

Steel rail post base
sleeve/receiver

$\frac{3}{4}$ " Exterior Grade Plywood or Concrete Deck

Prime with TREMprime
Non-Porous Primer

Tremco Protection Course

TREMproof 250GC
over entire deck

1 $\frac{1}{2}$ " Minimum concrete
topping slab

Nylon Zip Tie or
S.S. Clamp

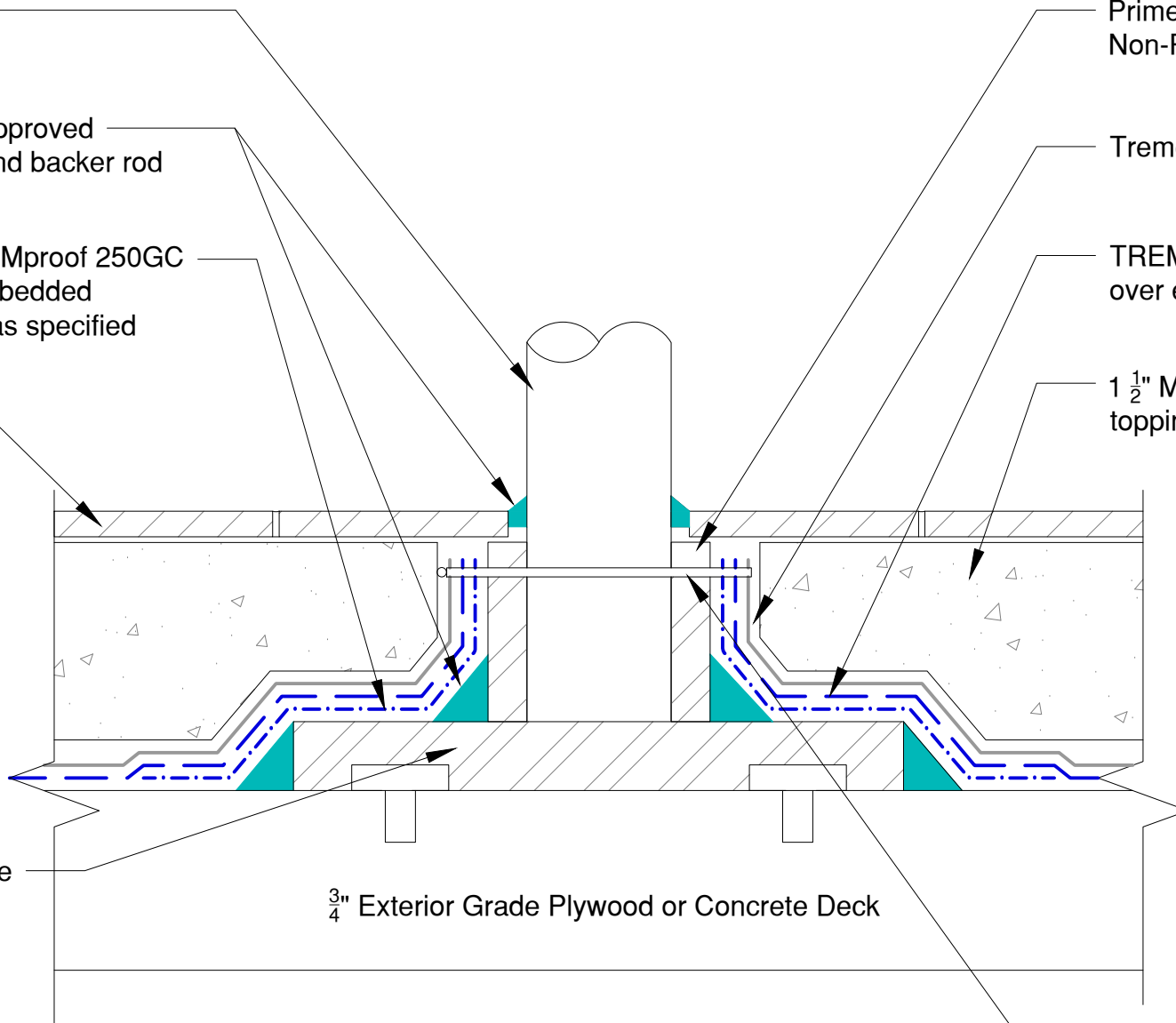

TREMCO

www.tremcosealants.com

3735 Green Road * Beachwood, OH 44122
Phone : 866-209-2404 * Fax: 216-766-5535

Detail: TREMproof 250GC at Rail Post

Sheet Number:

File Name:

C-250GC-P-03

This detail is intended for conceptual purposes only.

Drawn by: KAB

Checked by: WH

Scale: None

Date: 7/25/2018