

FULL SHEET OF PARASEAL WITH HDPE SIDE FACING INSTALLER

PERMANENT SEAM TAPE AT ALL VERTICAL SEAMS (INTERRUPTED IN DRAWING FOR CLARITY)

2" PARAGRANULAR CANT AT WALL FOOTING UNDER PARASEAL MEMBRANE

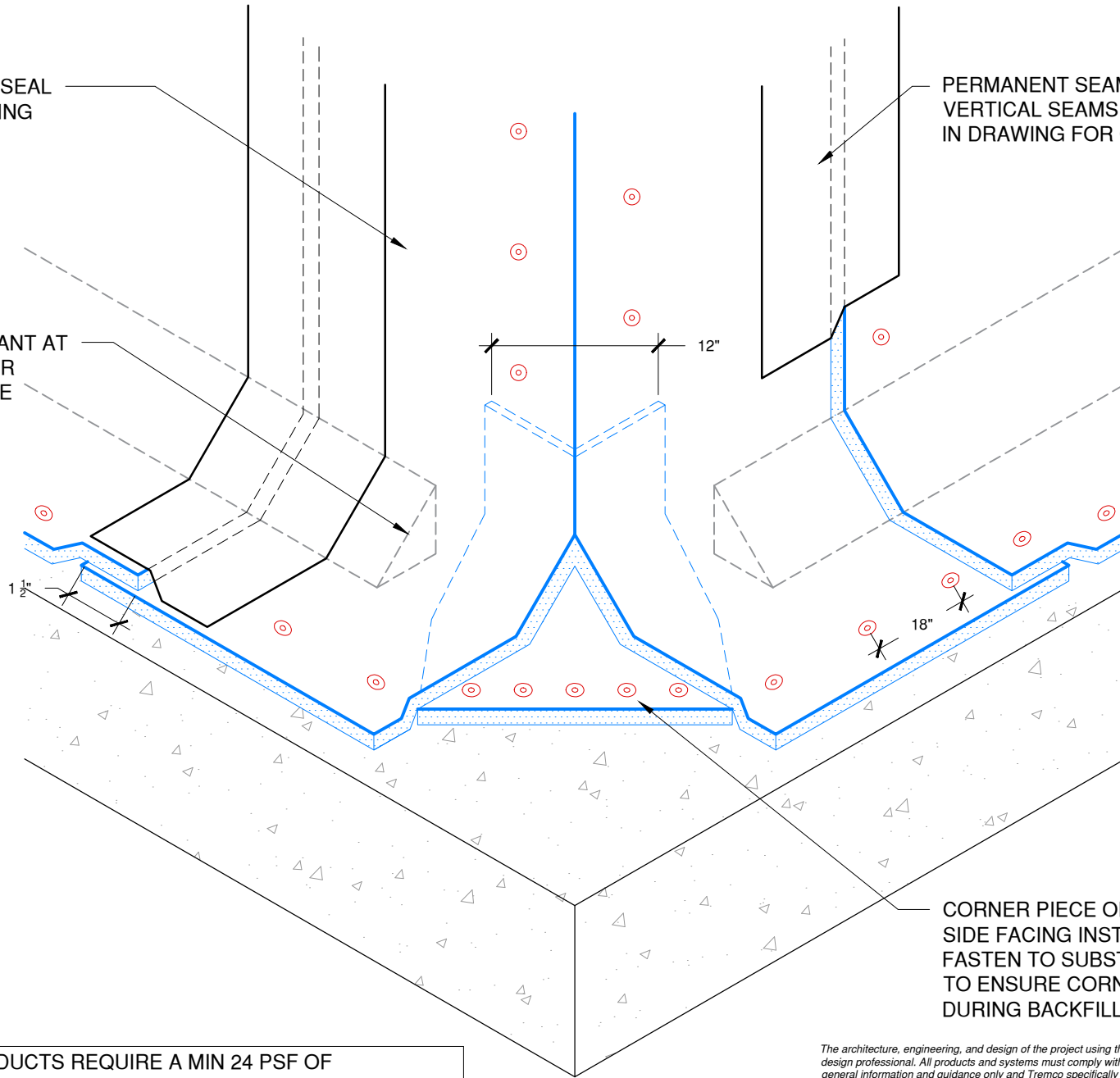

CORNER PIECE OF PARASEAL WITH HDPE SIDE FACING INSTALLER. MECHANICALLY FASTEN TO SUBSTRATE WITH NAILS EVERY 2" TO ENSURE CORNER PIECE DOESN'T MOVE DURING BACKFILL PROCESS

NOTE: PARASEAL PRODUCTS REQUIRE A MIN 24 PSF OF COMPACTION/CONFINEMENT IN ORDER TO FUNCTION AS DESIGNED

The architecture, engineering, and design of the project using the Tremco products are the responsibility of the project's design professional. All products and systems must comply with local building codes and standards. This detail is for general information and guidance only and Tremco specifically disclaims any liability for the use of this detail. The project design professional determines, in its sole discretion, whether this detail or a functionally equivalent detail is best suited for the project. This detail is subject to change without notice. Contact Tremco to ensure you have the most recent version.

**Paraseal Backfilled Walls**



Tremco Technical Support: 866-209-2404

Detail: Paraseal Installation at Outside Corners

Drawn by: KAB

Checked by: WH

Scale: NTS

Date: 2/23/2022

File Name:

BFW-P-C-01



Construction Products Group

www.tremcocpg.com