

Exposed Portion of Wall Should Have Above Grade Waterproofing To Prevent Water From Entering Through Wall Face or Construction Joints and Travelling Down Behind Paraseal.

Continuous Paraterrm Bar Nailed Every 8" O.C. Finish Grade Should Occur at or Below Paraseal Waterproofing.

Temporary Tape at all Vertical Seams Down to 18" Below Finish Grade.

Paraseal Sheet Lowered into Place With Bentonite Side Against Substrate. Cover Top 4" of Paraseal Starter Strip.

NOTE: This detail and installation technique to be used only when space will not allow workers in the backfill area. Normal block walls to be waterproofed the same as concrete c.i.p.

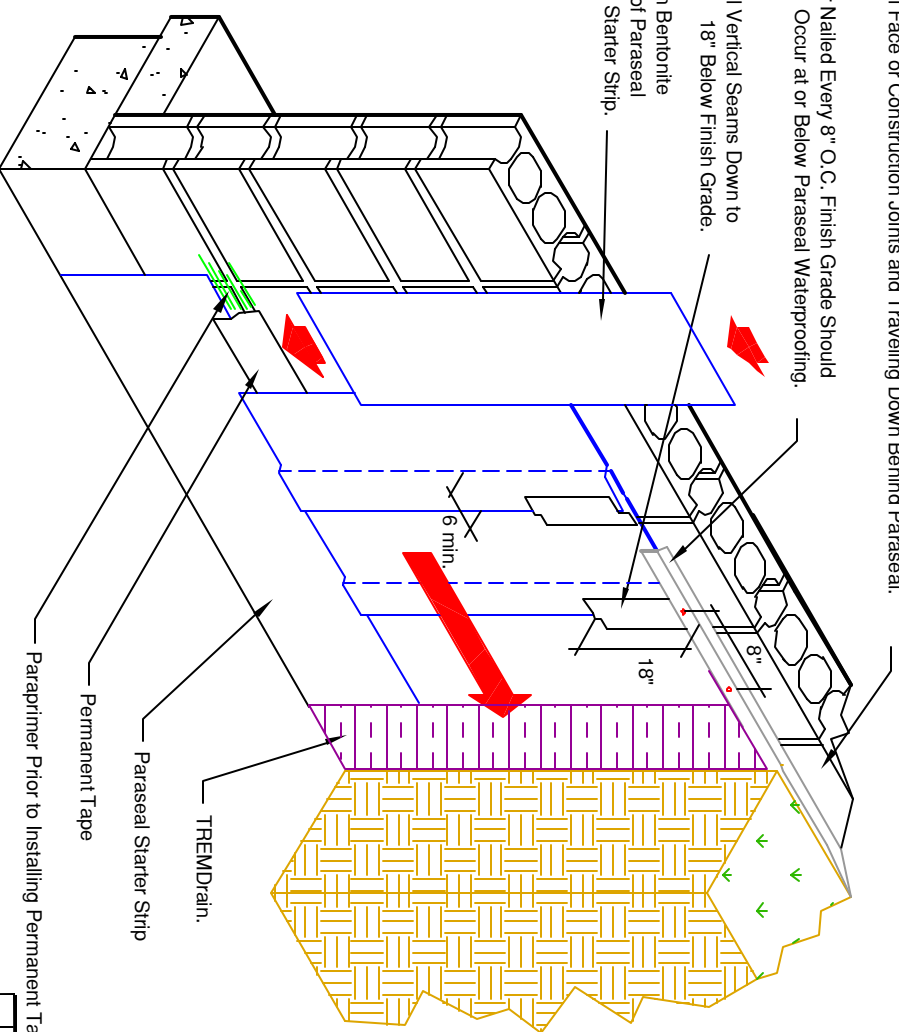

Note: Paraseal Products require a minimum 24 psf compaction/ confinement to be effective.

Paraseal Installation: Close Clearance at Masonry Wall

No.	Date	Description	By
<b>TREMCO.</b> 3736 Green Road Bannock, Ohio 44122 216-282-8000			
Project: <b>Backfilled Walls</b>			
Drawn by: W. Hensley		Scale: Not To Scale	
Date: 04/06/05		Drawing/Order No: BFW-03	