

Gasket & Corner Designs Refer to Concept Drawing 08078

HEAD CONDITION

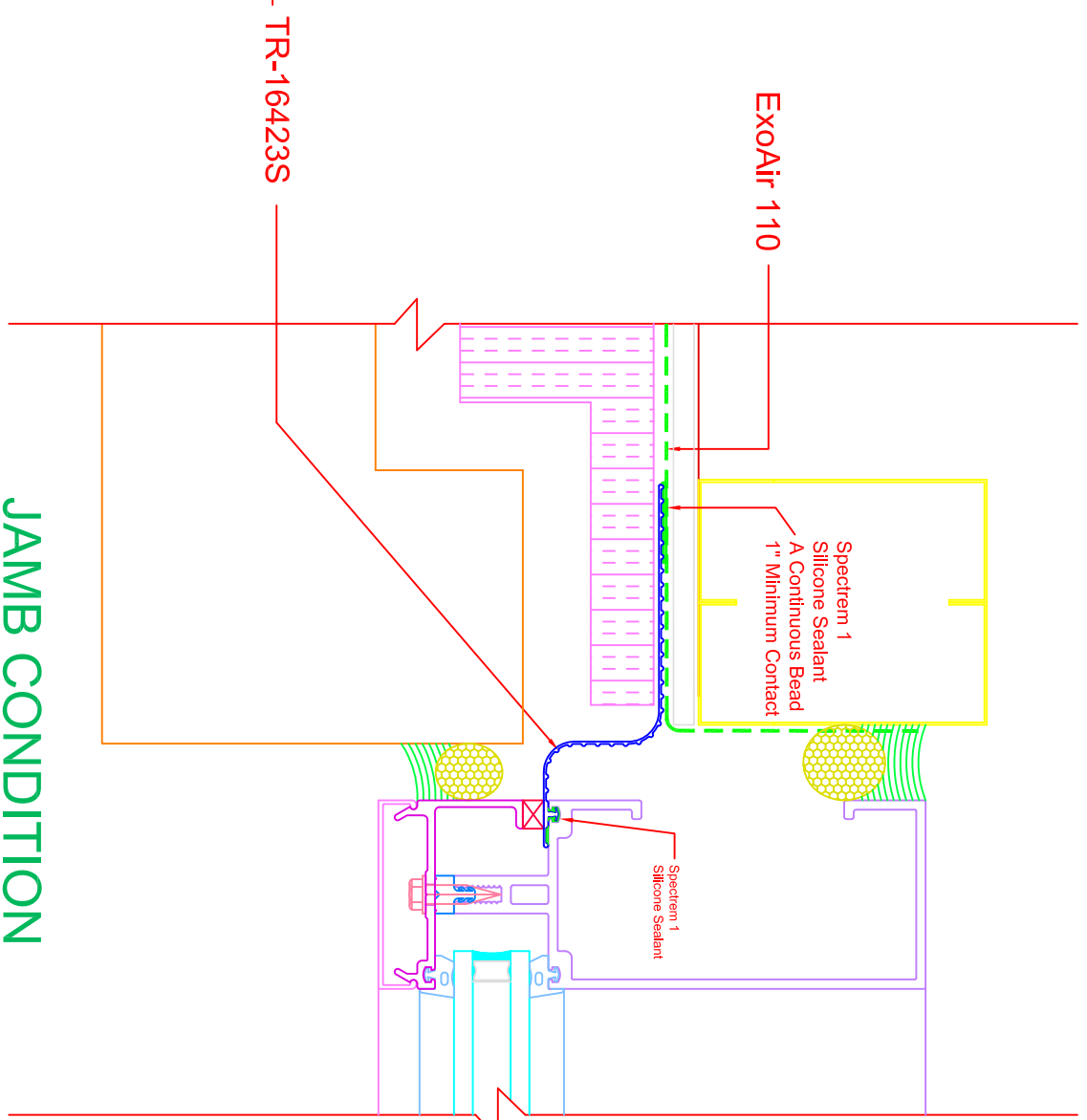
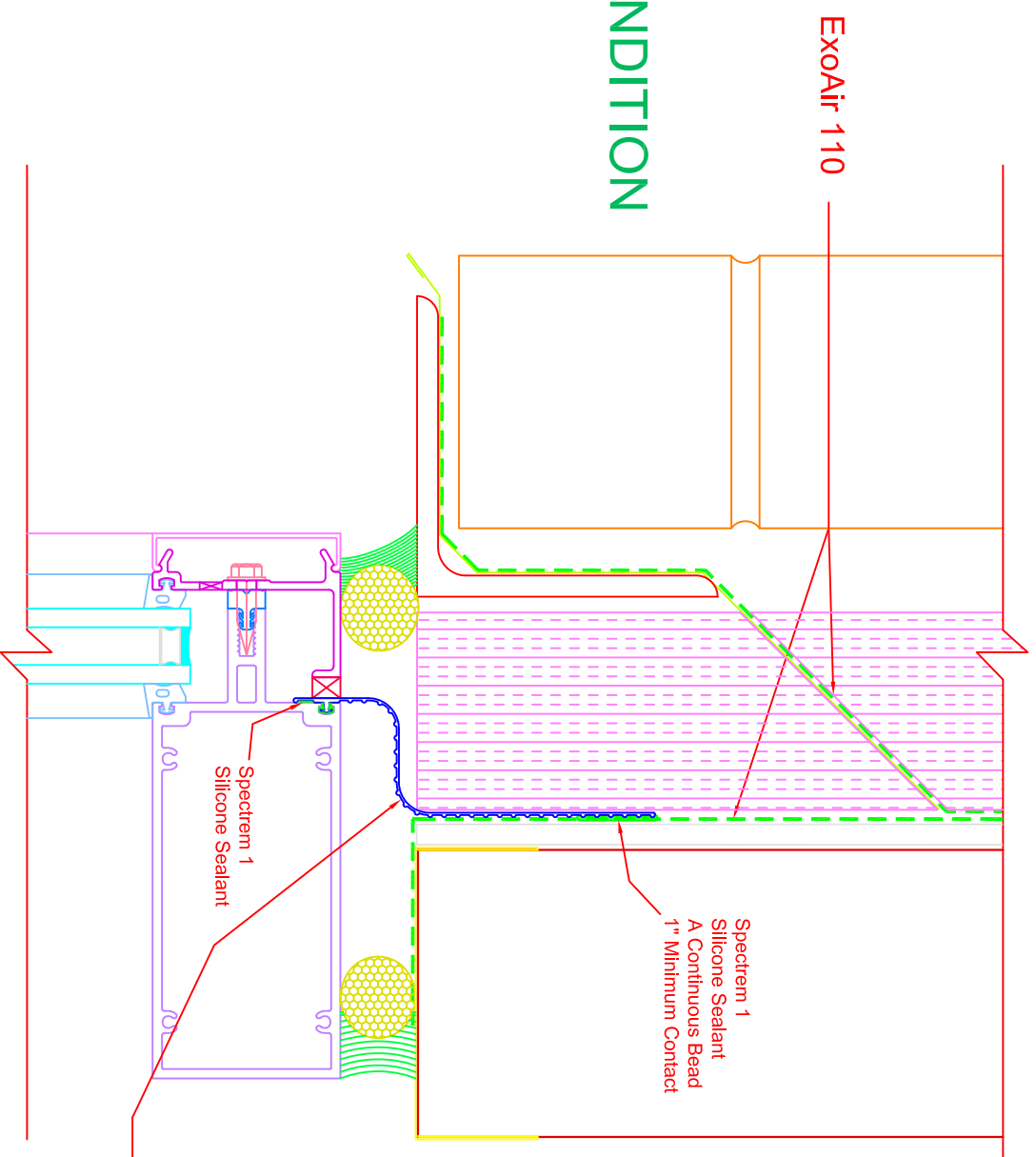

JAMB CONDITION

SILL CONDITION

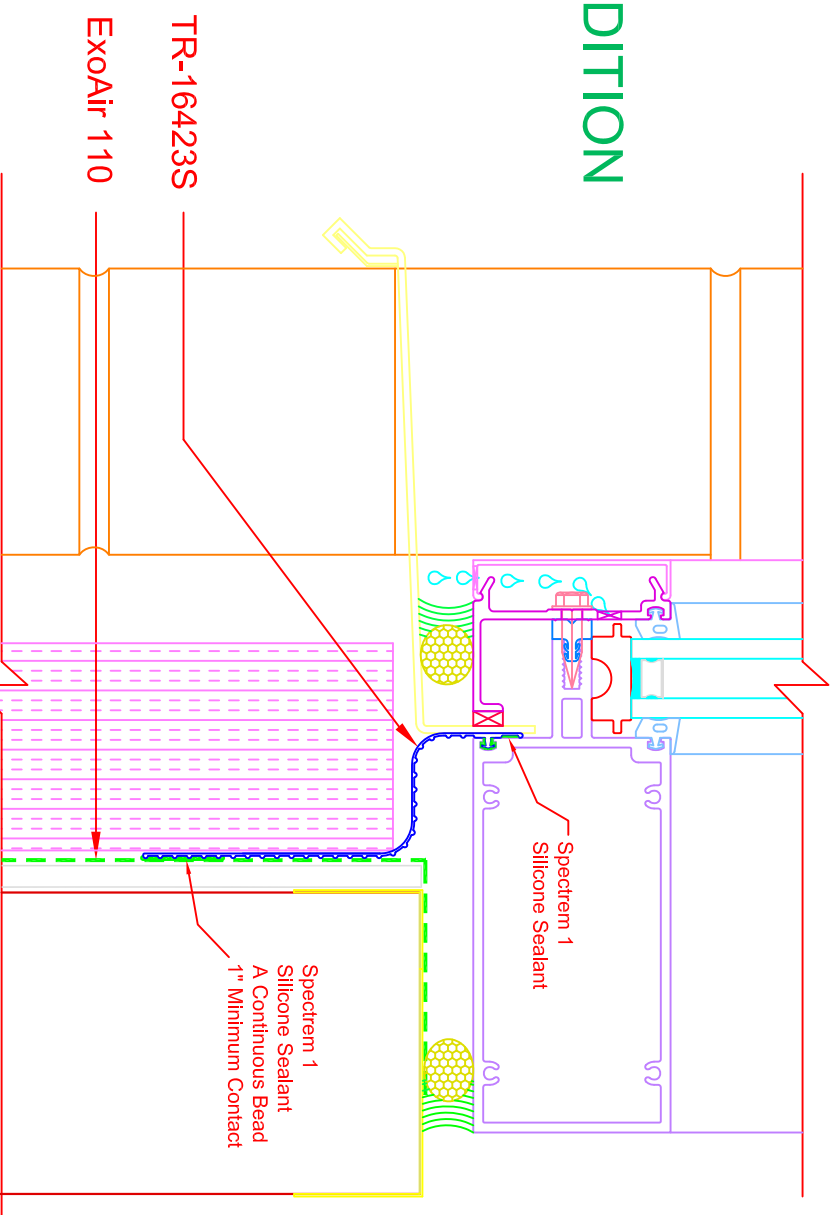

The above details and related information are provided solely as a courtesy to installers using the Proglaze ETA System and may be updated or modified by Tremco without notice. Consult Tremco to ensure that you are reviewing current information. Because building codes, climate considerations and other site conditions may vary from project to project, Tremco details are not intended to provide exhaustive coverage of all issues that may be encountered on a particular project and/or that may affect Proglaze installation procedures and/or performance. Building owners and installers should consult and follow the published recommendations of wall, window and door manufacturers, as applicable, with respect to proper attachment of the Proglaze ETA System.

The design of the gasket shown herein is the product of Tremco Incorporated. No reproduction or use of this design is authorized without the consent of Tremco Incorporated.

No.	Date	Description	By

TREMCO
 SEALANT / WEATHERPROOFING DIVISION
 1451 Jacobson Ave
 Ashland, Ohio 44805 U.S.A.
 Phone : 800-321-6357
 Fax : 419-289-6645

Customer: **TREMCO** Customer Part No. _____
 Project: **Proglaze ETA - System 3**

Drawn by: POIRIER	Scale: FULL	Date: 7/16/08
		Drawing No. 08079