

FACTORY APPLIED AND CURED SILICONE

WILLSEAL MODIFIED ACRYLIC
IMPREGNATED MICROCELL FOAM

TREMPROOF 201/60/250GC
VERIFY COMPATIBILITY IN FIELD

FIELD APPLIED SILICONE SEALANT
(BOTH SIDES OF JOINT)
SILICONE SEALANT SUPPLIED

FIELD APPLIED EPOXY
(BOTH SIDES OF JOINT)
EPOXY SUPPLIED

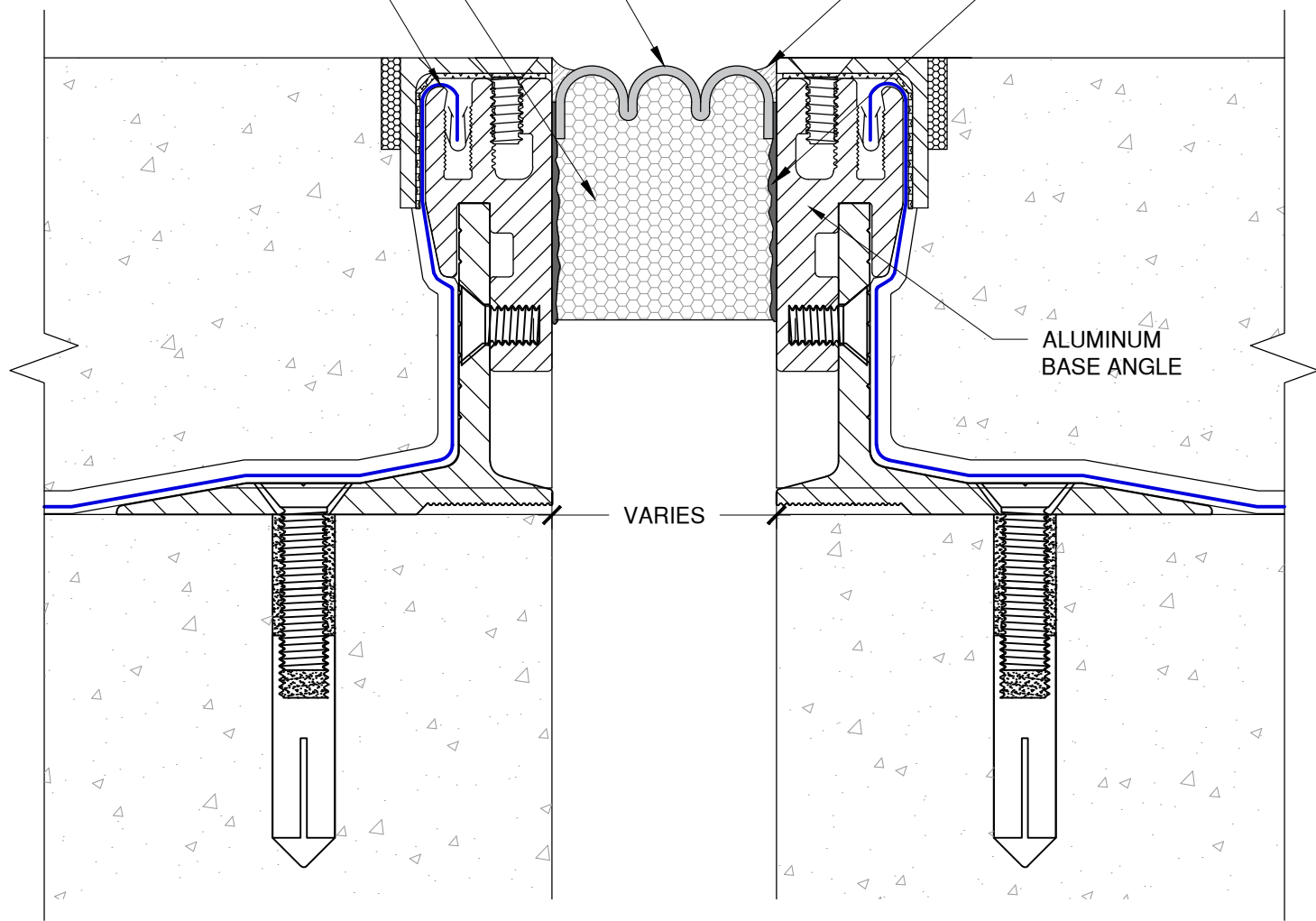

VARIES

ALUMINUM
BASE ANGLE

The architecture, engineering, and design of the project using the Willseal products are the responsibility of the project's design professional. All products and systems must comply with local building codes and standards. This detail is for general information and guidance only and Willseal specifically disclaims any liability for the use of this detail. The project design professional determines, in its sole discretion, whether this detail or a functionally equivalent detail is best suited for the project. This detail is subject to change without notice. Contact Willseal to ensure you have the most recent version.

Willseal 250



Detail: Willseal 250 with Tremco Waterproofing at Split Slab Application

Drawn by: HDE	Checked by: AM/WH	Scale: NTS	Date: 7/19/2022
---------------	-------------------	------------	-----------------

www.tremcocpg.com

File Name:
W250-FF-06

