

TREMproof 6100 at 215 mils

TREMDrain GS

Gravel (Ballast)

Insulation

Soil Retention Element

Approved Growing Medium

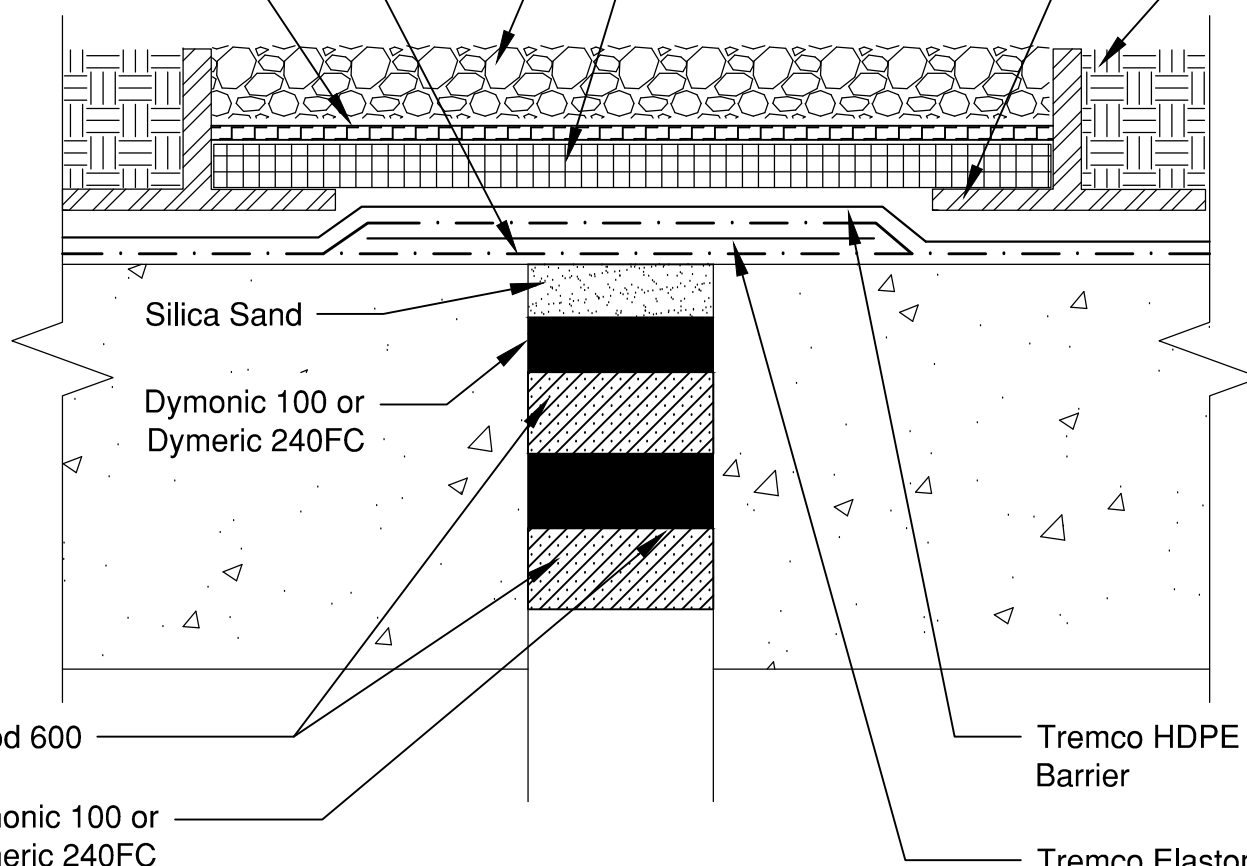

Silica Sand

Dymonic 100 or Dymeric 240FC

illmod 600

Dymonic 100 or Dymeric 240FC

Tremco HDPE Root Barrier

Tremco Elastomeric Sheeting or DualFlex embedded within the Tremco Membrane

Notes: Tremprime QD or another Tremco approved primer must be applied before the application of TREMproof 6100

When a back-up seal with illmod 600 is not required, a closed cell backer rod can be utilized. Please consult your local Tremco Sales or Technical Service Representative.

This detail is intended for conceptual purposes only.

Rev	Date	Description	By
-	-	-	-

Rev # 00

File Name: 12112

Sheet Number:

Date: 1/16/2013

Project: Hot Applied  
Detail: TREMproof 6100 Greenscape Expansion Joint

Scale: None

Checked by: EH

Drawn by: KAB

**TREMCO**  
www.tremcoatlantis.com

3735 Green Road • Beachwood, OH 44122  
Phone : 866-209-2404 • Fax: 216-766-5535