

NOTE: FOR CMU WALLS, APPLY PERMAQUIK 200 IN 3 PASSES MIN. 1.5KG/M²

PERMAQUIK 200 SLURRY IN TWO PASSES AT 1 KG/M²

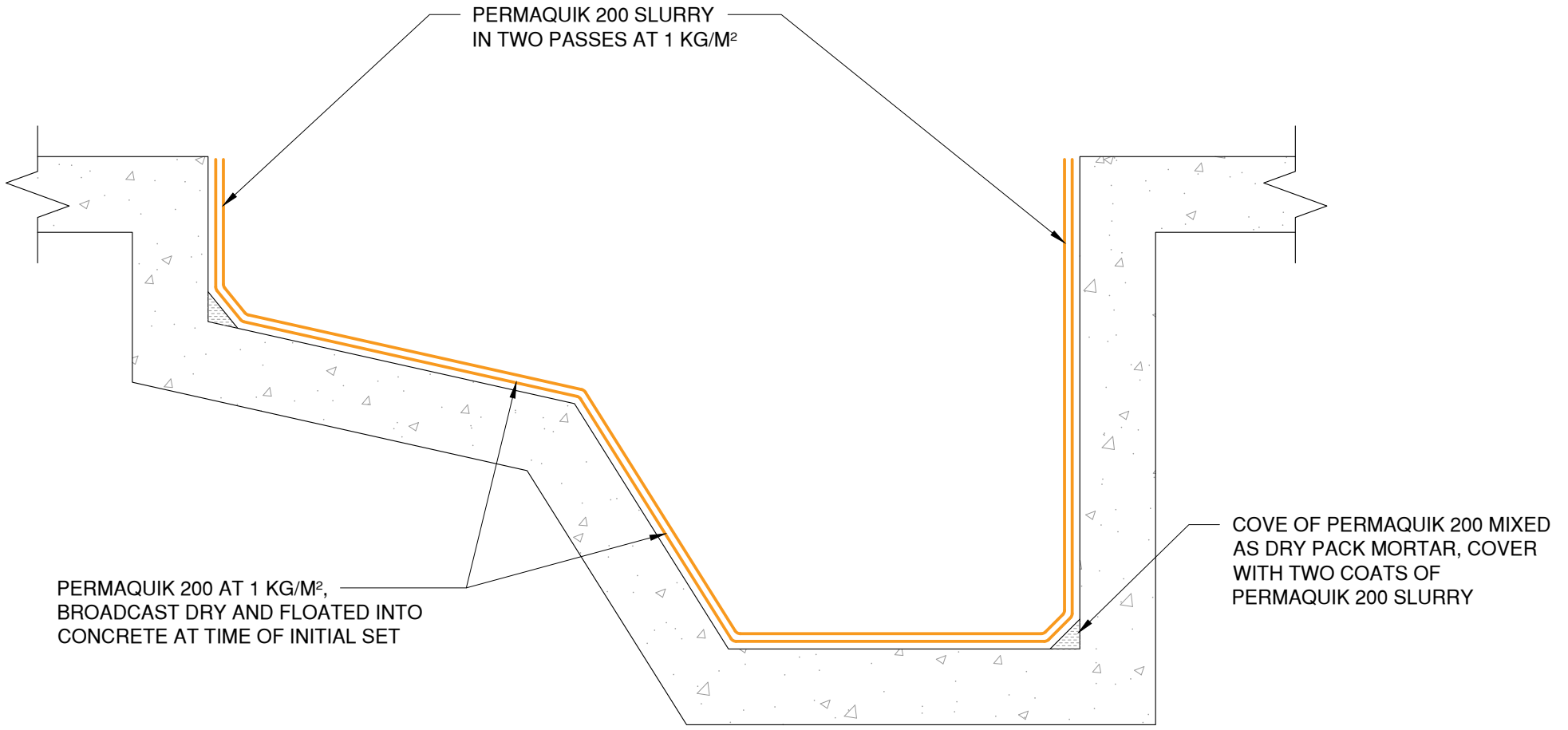

PERMAQUIK 200 AT 1 KG/M², BROADCAST DRY AND FLOATED INTO CONCRETE AT TIME OF INITIAL SET

COVE OF PERMAQUIK 200 MIXED AS DRY PACK MORTAR, COVER WITH TWO COATS OF PERMAQUIK 200 SLURRY

The architecture, engineering, and design of the project using the Tremco products are the responsibility of the project's design professional. All products and systems must comply with local building codes and standards. This detail is for general information and guidance only and Tremco specifically disclaims any liability for the use of this detail. The project design professional determines, in its sole discretion, whether this detail or a functionally equivalent detail is best suited for the project. This detail is subject to change without notice. Contact Tremco to ensure you have the most recent version.

Permaquik 200



Detail: Typical Swimming Pool Detail

File Name:

Drawn by: KAB

Checked by: GM

Scale: NTS

Date: 12/14/2022

PQ-03



Tremco Technical Support: 866-209-2404

www.tremcocpg.com