

Terminate both sides of sheeting with Paraterm Bar (optional), embedded in TREMproof 6100

TREMproof 6100 with embedded reinforcing fabric as specified

Tremco Protection Course

TREMDrain

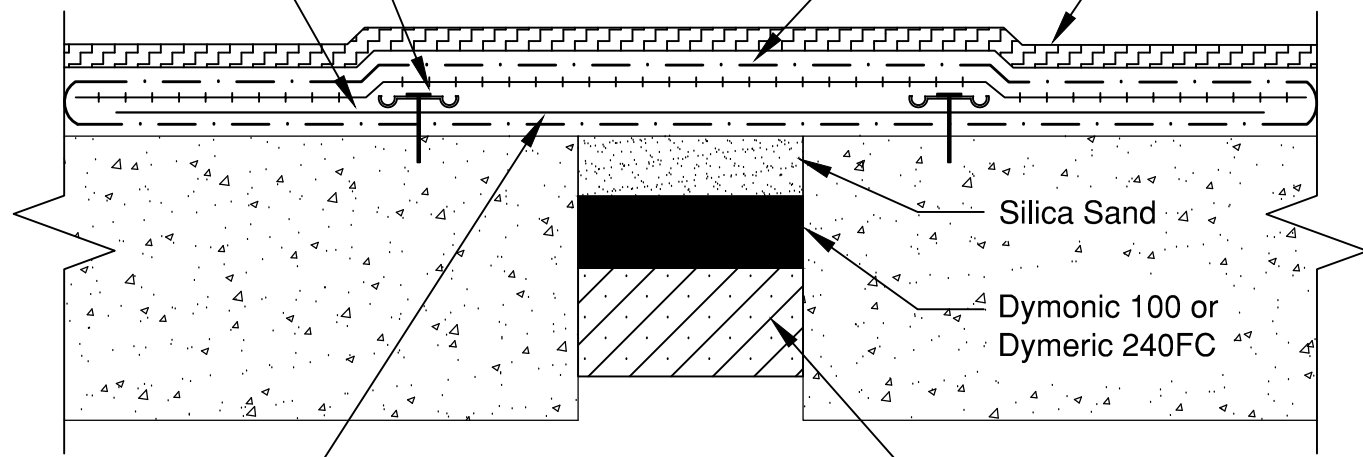

Elastomeric sheeting, extend minimum of 6" on either side of joint

Silica Sand

Dymonic 100 or Dymeric 240FC

illmod 600

Notes: Tremprime QD or another Tremco approved primer must be applied before the application of TREMproof 6100

When a back-up seal with illmod 600 is not required, a closed cell backer rod can be utilized. Please consult your local Tremco Sales or Technical Service Representative.

This detail is intended for conceptual purposes only.

Rev	Date	Description	By
-	-	-	-