

TREMCO PUMA TC*

TREMCO PUMA WC*
W/AGGREGATE FULLY LOADED
AND FILLER POWDER WITH
SIZE 8 BAUXITE TO REFUSAL

TREMCO PUMA BC* OR BC LM*

TREMCO PUMA PRIMER*

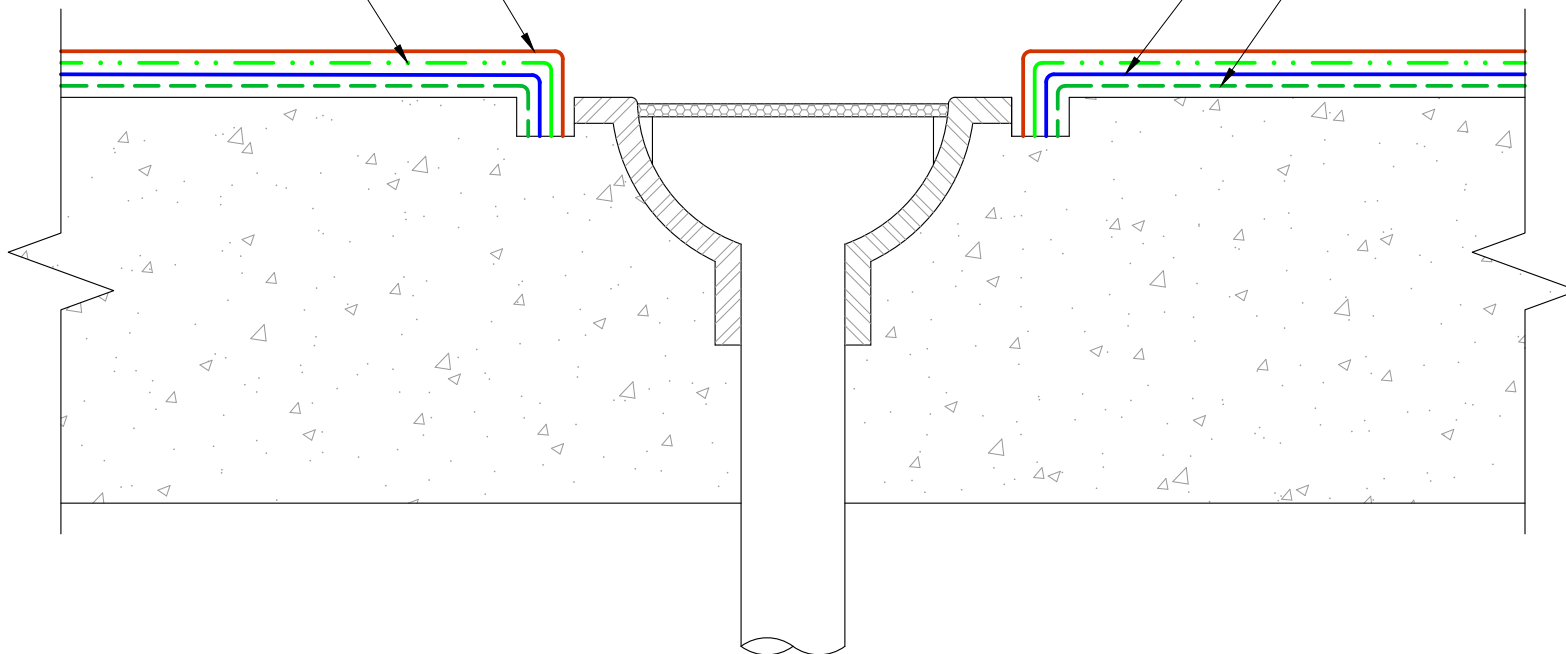

The architecture, engineering, and design of the project using the Tremco products are the responsibility of the project's design professional. All products and systems must comply with local building codes and standards. This detail is for general information and guidance only and Tremco specifically disclaims any liability for the use of this detail. The project design professional determines, in its sole discretion, whether this detail or a functionally equivalent detail is best suited for the project. This detail is subject to change without notice. Contact Tremco to ensure you have the most recent version.

Vulkem EWS Heavy Duty



Detail: Vulkem EWS Heavy Duty at Drain

File Name:

Drawn by: KAB

Checked by: EL

Scale: NTS

Date: 5/21/2022

EWS-HD-D-01



Tremco Technical Support: 866-209-2404

www.tremcocpg.com