

*EITHER PEEL AND STICK OR ENVIRO-DRI MEMBRANE/FABRIC/MEMBRANE

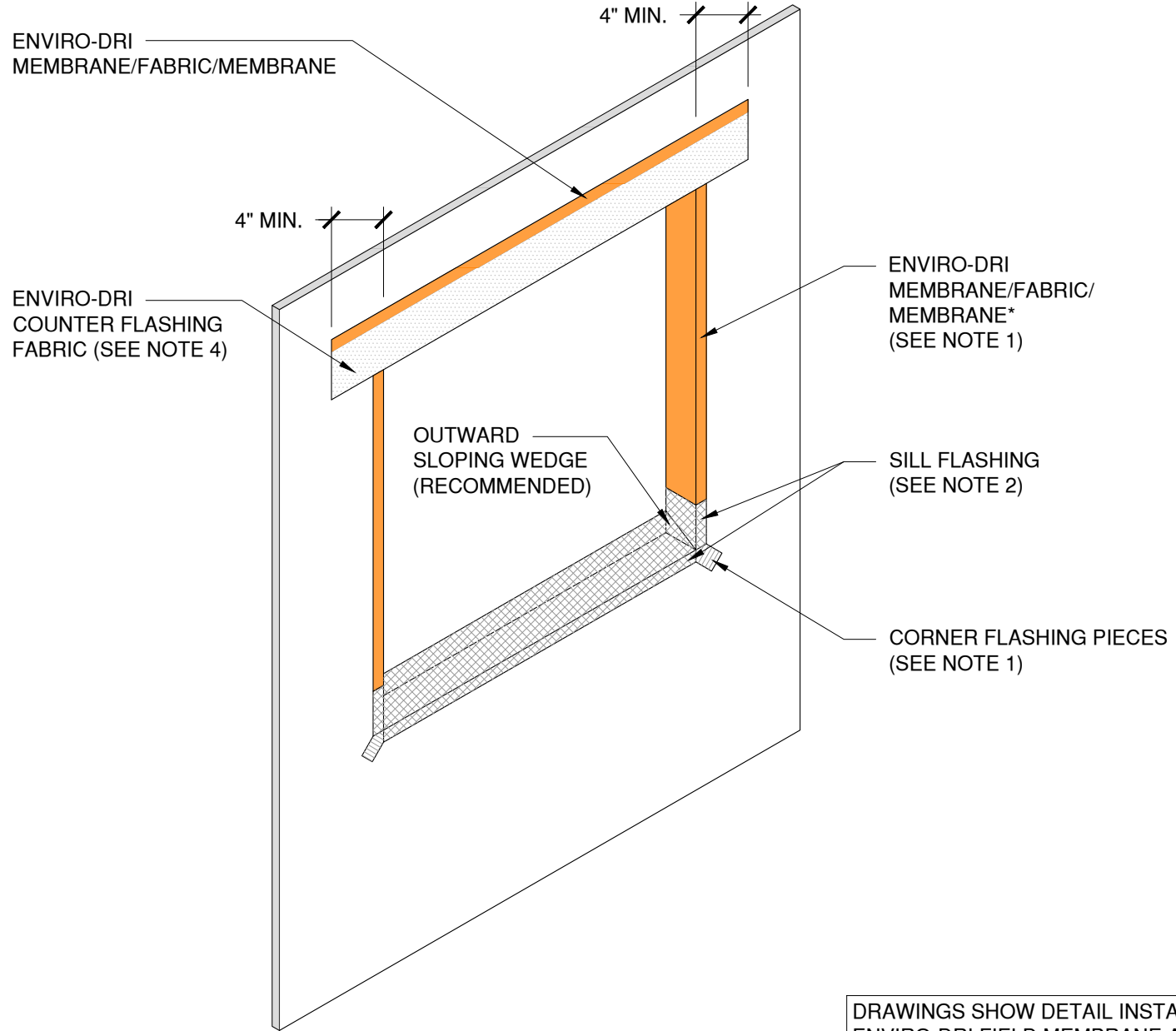

DRAWINGS SHOW DETAIL INSTALLATION PRIOR TO ENVIRO-DRI FIELD MEMBRANE APPLICATION. DETAILS MAY ALSO BE INSTALLED AFTER ENVIRO-DRI FIELD MEMBRANE APPLICATION.

The architecture, engineering, and design of the project using the Tremco products are the responsibility of the project's design professional. All products and systems must comply with local building codes and standards. This detail is for general information and guidance only and Tremco specifically disclaims any liability for the use of this detail. The project design professional determines, in its sole discretion, whether this detail or a functionally equivalent detail is best suited for the project. This detail is subject to change without notice. Contact Tremco to ensure you have the most recent version.

Enviro-Dri



Detail: Enviro-Dri at Window/Door Pre-Installation Opening Detail

File Name:

Drawn by: KAB

Checked by: JS

Scale: NTS

Date: 7/5/2022

ED-RO-02



Tremco Technical Support: 866-209-2404

www.tremcocpg.com

Construction Products Group