

ExoAir 220/230  
 Apply ExoAir Primer  
 to surface of ExoAir 110  
 prior to installing fluid  
 membrane

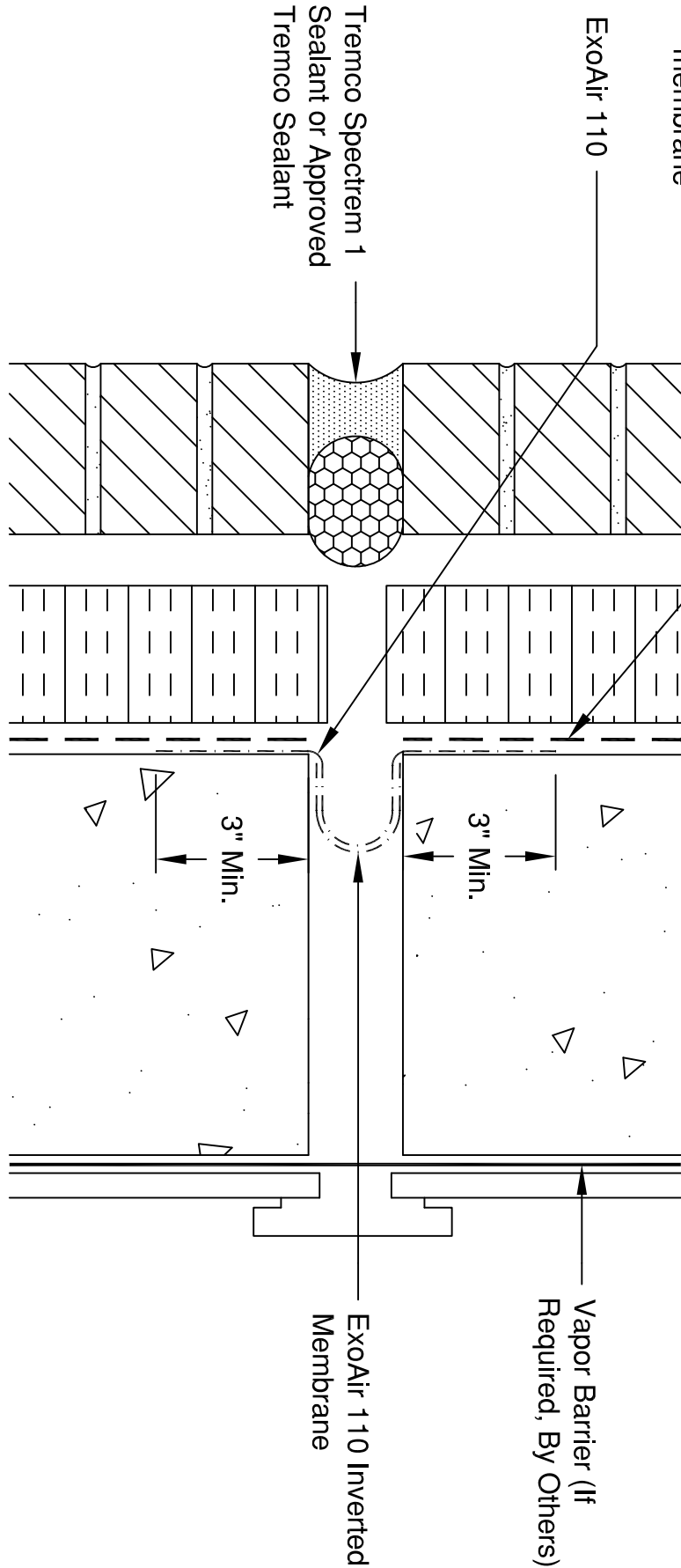

Note: This sample detail is for educational purposes only. Appropriate air barrier details vary by geographic location, climatic conditions, air barrier products used in actual design, and anticipated building use. Contact Tremco Technical Services for further assistance.



3735 Green Road \* Beachwood, OH 44122  
 Phone : 866-209-2404 \* Fax: 216-766-5535

Detail  
**Expansion Joint Detail  
 Method 1-Permeable**

Drawn by: K. Thorpe

Scale: None

Drawing Number  
**A10072**

Date: 08/20/10