

**Outside
Corner**

**Inside
Corner**

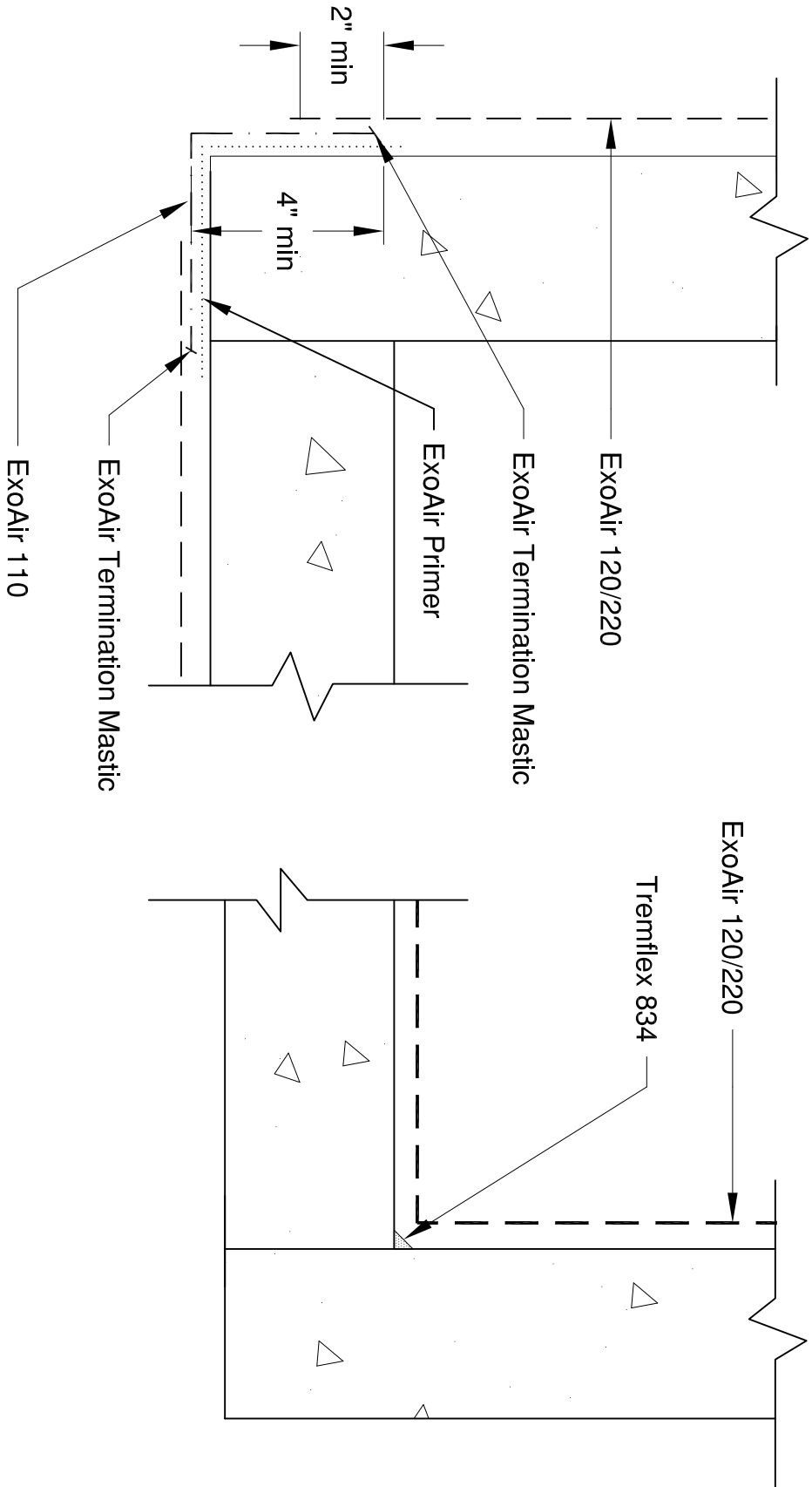

Note: This sample detail is for educational purposes only. Appropriate air barrier details vary by geographic location, climatic conditions, air barrier products used in actual design, and anticipated building use. Contact Tremco Technical Services for further assistance.



3735 Green Road * Beachwood, OH 44122
Phone : 866-209-2404 * Fax: 216-766-5535

Detail

Corners on Concrete (Fluid)

Drawing Number

10049

Drawn by: **K. Thorpe**

Scale: **None**

Date: **11/29/10**