

Extrusion Weld with
copper wire

PolyLock

Paraseal GM/LG 60 Mil
with bentonite side
against concrete

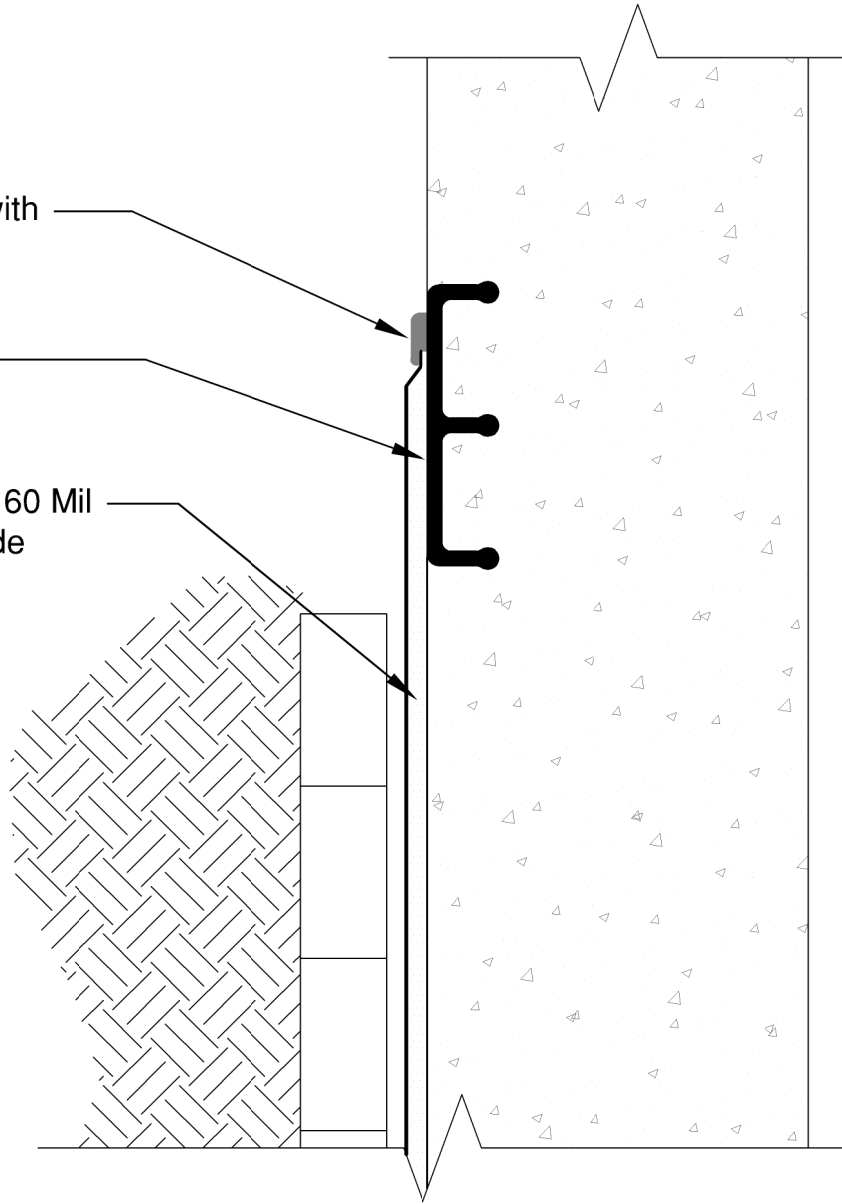

**Note: Paraseal products require a minimum 24 psf
compaction/ confinement in order to function as designed**

This detail is intended for conceptual purposes only. Detail must be reviewed by a project /design professional.
See www.tremcosealants.com for the most up-to-date product information

Rev	Date	Description	By
-	-	-	-

File Name:
12883

Rev #
00

Sheet Number:

Date: 3/5/2014

Project: Paraseal GM/LG 60 Mil
Detail: Typical Termination at Grade w/ParaLock - Blindsided Wall Application

Scale: None

Checked by: xxx

Drawn by: KAB

TREMCO[®]

www.tremcosealants.com
3735 Green Road * Beachwood, OH 44122
Phone : 866-209-2404 * Fax: 216-766-5535