

Proglaze® ETA ^{Patent Pending} Engineered Transition Assembly System 3 – Pressure Bar Applications Clear Proof of a Perfect Seal

Product Description

Proglaze® ETA System 3 consists of pre-engineered silicone materials used as the transition assembly. The system assembly is comprised of a silicone extrusion with a small dart, which is attached to the pressure bar mullion by inserting the dart into the metal race filled with Spectrem® 1 silicone sealant to ensure a durable connection and positive seal. The opposite end of the extrusion will span onto the air and vapor barrier. Proglaze ETA System 3 is comprised of the following components:

1. Silicone Rubber Extrusion (SRE): Extruded, 40 durometer, translucent silicone, with a lock-in dart that will fit a majority of pressure bar race conditions. The Silicone Extrusion is available in 4" and 8" widths and is packaged in 50LF coils (8" shown on page 2). For physical properties refer to Tremco's translucent Silicone Extruded Sheet data sheet.
2. Silicone Rubber Corners (SRC): Pre-molded, 40 durometer, translucent silicone, with a lock-in dart. Silicone Rubber Corners are supplied in left and right-hand mates.
3. Spectrem 1 Silicone Sealant: High movement, ultra-low modulus sealant utilized as a compatible adhesive and wet seal. For physical properties refer to Tremco's Spectrem 1 data sheet.

Basic Uses

Proglaze ETA is a transition assembly for bridging continuously between the window and/or curtain wall openings and the adjacent air and vapor barrier materials. The system's design absorbs thermal movement and wind-loading stresses. The Proglaze ETA thin cross-section and low durometer allows the system to span and seal across irregular window geometries. The translucent silicone material allows the installer and/or inspector to see through the gasket to verify the recommended amount of sealant is properly applied to ensure an effective seal is achieved, while the ribs of the gasket's design ensures a minimum sealant thickness.

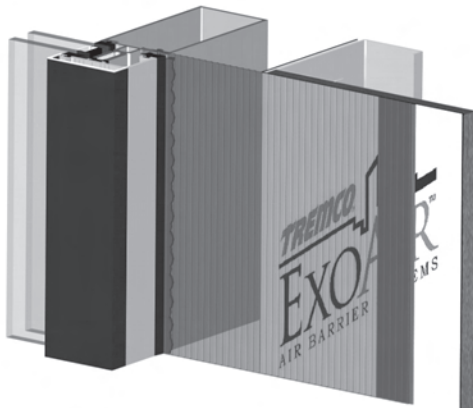

Proglaze ETA System 3 Assembly

The assembly is fully compatible with most window sealants and glazing materials and bonds to ExoAir™ 110 , ExoAir 110LT and ExoAir TWF air barrier materials. Not intended as a seal to untested substrates.

Installation

The Proglaze ETA may be shop and/or field installed depending upon the system's sequence of installation for the particular window and/or curtain wall assembly. To ensure proper connections can be made effectively, the sequence of installation must be reviewed prior to construction. Contact Technical Services for detailed installation instructions, which may be adapted for your application at 1-800-321-6357.

Adhesion testing must be completed on all adjoining substrates and components to ensure proper adhesion. Proglaze ETA may cover or come in contact with pre-applied sealants, gaskets and/or tapes. Testing of these materials must be done to ensure the required bonding is achieved when in contact with components of this engineered transition assembly. Testing may be done on-site and/or may be submitted to Tremco's Technical Services department. Consult your local Tremco Sales Representative. Please refer to Tremco's Installation Instructions for complete details.

Limitations

Not intended to be utilized in a permanently exposed condition unless approved by Tremco. Not intended as a seal to untested substrates.

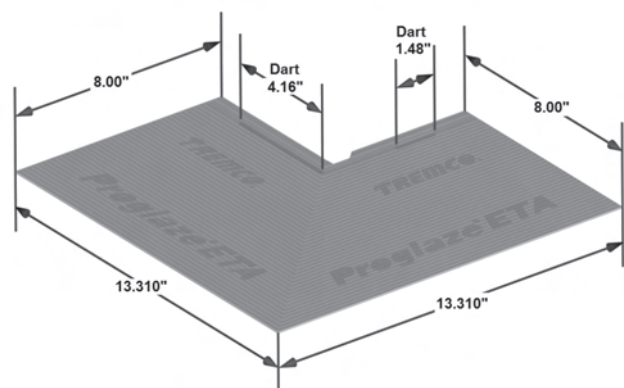

Silicone Molded Corner – Left & Right Handed
Corners - TR-16448S "A" & "B"

ENGINEERED TRANSITION ASSEMBLY SYSTEM PERFORMANCE RESULTS

Property	Test Method	Result
Air Infiltration	ASTM E 283	
77 pa (1.60 psf)		<0.01 cfm/ft ² (<0.05 l/s/m ²)
300 pa (6.27 psf)		<0.01 cfm/ft ² (<0.05 l/s/m ²)
Static Water Resistance Test	ASTM E 331	
720 pa (15.04 psf)		No leakage
Dynamic Water Resistance Test	AAMA 501.1	
1660 pa (34.6 psf)		No leakage
Rack Test (Shift Window unit 2" in Both Directions; 3 Cycles)	AAMA 501.4	No damage
Uniform Load Deflection Test Pressure (after Rack Test)	ASTM E 330	
4790 pa (100 psf positive)		No damage
4790 pa (100 psf negative)		No damage
Uniform Load Structural Test Pressure (after Rack Test)	ASTM E 330	
7180 pa (150 psf positive)		No damage
7180 pa (150 psf negative)		No damage

Warranty

We warrant our products to be free of defects. Under this warranty, we will provide at no charge, products in containers to replace any product proven to be defective when applied, tested and cured (if applicable), in accordance with our written instructions, standards and applications recommended by us as suitable for this product.

User shall determine suitability of the product for their intended use and assume all risk and liability therewith. Seller shall not be liable for any injury, loss or damage, direct or consequential, arising out of the use of the product.

All claims concerning product defects must be made within twelve (12) months of shipment. Absence of such claims in writing, during this period, will constitute a waiver of all claims with respect to such product. This warranty is the user's sole remedy and is IN LIEU OF any and all other warranties expressed or implied, including but not limited to, any implied warranty of MERCHANTABILITY OR FITNESS FOR A PARTICULAR PURPOSE.

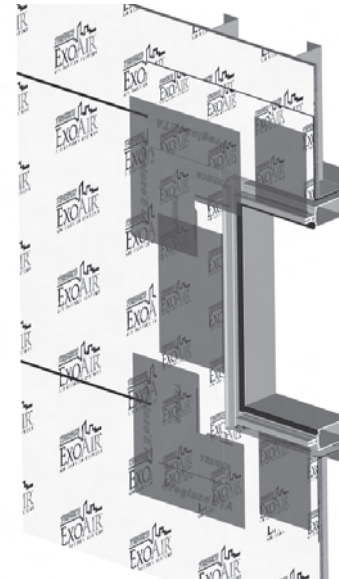

Typical System Assembly

Contact Tremco's Design Engineering Group at 800-321-6357 for information on custom designs.



Proglaze ETA System 3 with Silicone Extrusion

For additional details and information on Engineered Transition Assemblies, please visit our website at www.tremcosealants.com.