

## Metal-to-Metal Internal Seals

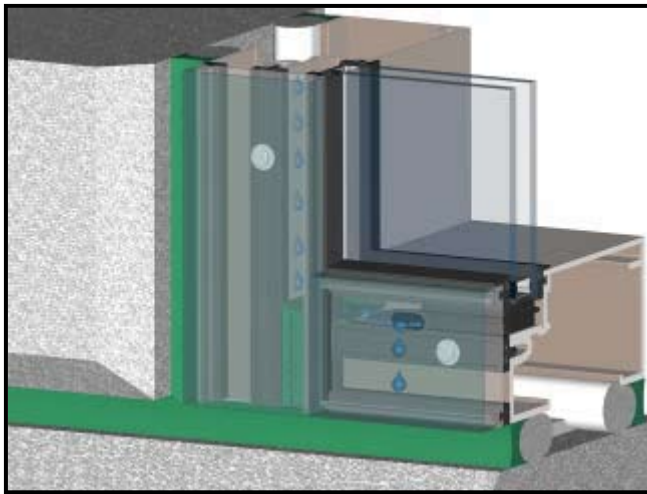
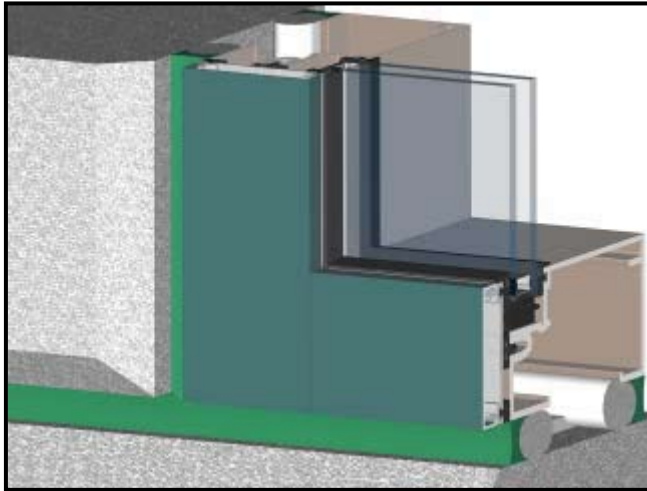

- You cannot determine the integrity of metal to metal seals from the exterior.
  
- Deglazing the system allows you to determine if system is performing as designed.
- If the system unit is allowing water to enter the structure, testing should be done to determine the entry point(s) of the water. ASTM and AAMA test methods should be utilized.
- Tremco recommends complete deglazing of unit to make these determinations.

- If the internal metal-to-metal seals have been determined to have failed or were improperly installed the most economical method of correcting the problem may be to wet seal the exterior with a cap bead of silicone sealant. Additional exterior joinery seals may be required and custom cruciform's to make these seals are available.
- Go to [SILICONE MOLDED SPLICE CONNECTIONS AND COMPONENTS](#) for more information.

For more information on Tremco's Glazing and Facade Restoration Solutions, please visit our website at [www.tremcosealants.com](http://www.tremcosealants.com) or contact your local Tremco Sales Representative.