

Design No. TL/PV 120-05

January 22, 2003

Vertical (Wall)

F & T Ratings: 2 Hour

Test Pressure Differential - 2.5 Pa (0.01" of Water) Minimum

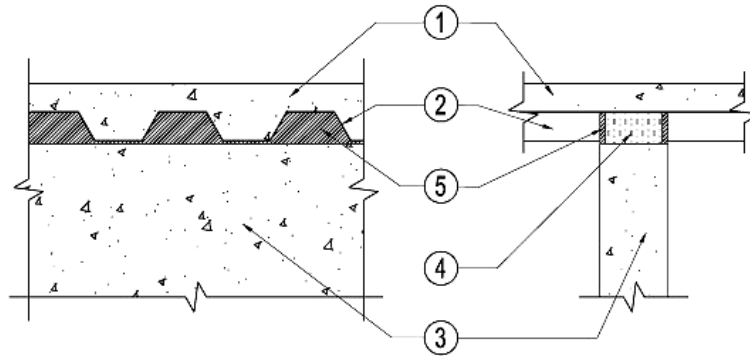

1. **Normal Weight Concrete:** 2-1/2" thickness minimum over flutes in steel decking.
2. **Steel Deck:** 18 gauge fluted steel deck, maximum flute depth 3".
3. **Wall Assembly:** 1 or 2 Hour rated cast concrete on filled concrete block (CMU) wall assembly. Rating of firestop assembly equals that of wall assembly.
4. **Insulation:** 3.5 pcf mineral wool insulation compressed to 7 pcf when packed in fluted openings and space between top of wall and underside of steel deck.
5. **Firestop Sealant:** TREMstop Acrylic sealant applied over insulation to a minimum wet thickness of 1/2".



Reproduced courtesy of Intertek Testing Services
Copyright © 2008 Intertek Testing Services Inc.