

System No. FF-D-0040

July 20, 2004

Assembly Rating – 2 Hr

L Rating At Ambient - Less Than 1 CFM/Lin Ft

L Rating At 400F - Less Than 1 CFM/Lin Ft

Joint Width - 1 In. Max

Class II Movement Capabilities - 8% Compression or Extension
(UL/cUL)

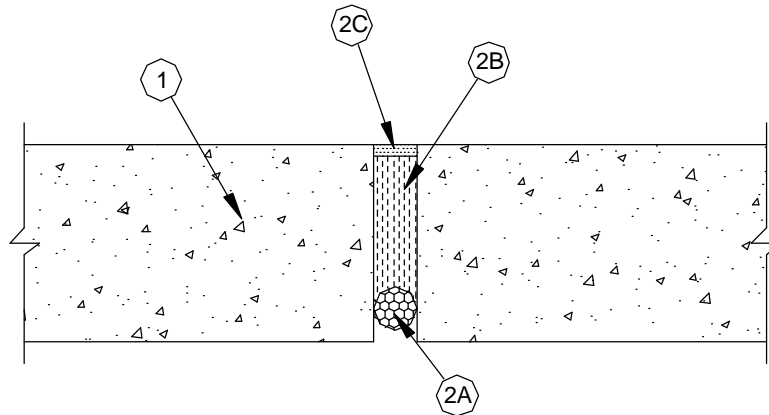

1. **Floor Assembly** – Min 4-1/2 in. (114 mm) thick reinforced lightweight or normal weight (100-150 pcf (1600-2400 kg/cu meter)) structural concrete.
2. **Joint System** – Max width of joint (at time of installation of joint system) is 1 in. (25 mm). The joint system is designed to accommodate a max 8 percent compression or extension from it's installed width. The joint system shall consist of the following:
 - A. **Packing Material** – Nom 1-1/2 in. (38 mm) diam polyethylene backer rod compressed and firmly packed as a permanent form. Packing material to be recessed from top surface of floor to accommodate the required thickness of forming and fill materials.
 - B. **Forming Material*** – Min 6 pcf (96 kg/cu meter) ceramic blanket insulation installed in joint as a permanent form. Section 6 in. (152 mm) wide folded in half and packed into joint with min 50 percent compression. Forming material shall be recessed from top surface of floor as required to accommodate the required thickness of fill material.

TREMCO INC – TREMstop FS Blanket
 - C. **Fill, Void or Cavity Material*** – Min 1/4 in. (6 mm) thickness of fill material applied within the joint, flush with top surface of floor.

TREMCO INC – Fyre-Sil

*Bearing the UL Classification Mark



Reprinted from the Online Certifications Directory with permission from Underwriters Laboratories Inc.
Copyright © 2008 Underwriters Laboratories Inc. ®