

System No. FF-D-0039

July 08, 2003

Assembly Rating - 3 Hr

Joint Width - 2 In. Maximum

Class I and II Movement Capabilities - 18% Compression or Extension
(UL/cUL)

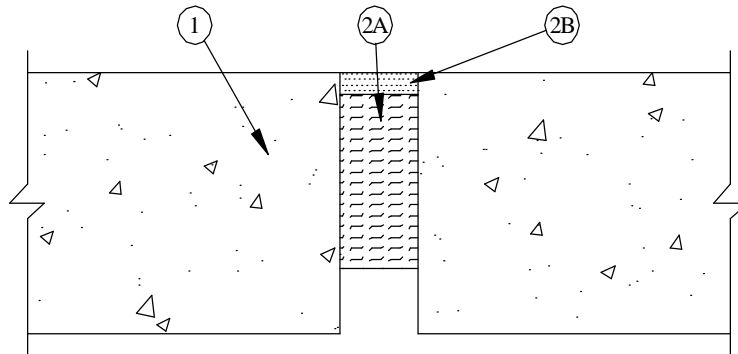

1. **Floor Assembly** – Min 6 in. (152 mm) thick reinforced lightweight or normal weight (100-150 pcf (1600-2400 kg/m³) structural concrete.
2. **Joint System** – Max width of joint is 2 in. (51 mm) The joint system shall consist of the following:
 - A. **Packing Material** – Min 4 in. (102 mm) thickness of min 4 pcf (64 kg/m³) mineral wool batt insulation installed in joint opening as a permanent form. Pieces of batt cut to min width of 4 in. and installed edge- first into joint opening, parallel with joint direction, such that batt sections are compressed min 50 percent in thickness and recessed from top surface of floor as required to accommodate the required thickness of fill material.

FIBREX INSULATIONS INC – FBX Safing Insulation
ROCK WOOL MANUFACTURING CO – Delta Board
 - B. **Fill, Void or Cavity Material*** – Min 1/2 in. (12 mm) thickness of fill material applied within the joint, flush with top surface of floor.

TREMCO INC – Fyre-Sil S.L. and Fyre-Sil

*Bearing the UL Classification Mark



Reprinted from the Online Certifications Directory with permission from Underwriters Laboratories Inc.
Copyright © 2008 Underwriters Laboratories Inc. ®