

FIELD APPLY SEALANT BAND BOTH SIDES OF JOINT MATERIAL

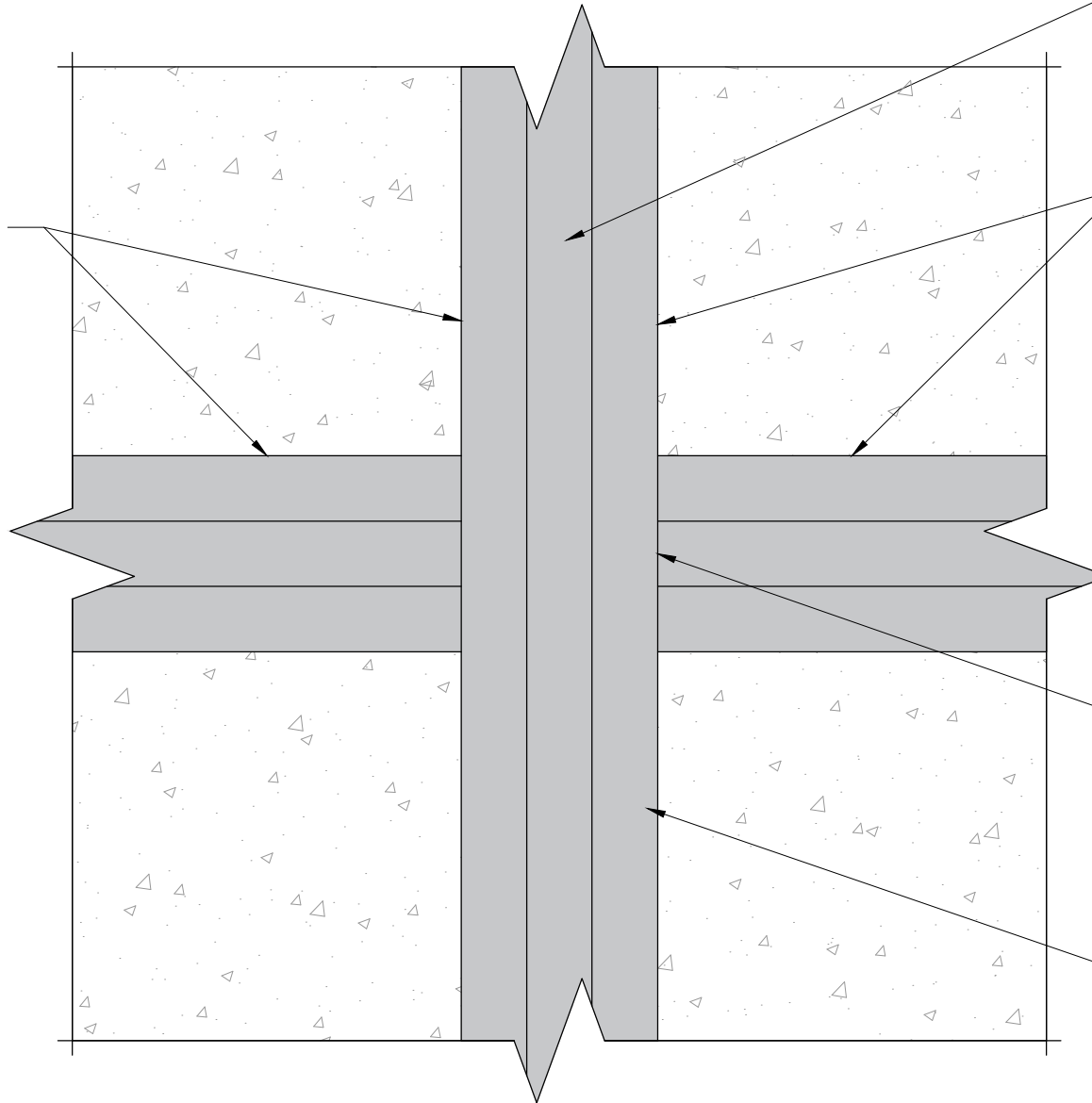

FACTORY APPLIED AND CURED SILICONE

FIELD APPLY SPLICE ADHESIVE TO BOTH MATERIAL ENDS. SPLICE FOLLOWING THE INSTALLATION INSTRUCTIONS SUPPLIED.

FIELD APPLY SEALANT TO BOND THE TWO SILICONE FACES TOGETHER.

FIELD APPLY EPOXY BOTH SIDES OF SUBSTRATE PRIOR TO INSTALLING JOINT MATERIAL. MIX EPOXY FOLLOWING SUPPLIED INSTALLATION INSTRUCTIONS.

*The architecture, engineering, and design of the project using the Willseal products are the responsibility of the project's design professional. All products and systems must comply with local building codes and standards. This detail is for general information and guidance only and Willseal specifically disclaims any liability for the use of this detail. The project design professional determines, in its sole discretion, whether this detail or a functionally equivalent detail is best suited for the project. This detail is subject to change without notice. Contact Willseal to ensure you have the most recent version.*

### Willseal Seismic HS



Willseal Technical Support: 800-274-2813

Detail: Willseal Seismic HS at Cross Joint Installation

Drawn by: HDE

Checked by: AM

Scale: NTS

Date: 7/8/2022

File Name:

WSHS-G-01



Construction Products Group

[www.tremcocpg.com](http://www.tremcocpg.com)