



Construction Products Group

Product Systems  
2023 Line Card





Construction Products Group

## Complete Building Envelope Protection

Total protection from water intrusion. From the elements. From caustic chemicals, deicers, thermal movement, seismic movement, fire and more. Tremco Construction Products Group (CPG) has developed the most comprehensive suite of building envelope protection products available in the industry.

This singular focus ensures seamless compatibility of products and systems. More comprehensive warranties. Single-source accountability. And, knowledgeable representatives in major markets across the country to help assess unique job requirements, ensure proper product selection, conduct jobsite tests and provide on-site assistance.

But we didn't stop there. We're continually pioneering advances in sealant and waterproofing technology to enable products to set new performance standards, dramatically reduce production schedules and provide ever-increasing flexibility in project design and implementation.

We've built a reputation for developing better ways to get the job done.

## The Tremco CPG Difference

A single-source building envelope means more for architects, designers, contractors and building owners alike – more comfortable, satisfied occupants or tenants, more efficient structures, and cost-effective operation for the long term:



### Faster Construction Time

Lightweight, fast-curing and prefabricated products mean less occupant disruption, faster return to service, less revenue lost – and no call-backs.



### Any Look You Want

A wide range of colors and finishes like brick, granite, metals, stucco and more provide maximum flexibility in your roof and façade aesthetic.



### Stronger and More Resilient

Our systems are designed for maximum durability, many with service lives far surpassing that of competing systems.



### Leak-Free Performance

Products provide maximum protection from air, moisture and thermal infiltration – and are performance tested in our one-of-a-kind Building Science Laboratory.



### Cost Effective for the Long Term

A broad range of products can fit any project budget – but our energy efficiency and maintenance solutions can also help you ensure cost-effective ownership and operation for the long term.

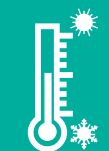

### Better Insulated

Industry-leading brands provide solutions for more efficient building construction and operation, and exceed strict energy codes for insulation.



### One Point of Contact

Our products and systems are backed by industry-leading warranties – all from a single point of contact. We can also help with everything from asset management to diagnostics to installer training.



### Leading Edge Sustainability

Our building solutions help you meet green building standards like Net Zero, Living Building Challenge, Passive House and more.

>> For more information, visit [tremcocpg.com](http://tremcocpg.com)

# Contents

Below-Grade Waterproofing.....	4-5
Traffic Coatings.....	6-7
Flooring.....	8
Engineered Framing.....	8
Insulated Concrete Forms (ICF).....	9
Expansion Joints.....	10
Sealants & Adhesives.....	11-12
Transitions.....	12
Air Barriers.....	13
Firestopping.....	14
Polyurethane Methacrylate (PUMA) Technology.....	14
Glazing.....	15
Exterior Insulation and Finish Systems.....	16-17
Warranty Information.....	18



# TREMCO™ BELOW-GRADE WATERPROOFING

A comprehensive line of below-grade products to provide high-performance waterproofing protection and solutions for even the most challenging applications.

Description	Advantages	Best For / Systems	
<b>Cold Fluid-Applied Waterproofing</b>			
<b>TREMproof® PUMA</b>	A premium system for waterproofing concrete and protecting occupied space from water damage utilizing polyurethane- methacrylate (PUMA) technology. Designed to have tenacious adhesion and extreme abrasion resistance, which allows for quick curing. TREMproof PUMA can be used in planters, flashing systems, horizontal waterproofing, vegetated roofs, and in asphalt overlays.	<ul style="list-style-type: none"> <li>• Quick cure for fast return to service</li> <li>• Extreme durability for advanced protection</li> <li>• Superior elongation to retain integrity with substrate movement</li> <li>• Can be applied in very low temperatures, extending the application season</li> <li>• Zero VOCs provides improved air quality</li> </ul>	<ul style="list-style-type: none"> <li>• Split Slab</li> <li>• Paver Systems</li> <li>• Planters</li> <li>• Vegetated Roofs</li> </ul>
<b>TREMproof® 250GC</b>	A one component, high solids, rapid moisture curing waterproofing membrane designed to be applied to damp and green concrete. A VOC compliant, one-part elastomer, it is available in self-leveling, roller and trowel (detail only) viscosities.	<ul style="list-style-type: none"> <li>• Moisture curing to provide a protective coating and quick cure times</li> <li>• Can be applied to damp and green concrete to condense the project schedule</li> <li>• Ease of application improves labor costs</li> </ul>	<ul style="list-style-type: none"> <li>• Backfilled walls</li> <li>• Planters</li> <li>• Split Slab</li> <li>• Submerged Conditions</li> </ul>
<b>TREMproof® 260</b>	A spray applied below grade waterproofing membrane designed for unsubmerged vertical applications and projects with tight construction cycles. TREMproof 260 is a monolithic asphaltic membrane that protects seams and seals penetrations, reducing time needed for detail work.	<ul style="list-style-type: none"> <li>• Ease of application improves labor cost</li> <li>• Suitable for some methane barrier applications to inhibit soil gas intrusion</li> <li>• Ability to co-spray and fast track application reduces the potential for washout</li> <li>• Can be applied to damp and green concrete to speed up project completion</li> </ul>	<ul style="list-style-type: none"> <li>• Tunnels – cut &amp; cover</li> <li>• Back-filled walls</li> </ul>
<b>TREMproof® 201/60</b>	An economical, fluid-applied waterproofing membrane designed to be used in below grade conditions.	<ul style="list-style-type: none"> <li>• Monolithic to eliminate gaps and seal seams</li> <li>• Economical solution benefits project costs</li> </ul>	<ul style="list-style-type: none"> <li>• Back filled walls</li> <li>• Concrete and masonry</li> <li>• Split slab</li> </ul>
<b>Hot Rubberized Asphalt Waterproofing</b>			
<b>TREMproof® 6100</b>	A robust 100% solids hot applied asphaltic membrane that is both economical and highly versatile. TREMproof 6100 provides a thick, flexible monolithic membrane with very low moisture vapor permeance. Hot rubberized asphalt is a high-performing waterproofing system with a standing track record of over 50 years of use.	<ul style="list-style-type: none"> <li>• Cost effective, reducing overall project costs</li> <li>• Robust thick mil system withstands tough project conditions</li> <li>• Long history of usage, providing proven protection</li> <li>• Standard installation ensures consistent applications</li> <li>• Monolithic membrane eliminates surface gaps and seals seams</li> </ul>	<ul style="list-style-type: none"> <li>• Planters</li> <li>• Roof decks</li> <li>• Split slabs with overburden</li> <li>• Horizontal applications.</li> </ul>
<b>Sheet-Applied Waterproofing</b>			
<b>TREMproof® Amphibia</b>	TREMproof™ Amphibia™ waterproofing membrane is self-healing, self-sealing and self-repairing. It has three active layers - a watertight EPDM barrier, an active core with the ability to seal when penetrated and an active barrier which seals the overlap and helps resist lateral movement of water. Also, a non-woven fabric layer promotes the mechanical adhesion of the membrane to the concrete.	<ul style="list-style-type: none"> <li>• Light weight for easy handling</li> <li>• Self healing, self sealing, self-repairing to reduce time for detail work</li> <li>• Mechanically bonds to concrete and shotcrete for integral adhesion</li> <li>• Weather tolerant, offering project schedule flexibility</li> </ul>	<ul style="list-style-type: none"> <li>• Blindside walls</li> <li>• Under slab</li> <li>• Backfilled walls</li> <li>• Submerged conditions</li> </ul>
<b>TREMproof® 560A</b>	A self-adhesive membrane composed of SBS bitumen, a polyethylene facer that provides foundation waterproofing quickly at a consistent mil thickness.	<ul style="list-style-type: none"> <li>• Summer and winter grade available for use all year</li> <li>• Consistent thickness for reliable protection</li> <li>• Quick installation benefits project application times</li> </ul>	<ul style="list-style-type: none"> <li>• Back filled walls</li> <li>• CMU and poured concrete walls</li> <li>• Insulated concrete forms</li> </ul>
<b>Paraseal®</b>	A sheet applied waterproofing membrane composed of 15 mils of durable, watertight, HDPE topped with granular bentonite, creating a singular product dual waterproofing membrane.	<ul style="list-style-type: none"> <li>• Dual layer waterproofing protection improves waterproofing ability</li> </ul>	<ul style="list-style-type: none"> <li>• Back filled walls</li> <li>• Damp and green concrete</li> </ul>
<b>Paraseal® LG</b>	A sheet waterproofing membrane featuring a watertight HDPE layer and a layer of expandable granular bentonite covered with a spun-bonded polyester scrim cloth designed to hold the bentonite in place when hung vertically.	<ul style="list-style-type: none"> <li>• Dual layer waterproofing protection improves waterproofing ability</li> <li>• Designed to be applied to lagging walls without damaging the bentonite layer</li> </ul>	<ul style="list-style-type: none"> <li>• Blind side applications</li> <li>• Under slab</li> <li>• Back filled walls</li> <li>• Buried forms</li> <li>• Damp and green concrete</li> </ul>
<b>Paraseal® GM</b>	A sheet applied waterproofing and methane mitigating membrane consisting of durable HDPE and granular bentonite. Paraseal GM features bentonite free seldge edges ideal for extrusion welding and/or the installation of Para JT Tape and Parastick 'n' Dry Tape.	<ul style="list-style-type: none"> <li>• Seldge edge for taping and welding to seal seams</li> <li>• Methane mitigation to inhibit soil gas intrusion</li> <li>• Dual layer waterproofing protection improves waterproofing ability</li> </ul>	<ul style="list-style-type: none"> <li>• Post-installation submerged conditions on backfilled walls</li> <li>• Under slab</li> <li>• Split slab</li> </ul>
<b>Paraseal® GM/LG</b>	A sheet applied waterproofing and methane mitigating membrane consisting of durable HDPE and granular bentonite with a layer of protective spun-bond polyester. Paraseal GM/LG features bentonite free seldge edges ideal for extrusion welding and/or the installation of Para JT Tape and Parastick 'n' Dry Tape.	<ul style="list-style-type: none"> <li>• Seldge edge for taping and welding to seal seams</li> <li>• Methane mitigation to inhibit soil gas intrusion</li> <li>• Dual layer water proofing protection improves waterproofing ability</li> <li>• Protective polyester layer allows for use in blindside conditions for tough applications</li> </ul>	<ul style="list-style-type: none"> <li>• Blindside walls</li> <li>• Under slab</li> <li>• Submerged conditions</li> <li>• Methane conditions</li> <li>• Hydrostatic head conditions</li> </ul>
<b>Multi-Component Waterproofing Systems</b>			
<b>TREMproof® Dual Waterproofing System (DWS)</b>	A dual membrane waterproofing system comprised of TREMproof TRA sheeting embedded into TREMproof 250GC. This unique waterproofing system is designed to have tenacious adhesion, long term durability, and remarkable chemical stability.	<ul style="list-style-type: none"> <li>• High elastomeric properties for crack bridging</li> <li>• Long term durability for advanced protection</li> <li>• Chemical adhesion between structure and membrane ensures physical bond to concrete</li> </ul>	<ul style="list-style-type: none"> <li>• Backfilled walls</li> <li>• Plaza decks</li> <li>• Split slabs</li> <li>• Planters</li> <li>• Terraces</li> </ul>
<b>TREMproof® Triple Waterproofing System (TWS)</b>	A blindside and underslab triple-layer waterproofing assembly consisting of 20 mils of HDPE, expandable granular bentonite with a protective layer of spun-bonded polyester, coated with 60 dry mils of polymer-enhanced, liquid-applied asphalt membrane.	<ul style="list-style-type: none"> <li>• Superior defense against inclement weather conditions, preventing bentonite hydration prior to concrete placement.</li> <li>• Chemical bond between concrete and the waterproofing membrane elimination potential for lateral water migration between the structure and the membrane.</li> <li>• Belt and suspender approach ensuring no water can pass through the multi-layer waterproofing membranes</li> </ul>	<ul style="list-style-type: none"> <li>• Flashing joints</li> <li>• Flashing transitions in plane</li> <li>• Flashing horizontal-to-vertical transitions</li> <li>• Flashing waterproofing where a durable, reinforcing sheeting is required</li> </ul>

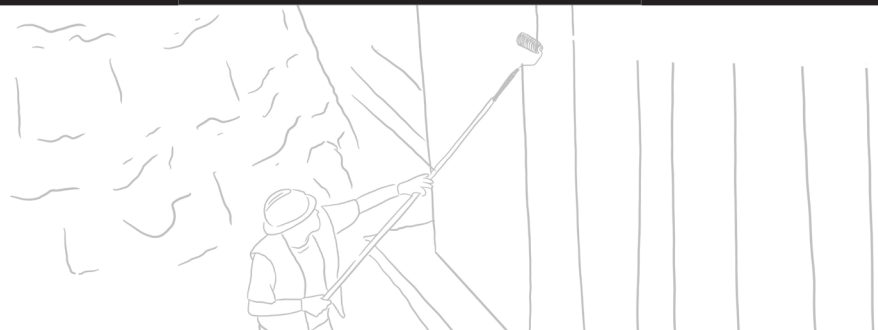



# BELOW-GRADE WATERPROOFING

A comprehensive line of below-grade products to provide high-performance waterproofing protection and solutions for even the most challenging applications.

Description	Advantages	Best For / Systems	
<b>Waterstops</b>			
Superstop	Superstop is a composite waterstop containing expandable, granular bentonite layered with a pressure sensitive adhesive on one side to be used in cold joints and around penetrations to prevent water migration.	<ul style="list-style-type: none"> <li>Economical to benefit project costs</li> <li>Prevents water migration through construction joints, protecting against leakage</li> </ul>	<ul style="list-style-type: none"> <li>Cold joints</li> <li>Penetrations</li> <li>Salt and fresh water conditions</li> </ul>
<b>Crystalline Waterproofing</b>			
Permaquick® Crystalline Waterproofing	A crystalline waterproofing grout that reacts with water and lime present in concrete structures to halt the migration of water by forming crystallized chains that penetrate into the capillaries of the concrete.	<ul style="list-style-type: none"> <li>Economical to benefit project costs</li> <li>Waterproofs the concrete itself without the addition of membranes, eliminating migration of water</li> </ul>	<ul style="list-style-type: none"> <li>Foundation walls</li> <li>Floor slabs</li> <li>Suspended and In-ground pools</li> <li>Parking garage floors</li> </ul>
<b>Flashing</b>			
TREMproof® PUMA Flashing System	A multi-component liquid-applied system based on PUMA technology that system cures within 30 minutes, even in temperatures below freezing.	<ul style="list-style-type: none"> <li>Strong adhesion to concrete and metal for versatile usage</li> <li>Cures within 30 minutes for quick return to service</li> <li>Can be installed in temperatures below freezing, expanding application times</li> </ul>	<ul style="list-style-type: none"> <li>Transitions of planes</li> <li>HRA waterproofing systems</li> <li>Urethane and PUMA base coats</li> </ul>
Tremco® DualFlex	A reinforcing flashing that consists of a central strip of elastomeric SEBS rubber flanked on either side by an absorbent non-woven felt, which allows the flashing to easily integrate into waterproofing membranes while providing movement capabilities.	<ul style="list-style-type: none"> <li>Easily integrates into waterproofing membranes for efficient use</li> <li>SEBS rubber central strip allows for movement, helping bridge cracks</li> </ul>	<ul style="list-style-type: none"> <li>Joints</li> <li>Transitions of planes</li> <li>HRA waterproofing systems</li> <li>Urethane and PUMA base coats</li> </ul>
<b>Drainage Mats - Vertical Applications</b>			
TREMDrain NW	A two-layer drainage mat consisting of a polystyrene core and non-woven, needle-punched polypropylene fabric. TREMDrain NW provides an economical solution for single-sided subsurface drainage applications requiring a typical non-woven filter fabric bonded to a lower compressive strength and moderate flow capacity formed core.	<ul style="list-style-type: none"> <li>Serves as a protection course and replacement for traditional pipe and stone drainage systems.</li> <li>Lower compressive strength</li> <li>Moderate flow capacity</li> </ul>	<ul style="list-style-type: none"> <li>Vertical walls less than 20 ft</li> <li>Backfilled Walls</li> <li>Blindside Walls</li> </ul>
TREMDrain 1000 NW	Designed for single-sided subsurface vertical drainage applications requiring a typical non-woven filter fabric bonded to a high compressive strength and high flow capacity formed core.	<ul style="list-style-type: none"> <li>Serves as a protection course and replacement for traditional pipe and stone drainage systems.</li> <li>High compressive strength</li> <li>High flow capacity</li> </ul>	<ul style="list-style-type: none"> <li>Vertical walls greater than 20 ft</li> <li>Backfilled Walls</li> </ul>
TREMDrain 6000	A multi-composite prefabricated drainage material and protection board consisting of a formed polypropylene core covered on one side with a high strength, spun-bonded polypropylene filter fabric. TREMDrain 6000 NW is designed for single-sided subsurface vertical drainage applications requiring a typical non-woven filter fabric bonded to a high compressive strength and high flow capacity formed core.	<ul style="list-style-type: none"> <li>Serves as a protection course and replacement for traditional pipe and stone drainage systems.</li> <li>High compressive strength</li> <li>High flow capacity</li> </ul>	<ul style="list-style-type: none"> <li>Vertical walls greater than 20 ft</li> <li>Backfilled Walls</li> </ul>
TREMDrain Total Drain	Designed to provide a value engineered alternative to perforated pipe and aggregate subsurface drainage systems in applications requiring high strength and high flow capacity.	<ul style="list-style-type: none"> <li>Integrated transition flange for easy connection to sheet drain products</li> <li>Serves as a replacement for traditional pipe and stone drainage systems.</li> </ul>	<ul style="list-style-type: none"> <li>Perimeter drain applications</li> <li>Backfilled Walls</li> <li>Blindside Walls</li> </ul>
TREMDrain™ QSP	Designed specifically to reduce installation time and improve membrane curing time. The lightweight, easy-to-install panels offer economical drainage solutions saving contractors time and money.	<ul style="list-style-type: none"> <li>Lightweight</li> <li>Panels set into liquid membranes</li> <li>Reduce installation time</li> <li>Improve membrane curing time over traditional drain mat</li> </ul>	<ul style="list-style-type: none"> <li>Fast tracked vertical applications with liquid applied membranes</li> <li>Backfilled Walls</li> </ul>
<b>Drainage Mats - Horizontal Applications</b>			
TREMDrain S NW	Designed for horizontal drainage applications requiring a high compressive strength and moderate flow capacity. TREMDrain S NW uses a typical non-woven filter fabric and includes a protective backing film for added membrane protection.	<ul style="list-style-type: none"> <li>Serves as a protection course and replacement for traditional pipe and stone drainage systems.</li> <li>Added backing film for added membrane protection</li> <li>High compressive strength</li> <li>Moderate flow capacity</li> </ul>	<ul style="list-style-type: none"> <li>Under Slab</li> <li>Split Slab</li> </ul>
TREMDrain 1000 PF	Designed for single-sided subsurface vertical drainage applications requiring a typical non-woven filter fabric bonded to a high compressive strength and high flow capacity formed core. TREMDrain 1000 PF incorporates a protective backing film for added membrane protection.	<ul style="list-style-type: none"> <li>Serves as a protection course and replacement for traditional pipe and stone drainage systems.</li> <li>Added backing film for added membrane protection</li> <li>High Compressive Strength</li> <li>High Flow Capacity</li> </ul>	<ul style="list-style-type: none"> <li>Under Slab</li> <li>Split Slab</li> </ul>
TREMDrain 2000 NW	Designed for horizontal drainage applications requiring a high compressive strength and high flow capacity. TREMDrain 2000 NW uses a high strength Class 1 needle-punched, non-woven filter fabric with a protective backing film for added membrane protection.	<ul style="list-style-type: none"> <li>Serves as a protection course and replacement for traditional pipe and stone drainage systems.</li> <li>Added backing film for added membrane protection</li> </ul>	<ul style="list-style-type: none"> <li>Split Slabs</li> <li>Plaza and Paver decks</li> </ul>
TREMDrain 3000 NW	Designed for horizontal drainage applications requiring a high compressive strength and moderate flow capacity. TREMDrain 3000 NW uses a high strength Class 1 needle-punched, non-woven filter fabric and includes a protective backing film for added membrane protection.	<ul style="list-style-type: none"> <li>Serves as a protection course and replacement for traditional pipe and stone drainage systems.</li> <li>Added backing film for added membrane protection</li> <li>High compressive strength</li> <li>Moderate flow capacity</li> </ul>	<ul style="list-style-type: none"> <li>Split Slab</li> <li>Planters</li> </ul>
TREMDrain GS	Designed specifically for Green Roof applications, the TREMDrain GS provides an economical solution for drainage, aeration, water storage, soil retention, root barrier, and waterproofing membrane protection in one easy lightweight product.	<ul style="list-style-type: none"> <li>Aids in water storage and soil retention.</li> <li>Serves as a root barrier.</li> </ul>	<ul style="list-style-type: none"> <li>Vegetative Roof Systems</li> <li>Greenscapes where water retention is desired</li> </ul>



# TREMCO™ TRAFFIC COATINGS

A full line of coating systems for vehicular and pedestrian deck applications as well as coatings for specialty applications, including low-VOC, low-odor formulations ideal for occupied areas.

Description	Advantages	Best For / Systems
<b>Base Coats</b>		
<b>Vulkem® 350</b> A durable single-component, polyurethane base coat that is cost effective and ideal for waterproofing concrete slabs, while protecting from water migration in the concrete substrate. Recoatable with other Tremco sealants and can be applied under any Vulkem topcoat or used under tile to provide waterproofing.	<ul style="list-style-type: none"> <li>• Low temperature application extends the season for applications</li> <li>• Retains integrity even if substrate movement causes hair-line cracks of up to 1/16" (1.5 mm)</li> <li>• Roller Grade and Self Leveling grades available</li> </ul>	<ul style="list-style-type: none"> <li>• Pedestrian &amp; vehicular decks</li> <li>• Under tile</li> <li>• Athletic surfaces</li> <li>• Mechanical rooms</li> <li>• Balconies</li> </ul>
<b>Vulkem® 350FC</b> Two-component, fast-curing, durable polyurethane base coat that offers protection for waterproofing concrete slabs and providing protection from water migration in the concrete substrate. Compatible with all Tremco urethane intermediate and top coats. (Currently only available in Canada.)	<ul style="list-style-type: none"> <li>• Low VOC to help improve surrounding air quality</li> <li>• Fast curing which allows for a quick return to use of areas after application</li> <li>• Retains integrity even if substrate movement causes hair-line cracks of up to 1/16" (1.5 mm)</li> </ul>	<ul style="list-style-type: none"> <li>• Pedestrian &amp; vehicular decks</li> <li>• Athletic surfaces</li> <li>• Mechanical rooms</li> <li>• Balconies</li> </ul>
<b>Vulkem® 350NF</b> A durable single-component, polyurethane base coat that offers protection for waterproofing concrete slabs, while protecting from water migration in the concrete substrate. Quick curing and allows for quick turnaround of areas after application. It is also neighbor friendly and ideal for use in areas that need low odor applications and can be applied underneath any Vulkem topcoat or under tile.	<ul style="list-style-type: none"> <li>• Low VOC's and low odor are ideal for use in inhabited structures</li> <li>• Retains integrity even if substrate movement causes hair-line cracks of up to 1/16" (1.5 mm)</li> <li>• Roller Grade and Self Leveling grades available</li> </ul>	<ul style="list-style-type: none"> <li>• Pedestrian &amp; vehicular decks</li> <li>• Window flashings</li> <li>• Athletic surfaces</li> <li>• Mechanical rooms</li> <li>• Balconies</li> <li>• Under tile</li> </ul>
<b>Vulkem® 360NF</b> A durable two-component, water cured, polyurethane base coat that is ideal for waterproofing concrete slabs, while protecting from water migration in the concrete substrate. It is also neighbor friendly and ideal for use in areas that need low odor applications. Recoatable and compatible with other Tremco sealants and expansion joints, which enhances waterproofing protection.	<ul style="list-style-type: none"> <li>• Low VOC's and low odor are ideal for use in neighbor-friendly, inhabited structures</li> <li>• Can be used to slope decks and fill in low and spalled concrete when mixed with aggregate</li> <li>• Retains integrity even if substrate movement causes hair-line cracks of up to 1/16" (1.5 mm)</li> </ul>	<ul style="list-style-type: none"> <li>• Pedestrian &amp; vehicular decks</li> <li>• Athletic surfaces</li> <li>• Mechanical rooms</li> <li>• Balconies</li> </ul>
<b>Intermediate Coats</b>		
<b>Vulkem® 346</b> High performing, aliphatic, single component intermediate polyurethane wear coat loaded with aggregate to provide excellent impact, abrasion and chemical resistance. Vulkem 346 is recoatable to extend the service life of the coating system.	<ul style="list-style-type: none"> <li>• Fast curing allows for use of applied area 72 hours after installation</li> <li>• UV-Stable to protect from the damage of the sun's rays</li> </ul>	<ul style="list-style-type: none"> <li>• Vehicular decks</li> </ul>
<b>Vulkem® 950NF</b> A high performing, two component intermediate polyurethane wear coat that is neighbor friendly and ideal for use in areas that need low odor applications. This intermediate coat is loaded with aggregate to give the system excellent impact, abrasion, and chemical resistance.	<ul style="list-style-type: none"> <li>• Low VOC's and low odor are ideal for use in inhabited structures</li> <li>• Fast curing allows for use of applied area 72 hours after installation</li> </ul>	<ul style="list-style-type: none"> <li>• Pedestrian decks</li> <li>• Vehicular decks</li> <li>• Mechanical rooms</li> </ul>
<b>Vulkem® Epoxy WC</b> A two-part intermediate epoxy wear coat loaded with aggregate that gives excellent impact and abrasion resistance. Vulkem Epoxy WC offers enhanced durability vs. urethane-only systems.	<ul style="list-style-type: none"> <li>• Compatible with all Tremco Vulkem base and top coats</li> <li>• Low VOC's and low odor are ideal for use in inhabited structures</li> <li>• Extended service life and warranty compared to urethane-only systems</li> <li>• Superior aggregate retention</li> <li>• Resistant to chemicals, salts, mildew, fungus, and other environmental contaminants</li> </ul>	<ul style="list-style-type: none"> <li>• Vehicular decks</li> <li>• High wear turning and drive lanes</li> <li>• Ticket spitters</li> <li>• Stadium/plaza decks</li> <li>• Helical ramps</li> </ul>
<b>Top Coats</b>		
<b>Vulkem® 950NF</b> A two-component polyurethane top coat that is applied after the intermediate coat has cured. The topcoat affords excellent abrasion and chemical resistance to complete the Vulkem Traffic Deck Coating System. It is also neighbor friendly and ideal for use in areas that need low odor applications.	<ul style="list-style-type: none"> <li>• Low VOC's and low odor are ideal for use in inhabited structures</li> <li>• Mildew and fungus resistance safeguards concrete surfaces against environmental contaminants.</li> <li>• Recoatable and compatible with other Tremco sealants and expansion joints, which enhance waterproofing protection with full system compatibility</li> <li>• Fast curing allows for use of applied area 72 hours after installation</li> </ul>	<ul style="list-style-type: none"> <li>• Vehicular decks</li> <li>• Pedestrian decks</li> <li>• Mechanical rooms</li> </ul>
<b>Vulkem® 951NF</b> A high-performance two component polyurethane top coat that is applied after the intermediate coat has cured. Ideal for pedestrian (medium duty) and vehicular (heavy duty) applications. The top coat affords excellent abrasion resistance, UV stability and chemical resistance to complete the Vulkem Traffic Deck Coating System. It is also neighbor friendly and ideal for use in areas that need low odor applications.	<ul style="list-style-type: none"> <li>• Low VOC's and low odor are ideal for use in neighbor-friendly, inhabited structures</li> <li>• Fast cure through time allows for use 12 to 24 hours after installation</li> <li>• Excellent durability and UV resistance extend the useful life of pedestrian systems</li> <li>• Recoatable and compatible with other Tremco sealants and expansion joints, which enhances waterproofing protection with full system compatibility</li> </ul>	<ul style="list-style-type: none"> <li>• Vehicular decks</li> </ul>
<b>Vulkem® 346</b> Single component polyurethane top coat that is applied after the intermediate coat has cured for use on vehicular decks. The top coat affords excellent abrasion resistance, UV stability and chemical resistance to complete the Vulkem Traffic Deck Coating System.	<ul style="list-style-type: none"> <li>• Fast curing, which allows for a quick return to use</li> <li>• UV Stable to protect from the damage of the sun's rays</li> <li>• Mildew and fungus resistance safeguards concrete surfaces against environmental contaminants</li> </ul>	<ul style="list-style-type: none"> <li>• Vehicular decks</li> </ul>
<b>Vulkem® 351/351NF</b> Single component polyurethane top coat, which when used in conjunction with the recommended aggregate, creates a tough, aesthetically appealing, skid resistant, wearing surface that forms a UV resistant, strong interlaminar bond to the basecoat completing the Vulkem Traffic Deck Coating System.	<ul style="list-style-type: none"> <li>• Fast curing, ideal for heavy duty pedestrian applications</li> <li>• When used with aggregate, creates a tough, skid-resistant, wearing surface</li> <li>• Recoatable and compatible with other Tremco sealants and expansion joints, which enhances waterproofing protection with full system compatibility</li> <li>• UV Stable to protect from the damage of the sun's rays</li> <li>• Mildew and fungus resistance safeguards concrete surfaces against environmental contaminants</li> </ul>	<ul style="list-style-type: none"> <li>• Balconies</li> <li>• Pedestrian decks</li> <li>• Athletic surfaces</li> <li>• Mechanical rooms</li> </ul>
<b>Specialty Coatings</b>		
<b>Vulkem® OC810</b> Single component, high solids polyurethane membrane topcoat designed to be applied in one coat as a waterproofing system. Mildew and fungus resistance safeguards concrete surfaces against environmental contaminants. Ideal for light pedestrian traffic areas.	<ul style="list-style-type: none"> <li>• One coat application reduces installation time and saves on labor</li> <li>• Low VOC's and low odor are ideal for use in inhabited structures</li> <li>• Mildew and fungus resistance safeguards concrete surfaces against environmental contaminants</li> <li>• Excellent durability and UV resistance extends the useful life of pedestrian systems</li> <li>• Fast cure through time allows for use the next day</li> </ul>	<ul style="list-style-type: none"> <li>• Balconies</li> <li>• Pedestrian decks</li> <li>• Mechanical rooms</li> </ul>
<b>Vulkem® 801</b> Vulkem 801 is a heavy duty aluminized polyurethane coating that can be formulated to have high tensile and tear strengths and elongation, all in a viscosity grade that can be used horizontally and vertically. This coating forms a tough, weather resistant, waterproof, elastomeric coating for a variety of waterproofing applications that require a weather-resistant coating.	<ul style="list-style-type: none"> <li>• One product can be applied to any application with viscosity</li> <li>• Resistance to ponded water</li> <li>• Able to repair built-up decks where a temporary fix is required</li> </ul>	<ul style="list-style-type: none"> <li>• Cooling tanks for ponded water</li> <li>• Gutter and rainwater applications</li> <li>• Exposed parapets to connect inverted roof requiring waterproofing</li> </ul>

NF = Neighbor-Friendly SL = Self-Leveling R = Roller

# TREMCO™ TRAFFIC COATINGS

A full line of coating systems for vehicular and pedestrian deck applications as well as coatings for specialty applications, including low-VOC, low-odor formulations ideal for occupied areas.

Description	Advantages	Best For / Systems	
<b>Pedestrian Systems</b>			
<b>Vulkem® 350NF/351NF</b>	Two-coat polyurethane pedestrian deck coating system that is designed for water-proofing concrete slabs and protecting occupied areas underneath from water damage. It cures to form a rubber membrane surface that provides a lasting and easy-to-clean coating. Ideal for areas with light and medium pedestrian traffic.	<ul style="list-style-type: none"> <li>• Low VOC's and low odor are ideal for use in neighbor-friendly, inhabited structures</li> <li>• Aggregate-laden top can aid in wear and slip resistance</li> <li>• Fast cure through time allows for use 24 hours after installation</li> <li>• Mildew- and fungus-resistance safeguards concrete surfaces against contaminants</li> <li>• Excellent durability and UV resistance extend the useful life of pedestrian systems</li> <li>• Recoatable and compatible with Tremco sealants, which waterproofing protection</li> </ul>	<ul style="list-style-type: none"> <li>• Plazas</li> <li>• Recreation decks</li> <li>• Balconies</li> <li>• Athletic surfaces</li> </ul>
<b>Vulkem® 350NF/950NF or 951NF</b>	A two-coat composite waterproofing system of tough-curing, liquid polyurethane consisting of Vulkem 350NF as a base coat and 950NF or 951F as a top coat designed to protect concrete slabs and occupied areas underneath from water damage. Protects concrete from the damaging effects of water, deicing salts, chemicals, gasoline, oils, and anti-freeze.	<ul style="list-style-type: none"> <li>• Low VOC's and low odor are ideal for use in neighbor-friendly, inhabited structures</li> <li>• Mildew and fungus resistance safeguards concrete surfaces against contaminants.</li> <li>• Recoatable and compatible with other Tremco sealant and expansion joints, enhancing waterproofing protection with full system compatibility</li> <li>• Once cured forms rubber membrane that is lasting and easy to clean</li> <li>• Excellent durability and UV resistance extend the useful life of pedestrian systems</li> </ul>	<ul style="list-style-type: none"> <li>• Plazas</li> <li>• Recreation decks</li> <li>• Balconies</li> <li>• Athletic surfaces</li> <li>• Mechanical rooms</li> </ul>
<b>Vulkem® 360NF/950NF or 951NF</b>	A two-coat composite waterproofing system of tough-curing, liquid polyurethane consisting of Vulkem 360NF as a base coat and 950NF or 951F as a top coat designed to protect concrete slabs and occupied areas underneath from water damage. Protects concrete from the damaging effects of water, deicing salts, chemicals, gasoline, oils, and anti-freeze.	<ul style="list-style-type: none"> <li>• Low VOC's and low odor are ideal for use in neighbor-friendly, inhabited structures</li> <li>• Mildew and fungus resistance safeguards concrete surfaces against contaminants</li> <li>• Recoatable and compatible with other Tremco sealant and expansion joints, enhancing waterproofing protection with full system compatibility</li> <li>• Once cured forms rubber membrane that is lasting and easy to clean</li> <li>• Excellent durability and UV resistance extend the useful life of pedestrian systems</li> </ul>	<ul style="list-style-type: none"> <li>• Plazas</li> <li>• Recreation decks</li> <li>• Balconies</li> <li>• Athletic surfaces</li> <li>• Mechanical rooms</li> </ul>
<b>Vulkem® EWS Pedestrian</b>	A waterproof traffic deck coating system that utilizes polyurethane-methacrylate (PUMA) technology, which is designed to protect concrete slabs and occupied areas underneath from water damage. PUMA technology delivers extreme durability while maintaining its crack-bridging characteristics, eliminating the need for reinforcing fabric. Protects against chloride, deicing salts, chemicals, gasoline, oils, and anti-freeze. Ideal for stadiums, balconies, and pool decks.	<ul style="list-style-type: none"> <li>• Can be applied in temperatures as low as 14° F (-10° C), extending application windows</li> <li>• Open to foot traffic within one hour after application, providing quick return to service</li> <li>• Low VOC to help improve surrounding air quality</li> <li>• Minimal downtime (approximately 30 to 45 min) between application coats, ideal for condensed construction cycles, even in cold temperatures</li> <li>• Unique chemistry – bonds to itself to allow easy repairs</li> </ul>	<ul style="list-style-type: none"> <li>• Stadiums</li> <li>• Balconies</li> <li>• Pool decks</li> <li>• Pedestrian walkways</li> <li>• Mechanical rooms</li> </ul>
<b>Vehicular Systems</b>			
<b>Vulkem® 350NF/346/346</b>	A modified polyurethane three-coat traffic deck coating system designed for water-proofing concrete slabs and protecting occupied areas underneath from water damage. A fast cure-through that allows for return to use 72 hours after application. Protects concrete from the damaging effects of water, deicing salts, chemicals, gasoline, oils, and anti-freeze while also providing tenacious adhesion, extreme impact and abrasion resistance, and remarkable chemical stability.	<ul style="list-style-type: none"> <li>• UV, impact, abrasion, and chemical resistant helps to extend service life of coating system</li> <li>• Mildew and fungus resistance safeguards surfaces against environmental contaminants</li> <li>• Recoatable and compatible with other Tremco sealants and expansion joints, which enhance waterproofing protection</li> </ul>	<ul style="list-style-type: none"> <li>• Parking Decks</li> </ul>
<b>Vulkem® 350NF-F/951NF</b>	A modified polyurethane three-coat traffic deck coating system designed for water-proofing concrete slabs and protecting occupied areas underneath from water damage. Protects concrete from the damaging effects of water, deicing salts, chemicals, gasoline, oils, and anti-freeze. Also provides tenacious adhesion, extreme impact and abrasion resistance, and remarkable chemical stability.	<ul style="list-style-type: none"> <li>• System component elastomeric properties helps bridge shrinkage cracks</li> <li>• Low VOC's and low odor are ideal for use in neighbor-friendly, inhabited structures</li> <li>• Mildew and fungus resistance safeguards against environmental contaminants.</li> <li>• Excellent durability and UV resistance extends the life of vehicular systems.</li> <li>• Recoatable and compatible with other Tremco sealant and expansion joints, enhancing waterproofing protection with full system compatibility</li> </ul>	<ul style="list-style-type: none"> <li>• Parking decks</li> <li>• Concrete ramps</li> <li>• Athletic surfaces</li> </ul>
<b>Vulkem® 350NF/Epoxy WC/346</b>	A three-coat polyurethane traffic deck coating system designed for waterproofing concrete slabs and protecting occupied areas underneath from water damage. Featuring an epoxy wear coat provides enhanced durability vs. a urethane only system.	<ul style="list-style-type: none"> <li>• Two-part epoxy wear coat provides enhanced durability vs. urethane only systems</li> <li>• Extended service life and warranties compared to urethane only systems</li> <li>• Resistant to chemicals, salts, mildew, fungus, and other environmental contaminants</li> <li>• Superior aggregate retention</li> <li>• Low VOC's and low odor are ideal for use in neighbor-friendly, inhabited structures</li> </ul>	<ul style="list-style-type: none"> <li>• High-wear turning and drive lanes</li> <li>• Helical ramps</li> <li>• Stadium/plaza decks</li> <li>• Parking decks</li> <li>• Ticket splitter</li> </ul>
<b>Vulkem® 360NF/950NF/951NF</b>	A modified polyurethane three-coat traffic deck coating system designed for waterproofing concrete slabs and protecting occupied areas underneath from water damage. It is also mildew and fungus resistant and provides excellent durability and UV resistance.	<ul style="list-style-type: none"> <li>• Low VOC's and low odor are ideal for use in neighbor-friendly, inhabited structures</li> <li>• Mildew-and-fungus-resistance safeguards against environmental contaminants.</li> <li>• Excellent durability and UV resistance extends the life of vehicular systems</li> <li>• Recoatable and compatible with other Tremco sealant and expansion joints, enhancing waterproofing protection with full system compatibility</li> <li>• Fast cure time allows for use 24 hours after installation</li> </ul>	<ul style="list-style-type: none"> <li>• Parking decks</li> <li>• Concrete ramps</li> </ul>
<b>Vulkem® EWS Vehicular</b>	A waterproof traffic deck coating system that utilizes polyurethane-methacrylate (PUMA) technology, which is designed to protect concrete slabs and occupied areas underneath from water damage. PUMA technology delivers extreme durability while maintaining its crack-bridging characteristics. Designed to have tenacious adhesion and extreme abrasion resistance, it allows for quick curing and can be driven on one hour after application. This system will protect the concrete from the damaging effects of chloride, deicing salts, chemicals, gasoline, oils, and anti-freeze.	<ul style="list-style-type: none"> <li>• Minimal downtime between application coats, even in cold temperatures</li> <li>• Open to vehicular traffic within one hour after application, providing quick return to service</li> <li>• Polyurethane-methacrylate (PUMA) technology delivers extreme durability, decorative functionality, and crack bridging capabilities</li> <li>• Can be applied in temperatures as low as 14° F (-10° C), extending the season for applications</li> </ul>	<ul style="list-style-type: none"> <li>• Parking decks</li> <li>• Ticket splitters</li> <li>• High-wear turning and drive lanes</li> <li>• Helical ramps</li> </ul>
<b>Heavy Duty System</b>			
<b>Vulkem® EWS Heavy Duty</b>	A heavy-duty waterproof traffic deck coating system that utilizes polyurethane-methacrylate (PUMA) technology that is designed to have tenacious adhesion and extreme abrasion resistance, it allows for quick curing and can be walked in one hour after application. Ideal for waterproofing concrete slabs and protecting areas underneath from water damage and the damaging effects of water, deicing salts, chemicals, gasoline, oils, and anti-freeze.	<ul style="list-style-type: none"> <li>• Minimal downtime (approximately 30 to 45 min) between application coats, ideal for condensed construction cycles, even in cold temperatures</li> <li>• Open to vehicular traffic within one hour after application, providing quick return to service</li> <li>• PUMA technology delivers extreme durability, decorative functionality, and crack bridging capabilities</li> <li>• Can be applied in temperatures as low as 14° F (-10° C), extending the season for applications</li> </ul>	<ul style="list-style-type: none"> <li>• Parking structures requiring snowplow resistance</li> <li>• Loading docks</li> <li>• Dumpster areas</li> </ul>

NF = Neighbor-Friendly SL = Self-Leveling R = Roller





A leading line of USDA/FDA-compliant, Hazard Analysis and Critical Control Point (HACCP) International certified, antimicrobial-treated cementitious urethane flooring systems for use in a wide variety of demanding applications, especially those where a high standard of hygiene is required.

Description	Advantages	Best For / Systems
<b>Urethane Cement Systems</b>		
<b>TREMfloor™ UC SL</b> A pigmented seamless self-leveling urethane cement flooring system with a smooth matte finish.	<ul style="list-style-type: none"> <li>Broadcast System</li> <li>Chemical Resistance</li> <li>Thermal Resistance up to 180°F Slurry nature allows for ease of application and broader coverage rate.</li> </ul>	<ul style="list-style-type: none"> <li>Fast Return to Service-Cures in under 24 hours.</li> <li>Contains Polygiene® Antimicrobial</li> <li>Breathable/Moisture Vapor Tolerant</li> </ul>
<b>TREMfloor™ UC MF</b> A pigmented seamless medium-duty finish urethane cement flooring system with a smooth matte finish.	<ul style="list-style-type: none"> <li>Abrasion Resistance</li> <li>Chemical Resistance</li> <li>Thermal Resistance up to 180°F</li> </ul>	<ul style="list-style-type: none"> <li>Fast Return to Service-Cures in under 24 hours.</li> <li>Contains Polygiene® Antimicrobial</li> <li>Breathable/Moisture Vapor Tolerant</li> </ul>
<b>TREMfloor™ UC SR</b> A pigmented seamless heavy-duty skid resistant urethane cement flooring system with a textured matte finish.	<ul style="list-style-type: none"> <li>Larger aggregate provides great anti-slip qualities.</li> <li>Can be broadcasted for extra slip resistance.</li> <li>Abrasion Resistance</li> <li>Chemical Resistance</li> </ul>	<ul style="list-style-type: none"> <li>Thermal Resistance up to 180°F</li> <li>Fast Return to Service-Cures in under 24 hours.</li> <li>Contains Polygiene® Antimicrobial</li> <li>Breathable/Moisture Vapor Tolerant</li> </ul>
<b>TREMfloor™ UC HF</b> A trowel-applied pigmented seamless heavy-duty finish urethane cement flooring system.	<ul style="list-style-type: none"> <li>Larger aggregate provides great anti-slip qualities.</li> <li>Abrasion Resistance</li> <li>Chemical Resistance</li> <li>Thermal Resistance up to 200°F</li> </ul>	<ul style="list-style-type: none"> <li>Fast Return to Service-Cures in under 24 hours.</li> <li>HACCP International Certified</li> <li>Contains Polygiene® Antimicrobial</li> <li>Breathable/Moisture Vapor Tolerant</li> </ul>
<b>TREMfloor™ UC RT</b> A seamless heavy-duty, pigmented, rake and trowel applied urethane cement flooring system with a textured matte finish.	<ul style="list-style-type: none"> <li>Heavy-duty mortar supports high impact resistance.</li> <li>Chemical Resistance</li> <li>Thermal Resistance up to 200°F</li> </ul>	<ul style="list-style-type: none"> <li>Fast Return to Service-Cures in under 24 hours.</li> <li>Contains Polygiene® Antimicrobial</li> <li>Breathable/Moisture Vapor Tolerant</li> </ul>
<b>Sealers</b>		
<b>TREMfloor™ UC SR Sealer</b> A pigmented urethane cement sealer with a high-gloss finish.	<ul style="list-style-type: none"> <li>Cost-effective</li> <li>Abrasion Resistant</li> <li>Chemical Resistant</li> </ul>	<ul style="list-style-type: none"> <li>Improves durability and provides protection.</li> <li>Fast Return to Service-Cures in under 24 hours.</li> <li>Contains Polygiene® Antimicrobial</li> </ul>
<b>TREMfloor™ UC FC</b> A pigmented urethane cement sealer with a matte finish that can double as a primer for urethane cement systems.	<ul style="list-style-type: none"> <li>Improves durability and provides protection.</li> <li>Abrasion Resistant</li> <li>Chemical Resistant</li> <li>Fast Return to Service-Cures in under 24 hours.</li> </ul>	<ul style="list-style-type: none"> <li>HACCP International Certified</li> <li>Contains Polygiene® Antimicrobial</li> <li>Can be used as a primer in cases of highly porous substrates or highly trafficked areas.</li> </ul>
<b>TREMfloor™ UC FCUV</b> A pigmented UV stable, urethane cement sealer with a glossy finish.	<ul style="list-style-type: none"> <li>UV-Resistant/Protects against discoloration.</li> <li>Improves durability and provides protection.</li> <li>Abrasion Resistant</li> </ul>	<ul style="list-style-type: none"> <li>Fast Return to Service-Cures in under 24 hours.</li> <li>Contains Polygiene® Antimicrobial</li> <li>Chemical Resistant</li> </ul>
<b>TREMCO Sealer 200</b> A medium-duty, Aliphatic Polyurethane topcoat with a clear gloss finish.	<ul style="list-style-type: none"> <li>Longer Pot-Life</li> <li>Application Friendly</li> <li>Good Coverage Rate</li> <li>UV-Stable</li> <li>Provides protection and durability.</li> </ul>	<ul style="list-style-type: none"> <li>Stain Resistance</li> <li>Locks in decorative aggregates</li> <li>Chemical Resistance</li> <li>Abrasion Resistance</li> <li>Easy to Clean</li> </ul>
<b>TREMCO Sealer 300</b> A heavy-duty, high solids, UV-Stable Polyaspartic topcoat with a clear gloss finish.	<ul style="list-style-type: none"> <li>Quick Curing</li> <li>Low VOC</li> <li>UV-Stable</li> <li>Fast Return to Service</li> </ul>	<ul style="list-style-type: none"> <li>Chemical Resistance</li> <li>Easy to Clean</li> <li>Impact Resistance</li> <li>Stain Resistance</li> </ul>
		<ul style="list-style-type: none"> <li>Can be applied to any TREMfloor UC System.</li> <li>Used on broadcasted systems.</li> </ul>
		<ul style="list-style-type: none"> <li>Can be applied to any TREMfloor UC System.</li> <li>Used on broadcasted systems.</li> </ul>
		<ul style="list-style-type: none"> <li>Apply whenever a system will be exposed to UV rays.</li> <li>Can be applied to any TREMfloor UC System.</li> <li>Used on broadcasted systems.</li> </ul>
		<ul style="list-style-type: none"> <li>TREMfloor Urethane Cement Systems</li> <li>Direct to Concrete</li> <li>Ideal for Industrial/manufacturing areas, commercial spaces, Airplane hangars, maintenance areas, food and beverage areas.</li> </ul>
		<ul style="list-style-type: none"> <li>Warehouses</li> <li>Maintenance areas</li> <li>Airplane hangars</li> <li>Food &amp; beverage</li> </ul>



High-strength borate-treated Laminated Strand Lumber (LSL) with high elasticity, offering protection against moisture, insects, mold and mildew. Prebuck engineered framing will not cup, twist or warp over time and can be cut to custom design specifications.

Description	Advantages	Best For / Systems
<b>Engineered Framing</b>		
<b>Window &amp; Door Buck</b> Window and Door Buck offers the contractor, owner and design community an engineered solution for punched openings. Produced with 1-1/2" (38 mm) thick, treated Laminated Strand Lumber (LSL), the Prebuck Window and Door Buck assures that the rough frame of the opening provides stable support for glazing and finish components. Made with materials that allow direct contact with concrete, a cast in place version integrates a dual keyway design to assure a secure interface from concrete to finishes.	<ul style="list-style-type: none"> <li>High strength LSL material</li> <li>High modulus of elasticity</li> <li>Borate treatment offering protection against moisture, insects, mold and mildew</li> <li>Healthy and sustainable solution</li> </ul>	<ul style="list-style-type: none"> <li>Custom manufactured to width</li> <li>Non-corrosive to metals</li> <li>Will not cup, twist, warp or curl</li> <li>No chemical off-gassing</li> <li>Solid anchoring surface</li> <li>Green Building Certified</li> </ul>
<b>Sill Plate</b> Sill Plate offers the contractor, owner and design community an engineered solution for terminating the top of a concrete wall. Produced with 1-1/2" (38 mm) thick, treated Laminated Strand Lumber (LSL), the Prebuck Sill Plate assures that this top of wall plate provides stable support for a floor, wall, or roof attachment. Made with materials that allow direct contact with concrete and integrates a countersunk anchor opening providing secure anchor bolt attachment to concrete walls.	<ul style="list-style-type: none"> <li>High strength LSL material</li> <li>High modulus of elasticity</li> <li>Borate treatment offering protection against moisture, insects, mold and mildew</li> <li>Healthy and sustainable solution</li> </ul>	<ul style="list-style-type: none"> <li>Custom manufactured to width</li> <li>Non-corrosive to metals</li> <li>Will not cup, twist, warp or curl</li> <li>No chemical off-gassing</li> <li>Solid anchoring surface</li> <li>Green Building Certified</li> </ul>
<b>Parapet Cap</b> Parapet Cap Framing offers the contractor, owner and design community an engineered solution for terminating parapet wall assemblies of their structure. This parapet "nailer" will interface with framing, air barriers, roofing, and finish materials (especially metal coping). Prebuck is produced with 1-1/2" (38 mm) thick, treated Laminated Strand Lumber (LSL) to assure that the parapet cap provides stable support for your coping and flashing components. Prebuck is customized to design and is effective in reducing labor and staging costs.	<ul style="list-style-type: none"> <li>High strength LSL material</li> <li>High modulus of elasticity</li> <li>Borate treatment offering protection against moisture, insects, mold and mildew</li> <li>Healthy and sustainable solution</li> </ul>	<ul style="list-style-type: none"> <li>Non-corrosive to metals</li> <li>Will not cup, twist, warp or curl</li> <li>No chemical off-gassing</li> <li>Solid anchoring surface</li> <li>Custom manufactured to width</li> <li>Green Building Certified</li> </ul>
		<ul style="list-style-type: none"> <li>Insulated Concrete Form (ICF) walls</li> <li>Tilt-wall</li> <li>Precast concrete walls</li> <li>Structural steel buildings</li> <li>Light gauge metal stud walls</li> <li>Panelized wall systems</li> </ul>
		<ul style="list-style-type: none"> <li>Tilt-wall</li> <li>Precast concrete walls</li> <li>Masonry block walls</li> <li>Insulated Concrete Form (ICF) walls</li> </ul>
		<ul style="list-style-type: none"> <li>Tilt-wall</li> <li>Precast concrete walls</li> <li>Masonry block walls</li> <li>Insulated Concrete Form (ICF) walls</li> <li>Structural steel buildings</li> <li>Light gauge metal stud walls</li> <li>Panelized wall systems</li> <li>Wood framed walls</li> </ul>



A full line of innovative products delivering an affordable, eco-friendly building solution that provides faster building speeds, superior energy efficiency, disaster resilience, and sound and fire-resistance.

Description	Advantages	Best For / Systems
<b>ICF Series</b>		
<b>Assembled Forms</b>	<ul style="list-style-type: none"> <li>Full line of assembled ICF forms manufactured with industry leading technologies, including DURALOK Technology®, DURAFOLD Technology®, DURAMAX Technology®, and the 4-Way Reversible system. Forms include Standard form, 90° form, 45° form, Taper Top form, Brick Ledge form, &amp; Custom Cut Radius form.</li> <li>Fully Assembled Standard Form Sizes from 4" - 12" (102 mm - 305 mm)</li> <li>Industry leading technologies</li> <li>Fully-Assembled to eliminate on-site assembly</li> </ul>	<ul style="list-style-type: none"> <li>Below Grade Foundations</li> <li>Above Grade Walls</li> <li>Multi-Story Buildings</li> <li>Crawl Space Walls</li> <li>Retaining Walls</li> <li>Pools</li> <li>Retail</li> <li>Apartments and Condos</li> <li>Hospitality</li> <li>Institutional</li> <li>Building of Worship</li> <li>Industrial</li> <li>Agricultural</li> <li>Educational</li> <li>Grade Beams</li> </ul>
<b>Unassembled Forms</b>	<ul style="list-style-type: none"> <li>Full line of unassembled ICF panels to allow for the assembly of numerous form combinations to suit any unique jobsite requirements. These unassembled panels include Standard panel, Taper Top panel, Brick Ledge panel, and the Optimizer form panels.</li> <li>Assembly of wide width walls to suit unique building requirements</li> <li>Industry leading technologies</li> </ul>	<ul style="list-style-type: none"> <li>Unique building applications and requirements</li> </ul>
<b>ICF Accessories</b>	<ul style="list-style-type: none"> <li>Wide range of accessory products for a variety of ICF applications. Accessories include ICF floor hanger systems, T-Form Support brackets, Vertical Joint Clips, variety of tapes, Low Expansion Spray Foam, and much more to complement the installation of the ICF forms.</li> <li>Accessory products to support the installation of the ICF forms</li> </ul>	<ul style="list-style-type: none"> <li>Used to complement the ICF Series form during assembly and wall construction</li> </ul>
<b>Alignment System</b>	<ul style="list-style-type: none"> <li>A multi-purpose set of components that ensures, during the ICF construction process, the ICF forming system is properly supported during concrete placement while also providing a safe working platform for the installer.</li> <li>Variety of options to suit any wall height</li> <li>Different system options to suit user preference</li> </ul>	<ul style="list-style-type: none"> <li>Used to support the ICF wall during the construction process</li> <li>Provides a walk platform for concrete placement</li> </ul>
<b>One Series</b>		
<b>One Series Form</b>	<ul style="list-style-type: none"> <li>Industry's first multi-link form offering the ability to reduce labor by eliminating the need to strip the EPS foam for elevator shafts, stairwells, and other areas that required a non-combustible finish.</li> <li>Industry's first multi-link form</li> <li>Reduced Labor</li> <li>Design Versatility</li> <li>Industry leading technologies</li> </ul>	<ul style="list-style-type: none"> <li>Elevator Shafts</li> <li>Stairwells</li> </ul>
<b>One Series Accessories</b>	<ul style="list-style-type: none"> <li>Collection of accessory products to assist in the assembly and construction of the One Series Wall. Accessories include a metal jig, conner connector, formply inserts, and many more.</li> <li>Accessory products to support the installation of One Series forms</li> </ul>	<ul style="list-style-type: none"> <li>Used to complement the One Series form during assembly and wall construction</li> </ul>
<b>Plus Series</b>		
<b>XR35</b>	<ul style="list-style-type: none"> <li>The XR35 form is manufactured with 4" (100 mm) thick EPS foam on both side of the fully assembled form, providing a significant increase in insulation performance.</li> <li>4" (102 mm) thick EPS Foam Panel</li> <li>Available in 6" (152 mm) and 8" (203 mm) Concrete Core</li> <li>Industry-leading technologies</li> </ul>	<ul style="list-style-type: none"> <li>Below Grade Foundations</li> <li>Above Grade Walls</li> <li>Multi-Story Buildings</li> <li>Crawl Space Walls</li> <li>Retaining Walls</li> <li>Pools</li> <li>Apartments and Condos</li> <li>Retail</li> <li>Hospitality</li> <li>Institutional</li> <li>Building of Worship</li> <li>Industrial</li> <li>Agricultural</li> <li>Educational</li> <li>Grade Beams</li> </ul>
<b>Plus Series Form</b>	<ul style="list-style-type: none"> <li>Plus Series forms address the industry demand for increased exterior insulation options by providing thickened EPS panels on one side of Nudura assembled ICF forms. The additional foam thicknesses range from 1" - 6" (25 mm - 152 mm)</li> <li>Standard form sizes from 4" - 12" (102 mm - 305 mm)</li> <li>Additional insulation thickness options from 1" - 6" (25 mm - 152 mm)</li> <li>Industry-leading technologies</li> </ul>	
<b>R-Value Inserts</b>	<ul style="list-style-type: none"> <li>Engineered to integrate into any Nudura Form unit, allowing for increases R-values, while not interfering with the industry leading technologies of the Nudura ICF forms. R-Value Inserts are available in standard thicknesses ranging from 1" - 6" (25 mm - 152 mm) and are easily slid into the dovetails on the interior face of the Nudura ICF form.</li> <li>Additional insulation thickness options from 1" - 6" (25 mm - 152 mm)</li> <li>Do not interfere with Nudura Industry leading technologies</li> </ul>	
<b>Integrated Series</b>		
<b>HYDROFOAM</b>	<ul style="list-style-type: none"> <li>Radiant floor insulation for residential and commercial construction applications that increases the comfort and energy efficiency. HYDROFOAM is a 4' x 4' (1.2 m x 1.2 m) individually molded board that maximizes radiant floor heating by ensuring the heat is dispersed evenly throughout the entire floor area, providing building occupants with a comfortable living and working environment. HYDROFOAM offers installers a lightweight high density Expanded Polystyrene (EPS) that increases installation speeds, and is easy to cut to meet any angle or radius required.</li> <li>Quick and easy installation</li> <li>Multi-directional anchor system eliminates the need to tie the PEX tubing</li> <li>Radiant heat pipe is easily stepped into place in any direction required.</li> <li>Available in various thicknesses</li> <li>100% recyclable</li> <li>No CFCs or HCFCs</li> <li>Inorganic and rot-proof material</li> <li>Resistant to water and moisture</li> <li>Overlapping interlock on all four sides</li> </ul>	<ul style="list-style-type: none"> <li>Residential applications including: <ul style="list-style-type: none"> <li>Basement Slab</li> <li>Slab on grade</li> <li>Garage slab (light-weight cars and trucks)</li> </ul> </li> </ul>
<b>HOMEGA</b>	<ul style="list-style-type: none"> <li>HOMEGA is a 4' x 8' (1219 mm x 2438 mm) individually molded insulation panel with three integrated furring strips at 16" (406 mm) on center and shipped on all four sides. It is a unique, patented, 2-in-1 system offering superior performance. HOMEGA can be used to insulate foundation walls and floors, interior and exterior walls and ceilings.</li> <li>Quick easy installation</li> <li>Overlapping interlock on all four sides</li> <li>Permanent Insulation Value</li> <li>2-in-1 product</li> <li>100% recyclable</li> <li>No CFCs or HCFCs</li> <li>Inorganic and rot-proof material</li> <li>Resistant to water and moisture</li> </ul>	<ul style="list-style-type: none"> <li>Concrete Foundation walls</li> <li>Interior or Exterior of block walls</li> <li>Residential Ceiling insulation applications</li> </ul>

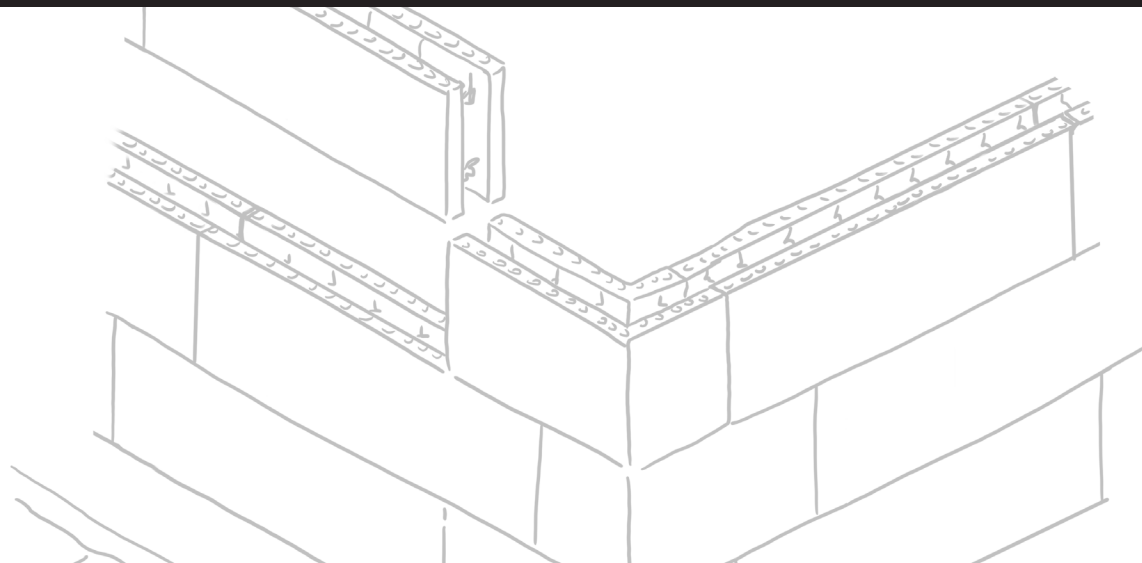

Willseal's industry-leading pre-compressed, silicone-impregnated foam expansion joint systems provide a strong bond to surrounding substrates, while providing superior durability and excellent movement capabilities.

Description	Advantages	Best For / Systems
<b>Pre-Compressed Foam Joints</b>		
<b>Willseal® 250</b>	A pre-compressed, self-expanding open micro-cell polyurethane foam impregnated with a hydrophobic, acrylic polymer sealing compound coated with a factory-applied silicone sealant. It is designed to provide a watertight, dust-proof, airtight, noise-reducing, thermally insulating, and UV stable primary seal.	<ul style="list-style-type: none"> <li>Allows for up to 100% (±50%) movement</li> <li>Accommodates rapid rates of movement</li> <li>Utilizes non-invasive anchoring</li> <li>Monolithic construction - no unbonded laminations</li> </ul>
<b>Willseal® 250R</b>	A patent-protected expansion joint system which combines the performance and reliability of Willseal 250 with reinforcing members beneath the sealant face to support higher point loads. Consists of 3 construction elements: <ol style="list-style-type: none"> <li>Impregnated Foam Core: pre-compressed, open micro-cell polyurethane foam</li> <li>Sealant Face: a factory applied coating of traffic-rated silicone</li> <li>Reinforcing Members: factory integrated reinforcements beneath sealant face</li> </ol>	<ul style="list-style-type: none"> <li>Allows for up to 100% (±50%) movement</li> <li>Maximum seal in structures with shear and rapid movement</li> <li>Reinforced members provide stability across the joint under traffic</li> <li>Surface load transfer</li> <li>Utilizes non-invasive anchoring</li> <li>Excellent compression recovery</li> </ul>
<b>Willseal® 600</b>	A pre-compressed, self-expanding foam joint seal, engineered to perform as a highly flexible, weather-tight, <b>primary seal</b> in vertical exterior applications. The high-density polyurethane foam is impregnated with a modified flame retardant, hydrophobic, UV stable acrylic resin and treated with a pressure-sensitive adhesive on one side for ease of installation.	<ul style="list-style-type: none"> <li>Remains permanently flexible</li> <li>No mixing, masking, or priming required</li> <li>Easy soap-and-water cleanup: no solvents, no cartridges, no pails</li> <li>Compatible with most porous or sensitive substrates</li> <li>Depth of seal can be changed to increase R-value and sound properties</li> <li>Low volatility</li> </ul>
<b>Willseal® 600S</b>	A pre-compressed, self-expanding foam joint seal, engineered to perform as a highly flexible, <b>secondary seal</b> in vertical applications. Specifically designed to provide the ideal foundation for a large variety of wet sealants, such as silicone, polyurethane, polysulfide, and acrylic. Unlike conventional wet sealant and backer rod methods, Willseal 600S is not susceptible to breakdowns caused by excessive or rapid joint movements, thus protecting structures against rain, wind, dust, and sound.	<ul style="list-style-type: none"> <li>Remains permanently flexible</li> <li>Seals gaps or seams as small as 1/8"</li> <li>Impregnated with a modified flame retardant</li> <li>Can be applied in various weather and temperature conditions</li> <li>Easy soap-and-water cleanup: no solvents, no cartridges, no pails</li> <li>Depth of seal can be changed to increase R-value and sound properties</li> <li>Low volatility</li> <li>Vapor permeable</li> </ul>
<b>Willseal® FR-V</b>	A fire-rated, watertight, UV stable foam, sound-attenuating expansion joint with a pre-cured, factory-applied sealant applied to the face. Comprised of a fire-retardant impregnated foam designed to be used in vertical expansion joints by itself, but it can also be used behind any other expansion joint cover, plate or filler where joint depth allows.	<ul style="list-style-type: none"> <li>Allows for up to 100% (±50%) movement</li> <li>Accommodates rapid rates of joint movement</li> <li>2 &amp; 3 hour fire rated seal when installed with a tested firestop system</li> <li>Prevents toxic gases and fumes from passing thru the joint</li> </ul>
<b>Willseal® FR SAF-V</b>	A fire-rated, watertight, UV stable foam, sound-attenuating expansion joint with a pre-cured, factory-applied pick-resistant sealant applied to the face. Comprised of a fire-retardant impregnated foam designed to be used in vertical expansion joints by itself, without the addition of an intumescent sealant on the foam surface.	<ul style="list-style-type: none"> <li>Allows for up to 100% (±50%)</li> <li>2- &amp; 3-hour fire rated seal when installed with a tested firestop system</li> <li>Prevents toxic gases and fumes from passing thru the joint</li> <li>Sealant hardens to 50 ± 10 durometer</li> <li>Meets UL94V0, Cal 117 for self-extinguishing</li> </ul>
<b>Willseal® FR-H</b>	A fire-rated, watertight, UV stable foam, sound-attenuating expansion joint with a pre-cured, traffic-rated factory-applied sealant applied to the face. Comprised of a fire-retardant impregnated foam designed to be used in horizontal expansion joints by itself, but it can also be used behind any other expansion joint cover, plate or filler where joint depth allows.	<ul style="list-style-type: none"> <li>Coated with traffic-grade sealant</li> <li>Allows for up to 100% (±50%) movement</li> <li>2- &amp; 3- hour fire rated seal when installed in accordance with a UL tested firestop system</li> <li>Prevents toxic gases and fumes from passing through the joint</li> </ul>
<b>Willseal® Seismic</b>	A pre-compressed, self-expanding, open micro-cell polyurethane foam impregnated with a hydrophobic, acrylic polymer and coated with a factory-applied silicone sealant. It is designed to provide a watertight, dust-proof, noise-reducing, thermally insulating, and UV stable primary seal that does not require invasive anchoring for installation.	<ul style="list-style-type: none"> <li>Allows for up to 100% (±50%) movement</li> <li>One-step primary sealant for areas where color matching is important</li> <li>Puncture-resistant, elastomeric coating on exterior surface, can be factory colored to match most construction substrates or sealants</li> </ul>
<b>Willseal® Seismic HS</b>	A pre-compressed, self-expanding open micro-cell polyurethane foam impregnated with a hydrophobic, acrylic polymer and coated with a factory-applied silicone sealant. Designed to provide a watertight, dust-proof, noise-reducing, thermally insulating, and UV stable primary seal.	<ul style="list-style-type: none"> <li>Allows for up to 100% (±50%) movement</li> <li>Puncture-resistant, elastomeric coating on exterior surface, can be factory colored to match most construction substrates or sealants</li> <li>Used in joints up to 4" (10.16cm) wide</li> </ul>
<b>Willseal® Seismic SAF V</b>	A pre-compressed, self-expanding open microcell polyurethane foam impregnated with a hydrophobic, acrylic polymer and coated with a factory-applied pick resistant sealant. It is designed to provide a watertight, dust-proof, noise-reducing, thermally insulating, and UV stable primary seal for areas that can be easily damaged or vandalized in institutional or other public buildings.	<ul style="list-style-type: none"> <li>Allows for up to 100% (±50%) movement</li> <li>Tamper-resistant</li> <li>Sealant hardens to 50 ± 10 Shore A durometer</li> <li>Meets UL94V0, Cal 117 for self-extinguishing</li> </ul>
<b>Willseal® Acousti-Seal</b>	A compressible type joint sealant for both static vertical, and horizontal joints on a vertical plane, for use in applications where interior sound control is needed. Not intended for movement joints. Comprised of a fire resistant acrylic impregnated polyurethane foam with factory coated silicone sides, that can be color matched to blend in with the surrounding and for a better aesthetically pleasing appearance.	<ul style="list-style-type: none"> <li>Permanently flexible seal that is easy to install, does not require invasive mechanical anchoring</li> <li>Sides can be coated with different colors to match walls</li> <li>1, 2, 3, or 4 silicone coated sides available</li> <li>Reduces sound transmission from room to room</li> </ul>
<b>Closed-Cell Foam Joints</b>		
<b>Willseal® Coreseal</b>	A lightweight, preformed closed-cell ethylene vinyl acetate (EVA) copolymer foam. It is designed to provide a watertight, dustproof, airtight, noise-reducing, thermally insulating and UV stable primary seal that does not require invasive anchoring for installation.	<ul style="list-style-type: none"> <li>Allows for up to 50% (±25%) movement</li> <li>Impermeable to water, provides a watertight seal</li> <li>Monolithic construction for standard sizes - will not delaminate</li> <li>UV and Chemical resistant</li> </ul>
<b>Willseal® Color Coreseal V</b>	A lightweight, preformed closed-cell ethylene vinyl acetate (EVA) copolymer foam with a pre-cured, factory-applied sealant. It is designed to provide a watertight, dust-proof, airtight, noise-reducing, thermally insulating and UV stable primary seal that does not require invasive anchoring for installation.	<ul style="list-style-type: none"> <li>Allows for up to 50% (±25%) movement</li> <li>Does not rely on the silicone coating or field applied bead to provide seal</li> <li>Used for joints up to 10" wide</li> <li>Colored sealant skin for chemical and puncture resistance</li> </ul>
<b>Willseal® Color Coreseal H</b>	A lightweight, preformed closed-cell ethylene vinyl acetate (EVA) copolymer foam with a pre-cured, traffic-rated factory-applied sealant. It is designed to provide a watertight, dust-proof, airtight, noise-reducing, thermally insulating and UV stable primary seal that does not require invasive anchoring for installation.	<ul style="list-style-type: none"> <li>Allows for up to 50% (±25%) movement</li> <li>Impermeable to water, provides a watertight seal</li> <li>Does not rely on the silicone coating or field applied bead to provide seal</li> <li>Used for joints up to 4" wide</li> <li>Colored sealant skin for chemical and puncture resistance</li> </ul>
<b>Willseal® Color Coreseal SAF V</b>	A lightweight, preformed closed-cell ethylene vinyl acetate (EVA) copolymer foam with a pre-cured, factory-applied pick-resistant sealant. It is designed to provide a watertight, dust-proof, airtight, noise-reducing, thermally insulating and UV stable primary seal for areas that can be easily damaged or vandalized in institutional or other public buildings.	<ul style="list-style-type: none"> <li>Allows for up to 50% (±25%) movement</li> <li>Impermeable to water, provides a watertight pick resistant seal.</li> <li>Does not rely on the sealant coating or field applied bead to provide seal</li> <li>Used for joints up to 10" wide</li> </ul>

High-performance urethane, silicone and specialty sealants designed to seal the entire building enclosure while meeting the demanding requirements and special needs of architects, engineers, contractors and building owners.

Description	Advantages	Best For / Systems
<b>Single-Component Urethane Sealants</b>		
<b>Dymonic® 100</b> A durable, flexible polyurethane sealant that offers excellent performance in moving joints and exhibits tenacious adhesion once fully cured. Formulated with an innovative polymer technology, Dymonic 100 is paintable, highly versatile, has a unique capability to adhere to damp or green concrete and will not out gas.	<ul style="list-style-type: none"> <li>Significantly reduces dirt attraction with a skin time of 2 hr and tack-free time of 6-8 hr</li> <li>Movement capability of +100/-50%</li> <li>Low VOC</li> <li>Non-sag, single-component polyurethane sealant</li> </ul>	<ul style="list-style-type: none"> <li>UV stable, will not crack, craze, or yellow</li> <li>Suitable for water immersion and will not out-gas</li> <li>Can adhere to damp or green concrete</li> <li>Can be painted to achieve desired appearance</li> <li>Jet fuel-resistant</li> </ul>
<b>Vulkem® 116<sup>(1)</sup></b> An excellent general-purpose, durable, gun-grade polyurethane sealant for exterior use. Vulkem 116 has a 30-year history of superior primerless adhesion to porous substrates, making it the optimal choice for sealing expansion joints in commercial construction.	<ul style="list-style-type: none"> <li>Rated for ± 25% movement capability</li> <li>Suitable for certain water immersion applications</li> <li>Textured, single-component, moisture-curing polyurethane sealant that offers excellent performance dynamic joints</li> </ul>	<ul style="list-style-type: none"> <li>Expansion and control joints</li> <li>Precast concrete panel joints</li> <li>Perimeter caulking</li> <li>Aluminum, masonry, and vinyl siding</li> <li>Fluid applied flashing in rough opening perimeters</li> </ul>
<b>Vulkem® 45SSL<sup>(2)</sup></b> A highly versatile, semi-self-leveling, low-modulus, polyurethane sealant with exceptional primerless adhesion and movement capability. Formulated for use in horizontal expansion joints with the unique ability to adhere to damp or green concrete.	<ul style="list-style-type: none"> <li>Traffic rated, moisture-curing polyurethane sealant</li> <li>Suitable for continuous immersion</li> <li>Provides exceptional wear and tear resistance required in high traffic areas</li> <li>Jet fuel-resistant</li> </ul>	<ul style="list-style-type: none"> <li>Can adhere to damp or green concrete</li> <li>Great UV resistance and will not out gas</li> <li>Pourable, semi-self-leveling polyurethane sealant</li> </ul>
<b>Hybrid Sealants</b>		
<b>Dymonic® FC</b> A durable, flexible hybrid sealant that offers excellent performance and exhibits tenacious adhesion in moving joints. Formulated with proprietary silane end-capped polymer technology, Dymonic FC is fast-curing to reduce dirt attraction, while maintaining excellent movement capability.	<ul style="list-style-type: none"> <li>Exceptional movement capability of ± 35%</li> <li>Will not green crack due to early movement</li> <li>Low modulus formula withstands joint movement</li> <li>Adheres to a variety of substrates for versatile use</li> </ul>	<ul style="list-style-type: none"> <li>Cures fast to save time and reduce dirt attraction, skin time of 60 min and tack-free time of 3-4 hr</li> <li>Can be painted to achieve desired appearance (check paint compatibility)</li> </ul>
<b>Multi-Component Urethane Sealants</b>		
<b>Vulkem® 445SSL</b> A field-tintable, semi-self-leveling, polyurethane sealant that includes a tintable base and a choice of 70 standard colors. Offers exceptional primerless adhesion and movement capability in horizontal applications.	<ul style="list-style-type: none"> <li>Traffic rated, multi-component, moisture-curing polyurethane sealant</li> <li>Suitable for continuous immersion in non-chlorinated water</li> </ul>	<ul style="list-style-type: none"> <li>Pourable and semi-self-leveling</li> <li>Jet fuel-resistant</li> <li>Can be applied to damp or green concrete</li> <li>Great UV resistance and will not out gas</li> </ul>
<b>Silicone Sealants*</b>		
<b>Spectrem® 1</b> The ideal sealant for the most demanding dynamically moving joints. Spectrem 1 is a high-performance, ultra-low modulus silicone sealant, formulated to work with materials having a high coefficient of linear expansion.	<ul style="list-style-type: none"> <li>High elasticity with movement ability of +100/-50%</li> <li>Moisture-curing, single-component silicone sealant requires no mixing and is always ready for immediate application with conventional caulking equipment</li> <li>Greenguard Gold certification ensures safety for use in the most sensitive indoor environments</li> </ul>	<ul style="list-style-type: none"> <li>Excellent for difficult-to-adhere-to substrates</li> <li>Wide variety of colors to choose from with custom colors and color matching available</li> <li>Resistance to driving rain, ozone, UV light, and temperature extremes provides exceptional weatherability in all climates</li> </ul>
<b>Spectrem® 2</b> A high-performance, medium-modulus silicone sealant, ideal as a single product for a variety of applications on the same job from 2-sided structural glazing to perimeter caulking and joint filling.	<ul style="list-style-type: none"> <li>Offers excellent adhesion to a variety of substrates including glass and metal</li> <li>Resists driving rain, ozone, UV light, and temperature extremes for weatherability in all climates</li> <li>Wide variety of colors to choose from with custom colors and color matching available</li> <li>Greenguard Gold certification ensures safety for use in the most sensitive indoor environments</li> </ul>	<ul style="list-style-type: none"> <li>Sealing dynamically moving joints in</li> <li>EIFS</li> <li>Aluminum/metal panels</li> <li>Curtain walls</li> <li>Window perimeters</li> </ul>
<b>Spectrem® 3</b> An easy to use, construction grade sealant with patented advanced silicone technology. Spectrem 3 is non-staining and low polar, which leads to reduced attraction to dirt and an improved aesthetic appearance.	<ul style="list-style-type: none"> <li>Low polar attraction to dirt, limiting accumulation and making buildings easier to clean and maintain</li> <li>Matte finish, creates an aesthetically pleasing appearance with EIFS and stone substrates</li> <li>Primerless adhesion to most porous substrates</li> </ul>	<ul style="list-style-type: none"> <li>Extended tooling time and workability in high temperatures</li> <li>Low-VOC and zero-solvent content</li> <li>Greenguard Gold certification ensures safety for use in the most sensitive indoor environments</li> </ul>
<b>Spectrem® 4-TS</b> A tintable, multi-component, construction grade sealant with patented advanced silicone technology. Spectrem 4-TS offers advanced color flexibility with the opportunity to tint the material on site, and is non-staining and low polar, which leads to reduced dirt attraction and an improved aesthetic appearance.	<ul style="list-style-type: none"> <li>Dynamic movement capability of ± 50%</li> <li>Tremco Universal Color Paks available in 70 standard colors with no minimum purchase quantity creates color flexibility for seamless facade appearances</li> <li>Tintable on-site for quick turn-around</li> </ul>	<ul style="list-style-type: none"> <li>Low polar attraction to dirt makes buildings easier to clean and maintain</li> <li>Primerless adhesion to most materials</li> <li>Low-VOC and zero-solvent content</li> <li>Greenguard Gold certification ensures safety for use in the most sensitive indoor environments</li> </ul>
<b>Spectrem® 800/900SL</b> Both are Spectrem 800 and 900SL are low-modulus, parking structure and highway joint sealants capable of withstanding dynamic movement in the most demanding joints found in heavily trafficked areas. Spectrem 900SL has the added feature of being self-leveling.	<ul style="list-style-type: none"> <li>Moisture-curing, single-component silicone sealants that require no mixing and is always ready to use for immediate application with conventional caulking equipment or highway sealing equipment</li> <li>Low modulus and high movement characteristics make these products suitable for sealing the most demanding dynamically moving joints typical of highway and bridge construction</li> <li>Spectrem 900SL is self-leveling for easy installation on horizontal surfaces</li> </ul>	<ul style="list-style-type: none"> <li>Sealing traffic joints where high movement occurs:</li> <li>Highways</li> <li>Airport runways and joints</li> <li>Parking decks, garages, and other parking structures</li> <li>Bridge joints</li> </ul>
<b>Tremisil® 200</b> A single-component, acetoxy silicone sealant that cures to a flexible rubber when exposed to moisture present in the air, providing a weathertight seal in various applications.	<ul style="list-style-type: none"> <li>Produces a weathertight seal</li> <li>White and Clear options available with a fungicide</li> <li>Easy to apply with standard caulking equipment</li> </ul>	<ul style="list-style-type: none"> <li>Greenguard Gold certification ensures safety for use in the most sensitive indoor environments, including hospitals and schools</li> </ul>
<b>Tremisil® 600</b> A fast skinning backbedding silicone sealant that cures to a flexible rubber when exposed to moisture in the air. Excellent adhesion to a variety of surfaces, making it ideal for multiple applications on the same job. Designed for application through automated glazing equipment (x-y tables)	<ul style="list-style-type: none"> <li>Excellent adhesion to a variety of substrates, including glass and metal</li> <li>Neutral-curing, single-component silicone sealants that require no mixing and is always ready to use for immediate application with conventional caulking equipment or highway sealing equipment</li> <li>Greenguard Gold certification ensures safety for use in the most sensitive indoor environments</li> </ul>	<ul style="list-style-type: none"> <li>Ideal for use in kitchens, bathrooms, spas, and similar applications</li> <li>Suitable on glass, metal, porcelain, ceramic, and most painted surfaces, creating a weathertight seal</li> </ul>

SSL = Semi-Self-Leveling TS = Tintable Silicone SL = Self-Leveling

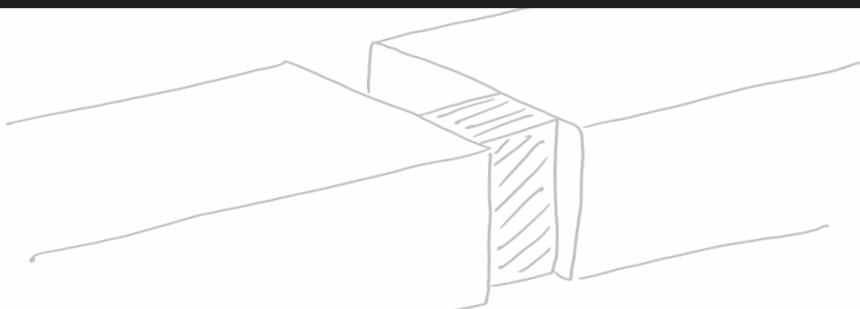

High-performance urethane, silicone and specialty sealants designed to seal the entire building enclosure while meeting the demanding requirements and special needs of architects, engineers, contractors and building owners.

Description	Advantages	Best For / Systems
<b>Specialty Sealants</b>		
<b>Tremflex® 834</b> A general purpose, pure acrylic latex sealant formulated to provide a fast setting pliable seal with minimal shrinkage. Formulated from the highest quality acrylic polymers to offer exceptional flexibility and workability for any commercial construction acrylic sealant applications. Designed for application through automated glazing equipment (x-y tables)	<ul style="list-style-type: none"> <li>Tack-free in 15 min and ready to paint in 30-45 min with latex or oil-based paint</li> <li>Easy gunning</li> <li>Non-staining</li> </ul>	<ul style="list-style-type: none"> <li>Can be used indoors or outdoors</li> <li>Reduces sound transmissions when constructing partition walls</li> </ul>
<b>Tremco® 830**</b> A one-part, thermoplastic elastomeric sealant that provides a high performance, flexible seal in glazing and siding applications.	<ul style="list-style-type: none"> <li>Offered in a wide range of colors to match popular siding and window tints</li> <li>Fast skinning, fast cure through</li> </ul>	<ul style="list-style-type: none"> <li>Easy gunning</li> <li>Excellent weather and UV resistance</li> <li>Can be painted with latex paint</li> </ul>
<b>Acoustical / Curtainwall Sealant</b> A non-skinning, non-hardening synthetic rubber sealant developed for acoustical sealing of drywall partitions, curtainwalls, corridors, and party walls.	<ul style="list-style-type: none"> <li>Application greatly increases the Sound Transmission Class (STC value) of a system</li> <li>Single component sealant, requires no mixing</li> </ul>	<ul style="list-style-type: none"> <li>Reduces the decibel level when one or more beads are applied to a joint</li> <li>May be used in contact with polystyrene</li> </ul>
<b>Adhesives</b>		
<b>TREMgrip®</b> A quick tack adhesive that acts as a second set of hands you can count on! TREMGrip is a high performance adhesive developed to bond construction materials to a variety of substrates. A one component, non-sag, elastic, quick tack adhesive based on hybrid polymers.	<ul style="list-style-type: none"> <li>Extremely high initial grab</li> <li>Instant grab minimizes the need for additional fasteners or clamps during installation</li> <li>Offers great elasticity and rapid bond development</li> </ul>	<ul style="list-style-type: none"> <li>Suitable for use on a variety substrates both indoors and outdoors</li> <li>Resistant to UV, weather, and aging</li> <li>Extremely low VOC, low odor</li> </ul>
<ul style="list-style-type: none"> <li>Ideal as an in-plant glazing sealant for back-bedding, cap, heel and toe beads, and sash joinery</li> <li>Excellent adhesion to aluminum, stainless steel, metals, glass, plastics, rigid PVCs, wood, brick, concrete and painted surfaces</li> </ul>		
<ul style="list-style-type: none"> <li>Glazing: used for face bedding, cap beads and sealing miter joints in window profiles</li> <li>Siding: used with sill trim, flashings, fascia, J-trim, F-channel, and crown molding</li> <li>Suitable for sealing the perimeters of wood, PVC, and aluminum residential windows and doors.</li> </ul>		
<ul style="list-style-type: none"> <li>Acoustical Seating of Joints: <ul style="list-style-type: none"> <li>Drywall partitions &amp; corridors</li> <li>Bedding for panels, sheets, rails, moldings and other types of sleeves or connections to aluminum window wall and curtain walls</li> </ul> </li> <li>Suitable for lap joint and perimeter sealant for polyethylene vapor barriers over fiberglass batt or other insulations</li> <li>Concealed lap joints &amp; perimeter sealant</li> <li>Concealed metal-to-metal curtain wall joints</li> </ul>		
<ul style="list-style-type: none"> <li>Drainage board for backfill applications</li> <li>Air Barrier Applications</li> <li>Insulation to Air Barriers and Below Grade Membranes</li> <li>Metal-to-metal joinery</li> <li>Bedding compound</li> <li>Rubber-to-metal</li> </ul>		
SSL = Semi-Self-Leveling TS = Tintable Silicone SL = Self-Leveling		

Innovative, pre-engineered, airtight and watertight systems designed to provide continuity at critical transitions from window or structural framing to adjacent air and vapor barrier systems.

Description	Advantages	Best For / Systems
<b>Engineered Transition Assembly</b>		
<b>Proglaze® ETA</b> Proglaze ETA Connections are pre-engineered silicone materials used as a transition assembly between the window or wall system and adjacent air and vapor barrier materials. Designed to absorb thermal movement and windloading stresses.  Comprised of a flat single- or double-ribbed silicone extrusion, which is adhered with Spectrem 1 Silicone Sealant to ensure a durable connection and positive seal. The opposite edge of the ribbed silicone extrusion will span unsupported onto the wall and/or window system, which is adhered with Spectrem 1 as well.	<ul style="list-style-type: none"> <li>Thin cross-section and low durometer allows the material to span and seal across irregular window geometries</li> <li>The translucent silicone material allows the installer and/or inspector to see through the gasket to verify the recommended amount of sealant is properly applied to ensure an effective seal is achieved, while the ribs of the gasket's design ensures a minimum sealant thickness</li> <li>Wide variety of widths (either Single Ribbed or Double Ribbed) available to support any project, with custom sizing as an additional option</li> </ul>	<ul style="list-style-type: none"> <li>Expansion Joints</li> <li>Seismic Joints</li> <li>Recommended for use in conjunction with the ExoAir membranes</li> <li>Fully compatible with most window sealants and glazing materials</li> </ul> <p><i>*Not recommended as a seal to untested substrates</i></p>
<b>Polyurethane Foams</b>		
<b>ExoAir® Flex</b> Single-component, moisture-cure, gun-grade polyurethane flexible foam that performs as a thermal barrier with an industry leading movement range of +/-15%	<ul style="list-style-type: none"> <li>Single-component polyurethane foam with a (H)CFC-free propellant.</li> <li>High yield versus existing polyurethane foams</li> <li>Quick tack-free time</li> <li>Excellent properties at low ambient temperatures</li> </ul>	<ul style="list-style-type: none"> <li>Best suited as a thermal and sound barrier to be used in the perimeters around windows and doors.</li> <li>Flexible composition is well-suited for applications that incur movement.</li> </ul>
<b>ExoAir® LEF</b> ExoAir® LEF is a single-component, CFC-free, all-season, high performance, gun-grade polyurethane foam that performs as a thermal barrier.	<ul style="list-style-type: none"> <li>The ExoAir LEF is best suited around window and door frame joints but can also be used as an effective joint filler in hidden applications.</li> <li>LEF is most commonly used as a thermal and sound barrier.</li> <li>The product can be installed in temperatures ranging from 14 to 95° F (-10 to 35° C)</li> </ul>	<ul style="list-style-type: none"> <li>Used to fill gaps surrounding penetrations prior to air barrier installation.</li> <li>Best suited around window and door frame joints but can also be used as an effective joint filler.</li> </ul>
<b>Pre-Formed Transition Extrusions</b>		
<b>Dymonic® Simple Seal</b> A preformed polyurethane extrusion specifically designed to bridge joints under elastomeric wall coatings. Designed for both new construction and restoration work involving various connection points that will be coated over with an elastomeric coating. Dymonic Simple Seal is typically bonded with Dymonic 100 Polyurethane Sealant to a wide range of substrates to provide a watertight seal.	<ul style="list-style-type: none"> <li>Cost effective alternative to cutting out existing failed sealant</li> <li>High flexibility and movement capability recommended for sealing high movement joints</li> <li>High tear resistance</li> <li>Easy to install medium modulus preformed polyurethane extrusion, saves time and labor</li> <li>Compatible and can be coated over with TREMGard HB wall coatings, Vulkem deck coatings, and ExoAir 130 and ExoAir 230 fluid applied air barriers</li> </ul>	<ul style="list-style-type: none"> <li>Expansion joints</li> <li>Window/door perimeters</li> <li>EIFS joints</li> <li>Parapet walls</li> <li>Skylights</li> <li>Transition seals</li> <li>Curtain wall joints</li> <li>Sheet metal roof joints</li> <li>Any other lap joints that will be coated with an elastomeric coating</li> </ul>
<b>Spectrem® Simple Seal</b> A high performance preformed silicone extrusion specifically designed to have high elongation properties. Spectrem Simple Seal is typically bonded with Spectrem 1 or Spectrem 2 Silicone Sealant to a wide range of substrates to provide a watertight seal in new construction or restoration projects.	<ul style="list-style-type: none"> <li>Cost effective alternative to cutting out existing failed sealant</li> <li>High flexibility and movement capability for sealing high movement joints</li> <li>Easy to install ultra-low modulus silicone extrusion, saves time and labor</li> <li>High tear resistance</li> <li>Color fast formulation is resistant to UV exposure and weathering</li> <li>Wide operational temperature range</li> <li>Non-corrosive and corrosion resistant</li> <li>SWRI Validated</li> </ul>	<ul style="list-style-type: none"> <li>Tremco Spectrem Simple Seal is designed for both new construction and restoration work involving window perimeter, EIFS joints, parapet walls, skylights, aluminum window seals, transition seals, curtain walls joints, sheet metal roofs, &amp; other joints.</li> </ul>

Together, Dryvit and Tremco offer fluid-applied, self-adhered, and pre-applied air and vapor barriers to fit any project's performance criteria.

Description		Product Advantages		Best For / Systems	
<b>Fluid-Applied Air Barriers</b>					
ExoAir® 120	The fluid-applied asphaltic vapor barrier membrane recommended for use in commercial applications.	<ul style="list-style-type: none"> <li>• Monolithic application</li> </ul>		<ul style="list-style-type: none"> <li>• Exterior grade gypsum</li> <li>• Fiber-reinforced cement</li> <li>• Unpainted, unsealed concrete</li> </ul>	<ul style="list-style-type: none"> <li>• Exterior grade plywood</li> <li>• OSB</li> <li>• Metal</li> </ul>
ExoAir® 130	The high performance fluid-applied vapor barrier membrane that offers 12 months of UV resistance and service temperatures up to 240 °F. Recommended for use in commercial applications and projects that require NFPA 285 assembly testing.	<ul style="list-style-type: none"> <li>• Monolithic application</li> <li>• Extended UV resistance</li> <li>• High service temperatures</li> </ul>	<ul style="list-style-type: none"> <li>• Primerless application on most substrates</li> </ul>	<ul style="list-style-type: none"> <li>• Exterior grade gypsum</li> <li>• Fiber-reinforced cement</li> <li>• Unpainted, unsealed concrete</li> </ul>	<ul style="list-style-type: none"> <li>• Exterior grade plywood</li> <li>• OSB</li> <li>• Metal</li> </ul>
ExoAir® 220	The fluid-applied asphaltic vapor permeable air barrier membrane recommended for use in commercial applications.	<ul style="list-style-type: none"> <li>• Monolithic application</li> </ul>		<ul style="list-style-type: none"> <li>• Exterior grade gypsum</li> <li>• Fiber-reinforced cement</li> <li>• Unpainted, unsealed concrete</li> </ul>	<ul style="list-style-type: none"> <li>• Exterior grade plywood</li> <li>• OSB</li> <li>• Metal</li> </ul>
ExoAir® 230	A high performance fluid-applied vapor permeable air barrier membrane that offers 12 months of UV resistance and service temperatures up to 240 °F. Recommended for use in commercial applications and projects that require NFPA 285 assembly testing.	<ul style="list-style-type: none"> <li>• Monolithic application</li> <li>• Extended UV resistance</li> <li>• High service temperatures</li> <li>• Primerless application on most substrates</li> </ul>		<ul style="list-style-type: none"> <li>• Exterior grade gypsum</li> <li>• Fiber-reinforced cement</li> <li>• Unpainted, unsealed concrete</li> <li>• Exterior grade plywood</li> </ul>	<ul style="list-style-type: none"> <li>• OSB</li> <li>• EIFS</li> <li>• ICF</li> <li>• Metal</li> </ul>
ExoAir® 230LT	The low temperature formula of ExoAir 230, a high performance fluid-applied vapor permeable air barrier membrane that offers 12 months of UV resistance and service temperatures up to 240 °F. Recommended for use in commercial applications and projects that require NFPA 285 assembly testing.	<ul style="list-style-type: none"> <li>• Can be applied at 20 °F and rising</li> <li>• Monolithic application</li> <li>• Extended UV resistance</li> </ul>	<ul style="list-style-type: none"> <li>• High service temperatures</li> <li>• Primerless application on most substrates</li> </ul>	<ul style="list-style-type: none"> <li>• Exterior grade gypsum</li> <li>• Fiber-reinforced cement</li> <li>• Unpainted, unsealed concrete</li> </ul>	<ul style="list-style-type: none"> <li>• Exterior grade plywood</li> <li>• OSB</li> <li>• Metal</li> </ul>
EnviroDri®	An asphaltic fluid-applied vapor permeable air barrier membrane that creates a permanent and complete weather-resistant barrier for residential and multi-family applications.	<ul style="list-style-type: none"> <li>• Monolithic application</li> <li>• Can be applied at 0 °F and rising</li> </ul>		<ul style="list-style-type: none"> <li>• Plywood</li> <li>• Structural fiber board</li> <li>• OSB</li> </ul>	<ul style="list-style-type: none"> <li>• Exterior grade gypsum</li> <li>• Block masonry</li> <li>• Exterior grade plywood</li> </ul>
Backstop® NTX Smooth / Texture	Created for use with Dryvit's Outsulation Systems, this fluid-applied vapor permeable air barrier membrane can be applied as low as 25 °F with a sprayer or roller in Smooth, or with a trowel in Texture.	<ul style="list-style-type: none"> <li>• Can be applied at 25 °F and rising</li> <li>• Monolithic application</li> <li>• High service temperatures</li> </ul>		<ul style="list-style-type: none"> <li>• EIFS</li> <li>• Exterior grade gypsum</li> <li>• Exterior sheathing</li> </ul>	<ul style="list-style-type: none"> <li>• EPS</li> <li>• Fiber-reinforced cement</li> <li>• Unpainted, unsealed concrete</li> <li>• ICF</li> </ul>
Backstop® NT-VB	Created for use with Dryvit's Outsulation Systems, this fluid-applied vapor barrier membrane can be applied using a trowel or texture spray equipment.	<ul style="list-style-type: none"> <li>• Monolithic application ensures a continuous film barrier across transitions</li> <li>• High service temperatures</li> </ul>		<ul style="list-style-type: none"> <li>• EIFS</li> <li>• Exterior grade gypsum</li> <li>• Exterior sheathing</li> </ul>	<ul style="list-style-type: none"> <li>• EPS</li> <li>• Fiber-reinforced cement</li> <li>• Unpainted, unsealed concrete</li> <li>• ICF</li> </ul>
Backstop® DMS	A one step fluid-applied permeable air barrier and adhesive created for Dryvit's Outsulation Systems. Specifically formulated for spray applications.	<ul style="list-style-type: none"> <li>• One-step adhesive and barrier for labor savings</li> <li>• Monolithic application</li> <li>• Ready to use, just add water</li> </ul>		<ul style="list-style-type: none"> <li>• EPS</li> <li>• Exterior grade gypsum</li> <li>• Exterior sheathing</li> </ul>	<ul style="list-style-type: none"> <li>• Fiber-reinforced cement</li> <li>• Brick, cement plaster, concrete, masonry</li> </ul>
<b>Self-Adhered Air Barriers and Flashings</b>					
ExoAir® 110	The self-adhered asphaltic vapor barrier used in projects that require a 40-mil flashing.	<ul style="list-style-type: none"> <li>• Manufactured to a present, uniform thickness</li> <li>• Available in 6", 9", and 12" flashing sizes</li> </ul>		<ul style="list-style-type: none"> <li>• Exterior grade gypsum</li> <li>• Exterior sheathing</li> </ul>	<ul style="list-style-type: none"> <li>• Fiber-reinforced cement</li> <li>• Unpainted, unsealed concrete</li> </ul>
ExoAir® 110AT	The high performance self-adhered vapor barrier that offers 12 months of UV resistance and service temperatures up to 240 °F. ExoAir 110AT can be applied in hot or cold temperatures without the need for a primer. Recommended for use in commercial applications and projects that require NFPA 285 assembly testing.	<ul style="list-style-type: none"> <li>• Can be applied at 20F and up</li> <li>• Extended UV resistance</li> <li>• Primerless application on most substrates</li> </ul>	<ul style="list-style-type: none"> <li>• Manufactured to a present, uniform thickness</li> <li>• High service temperatures</li> </ul>	<ul style="list-style-type: none"> <li>• Exterior grade gypsum</li> <li>• Exterior sheathing</li> <li>• Fiber-reinforced cement</li> <li>• Unpainted, unsealed concrete</li> </ul>	
ExoAir® 210AT	The high performance self-adhered vapor permeable air barrier that offers 6 months of UV resistance and service temperatures up to 240 °F. ExoAir 210AT can be applied in hot or cold temperatures without the need for a primer. Recommended for use in commercial applications and projects that require NFPA 285 assembly testing.	<ul style="list-style-type: none"> <li>• Can be applied at 20 °F and rising</li> <li>• Primerless application on most substrates</li> <li>• Manufactured to a present, uniform thickness</li> <li>• High service temperatures</li> </ul>		<ul style="list-style-type: none"> <li>• Exterior grade gypsum</li> <li>• Exterior sheathing</li> <li>• Fiber-reinforced cement</li> <li>• Unpainted, unsealed concrete</li> </ul>	
<b>Pre-Applied Air Barrier</b>					
Securock® ExoAir® 430	Brings two proven technologies together — USG Securock® Brand UltraLight Glass-Mat Sheathing and Tremco ExoAir® air barrier membrane — into one panel that efficiently controls air, water, and vapor throughout the building envelope. Perfect for projects that want to increase speed without sacrificing performance.	<ul style="list-style-type: none"> <li>• Can be applied at any temperature</li> <li>• Manufactured to a present, uniform thickness</li> <li>• Extended UV resistance</li> <li>• High service temperatures</li> <li>• Tested to NFPA 285 assembly and ASTM E84.</li> </ul>		<ul style="list-style-type: none"> <li>• Exterior-grade gypsum</li> <li>• Specified for projects requiring extended UV resistance, high temperatures, and E84 &amp; NFPA 285 testing</li> <li>• Used in conjunction with other accessories to provide a comprehensive air barrier system</li> </ul>	

SP = Spray R = Roller

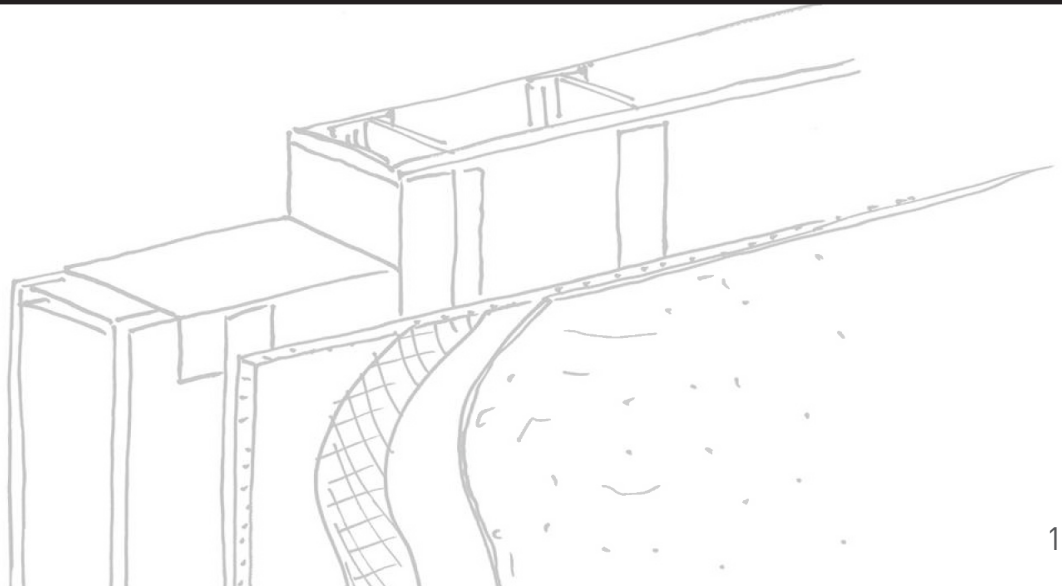

# TREMCO™ FIRESTOPPING

Passive fire protection products with more than 400 independently tested, fire-rated systems for through-penetrations and joints.









Description	Advantages	Best For / Systems
<b>TREMstop® Acrylic</b> A gunnable acrylic latex sealant that stops fire at joints and through-penetrations to better protect the structural integrity of the building.	<ul style="list-style-type: none"> <li>• Features excellent movement for flexibility after application</li> <li>• Excellent unprimed adhesion on a wide range of substrates</li> <li>• Accepts paint after being fully cured to allow a multitude of aesthetic designs and colors</li> <li>• 15 (Class A) Flame Spread, 0 Smoke Development</li> <li>• Single-component, gunnable formula allows for quick application</li> </ul>	Electrical, Mechanical, Plumbing, and Telecom Applications: <ul style="list-style-type: none"> <li>• Fire-rated assembly smoke partitions through assembly joints</li> <li>• Fire-rated assembly through penetrations</li> <li>• Smoke partition joints and penetrations</li> <li>• Suitable for static and dynamic joints</li> <li>• Can be used on metal/plastic/insulated pipes, cables and ducts</li> </ul>
<b>TREMstop® Fyre-Sil</b> A neutral-cure silicone sealant that provides protection against washout conditions in firestopping applications. When installed with a tested firestop system, TREMstop Fyre-Sil grants code compliance for both through-penetrations and fire-rated joints.	<ul style="list-style-type: none"> <li>• Available in both gun-grade and self-leveling options for jobsite flexibility</li> <li>• Self-leveling allows for a quicker application and quicker cure to save time on a job</li> <li>• Single-component formula allows labor and time costs savings</li> </ul>	Electrical, Mechanical, Plumbing, and Telecom Applications: <ul style="list-style-type: none"> <li>• Fire-rated and smoke-rated joints</li> <li>• Smoke partition joints and penetrations</li> <li>• Fire-rated assembly smoke partition through assembly joints</li> <li>• Fire-rated assembly through penetrations</li> <li>• Static and dynamic joints in concrete, wood floor/ceiling, and gypsum assemblies</li> <li>• Can be used on metal pipe, plastic pipe, cables, and cable trays</li> </ul>
<b>TREMstop® Smoke &amp; Sound</b> An acrylic latex sealant for use in smoke-rated partitions or joints and to prevent sound transmission through unprotected openings. Allows for a safe environment to exit a building when next to a fire by reducing the amount of smoke transmission through unprotected openings.	<ul style="list-style-type: none"> <li>• This one product meets the needs for both smoke and sound rated partitions to save costs of using a second product</li> <li>• Available in both gun-grade and sprayable options for jobsite flexibility</li> <li>• Accepts paint after full cure to allow a many designs and colors</li> <li>• Contains an anti-fungal additive for a longer sealant life</li> </ul>	<ul style="list-style-type: none"> <li>• Smoke partition joints and penetrations</li> <li>• Through penetrations</li> <li>• Sound rated partitions</li> </ul>
<b>TREMstop® SuperStrip</b> A flexible graphite-based intumescent with a polyethylene backer designed to expand when exposed to a fire to fill any voids lefts as the combustible materials burn away. Will fill out to stop the fire more quickly than other firestopping sealants, increasing overall safety.	<ul style="list-style-type: none"> <li>• This intumescent is ready to be laid down, saving labor costs</li> <li>• Flexible enough to wrap pipes so there is no need for additional products or sealants</li> <li>• Available in rolls and pre-cut strips to reduce waste and accommodate a variety of pipe diameters and types</li> </ul>	<ul style="list-style-type: none"> <li>• Fire-rated assembly through penetrations</li> <li>• Plastic pipe in concrete assemblies</li> <li>• Wood floor/ceiling assemblies</li> <li>• Fluted metal decks</li> </ul>

# TREMCO™ PUMA TECHNOLOGY

Tremco systems with polyurethane-methacrylate (PUMA) technology feature extreme durability, fast cure independent of temperature, crack-bridging, superior adhesion and abrasion resistance.

Description	Advantages	Best For / Systems
<b>Vulkem® EWS Pedestrian</b> A pedestrian waterproof traffic deck coating system that utilizes polyurethane- methacrylate (PUMA) technology, which is designed to protect concrete slabs and occupied areas underneath from water damage and the damaging effects of chemicals, gasoline, chloride and more. PUMA technology delivers extreme durability while maintaining its crack-bridging characteristics and eliminating the need for reinforcing fabric.	<ul style="list-style-type: none"> <li>• Can be applied in temperatures as low as 14° F (-10° C), extending application window</li> <li>• Open to foot traffic within one hour after application, providing quick return to service</li> <li>• Compatible with Tremco sealants, coatings, and expansion joints, for simplified tie-ins, detailing, and penetrations</li> <li>• Protects against chloride, deicing salts, chemicals, gasoline, oils, and anti-freeze, keeping surfaces protected longer</li> <li>• Unique chemistry – bonds to itself for easy repairs</li> <li>• Low VOC to help improve surrounding air quality</li> </ul>	<ul style="list-style-type: none"> <li>• Stadiums</li> <li>• Balconies</li> <li>• Pool decks</li> <li>• Pedestrian walkways</li> <li>• Mechanical rooms</li> </ul>
<b>Vulkem® EWS Vehicular</b> A vehicular waterproof traffic deck coating system that utilizes polyurethane- methacrylate (PUMA) technology, which is designed to protect concrete slabs and occupied areas underneath from water damage and the damaging effects of chemicals, gasoline, chloride, and more. PUMA technology delivers extreme durability while maintaining its crack-bridging characteristics.	<ul style="list-style-type: none"> <li>• Can be applied in temperatures as low as 14° F (-10° C), extending application window</li> <li>• Open to vehicular traffic within one hour after application, for quick return to service</li> <li>• Compatible with Tremco sealants, coatings, and expansion joints, for simplified tie-ins, detailing, and penetrations</li> <li>• Minimal downtime (approximately 30 to 45 min) between application coats, ideal for condensed construction cycles, even in cold temperatures</li> <li>• Protects against chloride, deicing salts, chemicals, gasoline, oils, and anti- freeze, keeping surfaces protected longer</li> <li>• Unique chemistry – bonds to itself for easy repairs</li> <li>• Low VOC to help improve surrounding air quality</li> </ul>	<ul style="list-style-type: none"> <li>• Parking decks</li> <li>• Drive lanes</li> <li>• Helical turns</li> <li>• Concrete ramps</li> <li>• Ticket spitters</li> </ul>
<b>Vulkem® EWS Heavy Duty</b> A heavy-duty waterproof traffic deck coating system that utilizes polyurethane-methacrylate (PUMA) technology that is designed to have tenacious adhesion and extreme abrasion resistance. Ideal for waterproofing concrete slabs and protecting areas underneath from water damage and the damaging effects of water, deicing salts, chemicals, gasoline, oils, and anti-freeze.	<ul style="list-style-type: none"> <li>• Maximum abrasion resistance is ideal for protecting areas with snowplows and heavy commercial truck traffic</li> <li>• Open to vehicular traffic within one hour after application, for quick return to service</li> <li>• Minimal downtime (approximately 30 to 45 min) between application coats, ideal for condensed construction cycles, even in cold temperatures</li> <li>• Compatible with Tremco sealants, coatings, and expansion joints, which is essential for tie-ins, detailing and penetrations</li> <li>• Can be applied in temperatures as low as 14° F (-10° C), extending application window</li> <li>• Low VOC to help improve surrounding air quality</li> </ul>	<ul style="list-style-type: none"> <li>• Parking decks</li> <li>• Dumpster areas</li> <li>• Loading docks</li> </ul>
<b>Vulkem® EWS Specialty</b> A durable waterproof coating system for specialty application uses including pool decks, water features, athletic surfaces, and more. It utilizes polyurethane- methacrylate (PUMA) technology, which is designed to protect concrete slabs and occupied areas underneath from water damage and the damaging effects of chemicals, gasoline, chloride, and more.	<ul style="list-style-type: none"> <li>• Can be applied in temperatures as low as 14° F (-10° C), extending application window</li> <li>• Extreme durability with exceptional crack-bridging characteristics, eliminating the need for reinforcing fabric</li> <li>• Protects against chloride, deicing salts, chemicals, gasoline, oils, and anti- freeze, keeping surfaces protected longer</li> <li>• Minimal downtime (approximately 30 to 45 min) between application coats, ideal for condensed construction cycles, even in cold temperatures</li> </ul>	<ul style="list-style-type: none"> <li>• Pool decks</li> <li>• Splash pads</li> <li>• Athletic surfaces</li> <li>• Under tile</li> <li>• Water features</li> </ul>
<b>TREMproof® PUMA Waterproofing</b> A premium system for waterproofing concrete and protecting occupied space from water damage utilizing polyurethane- methacrylate (PUMA) technology. TREMproof PUMA waterproofing can be used in planters, flashing systems, horizontal waterproofing, vegetated roofs, and in asphalt overlays.	<ul style="list-style-type: none"> <li>• Aesthetically appealing waterproofing with a variety of finish options</li> <li>• Seamless, monolithic membrane creates an even surface</li> <li>• Extreme durability with exceptional crack-bridging characteristics, eliminating the need for reinforcing fabric</li> <li>• Can be applied in temperatures as low as 14° F (-10° C), extending application window</li> </ul>	<ul style="list-style-type: none"> <li>• Planters</li> <li>• Flashing systems</li> <li>• Horizontal waterproofing</li> <li>• Vegetated roofs</li> <li>• Asphalt overlay</li> </ul>

A complete line of glazing sealants and compatible gaskets, tapes, spacers and setting blocks for use in commercial curtain wall and window applications, allowing the design of integrated systems with assurance of adhesion, weatherability and durability.

	Description	Advantages	Best For / Systems
<b>Sealants</b>			
Proglaze®	A high performance gun-grade silicone sealant ideal for in-field and in-plant glazing applications.	<ul style="list-style-type: none"> <li>• Produces a durable, flexible seal</li> <li>• Moisture curing, acetoxy sealant is easily gunned in all weather conditions</li> <li>• Selected colors (Proglaze Clear, White, Aluminum and Black) acceptable for indirect contact of edible products under USDA requirements</li> <li>• Greenguard Gold certified for use in the most sensitive indoor environments</li> </ul>	Glazing applications: <ul style="list-style-type: none"> <li>• Cap, toe, and heel beads</li> <li>• Metal-to-metal joinery</li> <li>• Any other in-plant applications where a gun-grade sealant is required</li> </ul>
Proglaze® SSG	A high modulus silicone sealant designed to meet the stringent performance needs for both 2- and 4-sided structural and protective glazing. Whether it is a unitized curtain wall manufactured in plant or a field-glazed project, Proglaze SSG offers fast through cure and exceptional tensile strength to meet the most stringent building codes.	<ul style="list-style-type: none"> <li>• Provides excellent adhesion, fast through-cure and exceptional tensile strength and flexibility critical to withstanding wind cycle loads and missile impacts</li> <li>• Impact/hurricane tested to the industry's most stringent performance standards, and is a successfully tested structural anchor in retrofit Blast Film applications</li> <li>• Single-component, neutral-cure silicone sealant</li> <li>• Greenguard Gold certified</li> </ul>	<ul style="list-style-type: none"> <li>• Structural glazing (tensile and weather bead)</li> <li>• Hurricane/impact and blast mitigation</li> </ul> <i>*All structural glazing applications must be reviewed and approved by Tremco.</i>
Spectrem® 1	The ideal sealant for the most demanding dynamically moving joints. Spectrem 1 is a high-performance, ultra-low modulus silicone sealant, formulated to work with materials having a high coefficient of linear expansion.	<ul style="list-style-type: none"> <li>• High elasticity with movement of +100/-50%</li> <li>• Excellent for sealing difficult-to-adhere-to substrates</li> <li>• Resistance to driving rain, ozone, UV light, and temperature extremes</li> <li>• Greenguard Gold certification ensures safety for use in the most sensitive indoor environments including hospitals and schools</li> </ul>	Sealing dynamically moving joints in: <ul style="list-style-type: none"> <li>• EIFS</li> <li>• Aluminum, metal panels</li> <li>• Curtain walls</li> <li>• Window perimeters</li> </ul> <ul style="list-style-type: none"> <li>• Pre-cast concrete panels</li> <li>• Post ExoAir membrane detailing</li> <li>• Adhering Proglaze ETA</li> <li>• Bonding to the HDPE facer of self-adhered membranes</li> </ul>
Spectrem® 2	A high-performance, medium-modulus silicone sealant, ideal as a single product for a variety of applications on the same job from 2-sided structural glazing to perimeter caulking and joint filling.	<ul style="list-style-type: none"> <li>• Medium modulus: can be used as a structural tensile bead and weather sealant</li> <li>• Offers excellent adhesion to a variety of substrates including glass and metal</li> <li>• Resistance to driving rain, ozone, UV light, and temperature extremes</li> <li>• Wide variety of colors to choose from with custom colors and matching available</li> <li>• Greenguard Gold certified</li> </ul>	<ul style="list-style-type: none"> <li>• Structural glazing (tensile and weather beads)</li> <li>• General glazing applications (toe beads, heel beads, cap beads)</li> </ul> <ul style="list-style-type: none"> <li>• Suitable for use on aluminum, glass, steel, painted metal, plastic, stone, concrete and brick</li> <li>• Window perimeter caulking</li> </ul>
Tremsil® 600	A fast skinning backbedding silicone sealant that cures to a flexible rubber when exposed to moisture present in the air. Tremsil 600 offers excellent adhesion to a variety of surfaces, making it ideal for multiple applications on the same job.	<ul style="list-style-type: none"> <li>• Excellent adhesion to a variety of substrates, including glass and metal, making it the ideal single product for a variety of applications on the same job from metal-to-metal joinery to perimeter beads</li> <li>• Fast skinning, medium modulus silicone sealant</li> <li>• Greenguard Gold certification ensures safety for use in the most sensitive indoor environments including hospitals and schools</li> </ul>	<ul style="list-style-type: none"> <li>• Ideal for use as an in-plant glazing sealant for applications that include back-bedding, cap, heel and toe beads, and sash joinery</li> <li>• Compatible with most common porous and non-porous building components and has excellent adhesion to aluminum, stainless steel, metals, glass, plastics, rigid PVCs, wood, brick, concrete and painted surfaces</li> <li>• Designed for application through automated glazing equipment (x-y tables)</li> </ul>
<b>Tapes</b>			
440 Tape	100% solid polyisobutylene cross-linked butyl, preformed sealant.		<ul style="list-style-type: none"> <li>• Non-compression glazing</li> <li>• Metal-to-metal lap seals</li> </ul>
PolyShim® II	100% solids, cross-linked butyl preformed tape with a continuous integral EPDM shim.		<ul style="list-style-type: none"> <li>• Compression glazing systems</li> <li>• Spacer for structural silicones</li> </ul>
SGT-900 Series	Open cell, high-density polyurethane foam tapes with a micro-cellular structure with PSA on one or both sides.		<ul style="list-style-type: none"> <li>• Compatible spacer for Structural Glazing Systems</li> </ul>
<b>Extrusions</b>			
Typical Profiles			
Arrow-Shim	Precision extruded EPDM drive-in spacer-shims.	<ul style="list-style-type: none"> <li>• Controls proper spacing</li> <li>• Recess for cap bead</li> <li>• Uniform cushion for glass</li> </ul>	
Poly-Wej	Extruded in EPDM compound for use in compression glazing systems.	<ul style="list-style-type: none"> <li>• Compression wedge for PolyShim Tape</li> <li>• Compression wedge for dense/dense systems</li> </ul>	
Glazing Spline	An extruded EPDM compound for use in compression glazing systems.	<ul style="list-style-type: none"> <li>• Compression wedge for PolyShim Tapes and compatible gunnable sealants</li> <li>• Compression spline for dense/dense systems</li> </ul>	
Vision Strip®	A co-extruded composite made up of EPDM rubber at the sightline and polyisobutylene, preformed butyl sealant.	<ul style="list-style-type: none"> <li>• Compression glazing systems</li> <li>• Control proper glass spacing</li> <li>• Positive wet seal between glass and metal</li> </ul>	
Cellular	Closed cell EPDM extruded rubber.	<ul style="list-style-type: none"> <li>• Pre-set compression gasket</li> <li>• Weatherstripping</li> <li>• Operating vent seals</li> </ul>	
Dense EPDM	40, 50, 60, 70 and 90 durometer Shore A extruded EPDM.	<ul style="list-style-type: none"> <li>• Compression wedge gaskets</li> <li>• Weatherstripping</li> <li>• Setting and edge blocks</li> </ul>	
Dense Silicone	40, 60, 70 and 80 durometer Shore A extruded silicone rubber.	<ul style="list-style-type: none"> <li>• Compression wedge gaskets</li> <li>• Structural glazing back-up spacers</li> <li>• Setting and edge blocks</li> </ul>	
Spectrem® Restoration Overlay	Dense rubber extrusions used for restoration applications. The patented, innovative design solution provides long-lasting performance and aesthetics. Typically bonded with Spectrem 1 Silicone Sealant to provide a watertight seal. Many profile options are available depending upon existing metal requirements, custom color matching is also available	<ul style="list-style-type: none"> <li>• Color-fast formula is resistant to the effects of UV exposure</li> <li>• Encapsulated wet seal is protected from exposure to the elements</li> <li>• Reduced time / labor costs and less sealant needed versus other methods</li> <li>• High movement capability</li> </ul>	<ul style="list-style-type: none"> <li>• Wide operational temperature range</li> <li>• Non-corrosive and corrosion resistant</li> <li>• Better overall aesthetic with sealant minimally visible</li> <li>• Better long-term performance against air and water leakage</li> </ul>
Dense SCR-900	60, 70 and 80 durometer Shore A extruded Silicone Compatible Rubber.	<ul style="list-style-type: none"> <li>• Compression wedge gaskets</li> <li>• Pre-set dense spacers</li> <li>• Weatherstripping</li> </ul>	

Most compounds available comply with: ASTM C509, Option I and II; ASTM C864, Option I and Option II; ASTM C1115, Type C

Dryvit is the manufacturer of Outsulation® systems, continuous insulation systems, Stucco systems, air & weather barriers, and building finishes & shapes. Now a part of Tremco Construction Products Group, Dryvit is a large contributor for Tremco's six-sided, all-in-one building products solutions.

Description	Advantages	Best For / Systems
<b>Outsulation® Systems</b>		
<b>Outsulation® System</b>	The original Outsulation® System. This system, along with other Outsulation® systems are more cost effective throughout their life-cycles because they continue to keep heating and cooling costs low for the life of the building.	<ul style="list-style-type: none"> <li>Design options are virtually endless giving more freedom in aesthetics</li> <li>Higher R values contribute to lower energy costs to heat and cool a building</li> <li>Fiberglass mesh offered in different strengths allow for durability and versatility</li> <li>Quick installation and low maintenance leads to lower overall cost</li> </ul>
<b>Outsulation® Plus MD</b>	An Outsulation® system that adds a second line of defense against air, moisture, and weather with Dryvit's Backstop NT and AquaFlash flashing system at all wall openings. The helps the overall system last longer and save on costs.	<ul style="list-style-type: none"> <li>Exterior grade gypsum</li> <li>Exterior sheathing</li> <li>Exterior fiber-reinforced cement</li> </ul>
<b>Outsulation® Masonry Veneer System</b>	An EIFS system that incorporates moisture drainage, an air and water resistive barrier, and a manufactured Stone Masonry Veneer system for an aesthetic finish. This all-in-one system protects the building from air and water damage while having a great exterior appearance.	<ul style="list-style-type: none"> <li>Exterior rated plywood</li> <li>Exterior rated fire-retardant plywood</li> <li>Strand board</li> </ul>
<b>Outsulation® Mineral Wool System</b>	An exterior insulation and finish system (EIFS) that incorporates moisture drainage, an air/water resistive barrier, and high-performance mineral wool Continuous Insulation with an R-Value of 4.0 per inch. Outsulation® Mineral Wool System offers an engineered and cost-effective system that is built for maximum R-Value and non-combustibility.	<ul style="list-style-type: none"> <li>Exterior grade gypsum</li> <li>Exterior sheathing</li> <li>Exterior fiber-reinforced cement</li> </ul>
<b>Outsulation® HDCI</b>	The most durable continuous insulation available today. HDCI delivers design freedom, exceptional performance, and a high level of impact resistance. With our 20-year warranty, if the lamina gets punctured, we will repair it.	<ul style="list-style-type: none"> <li>Exterior grade gypsum</li> <li>Exterior sheathing</li> <li>Exterior fiber-reinforced cement</li> <li>Exterior rated plywood</li> <li>Exterior rated fire-retardant plywood</li> <li>Strand board</li> </ul>
<b>Infinity®</b>	Offers ultimate protection against moisture intrusion with a pressure equalized rainscreen system for eliminating the potential for water to enter a building. Since water penetration is much more likely at material intersections, Infinity® addresses the most critical components - the sheathing and sealant.	<ul style="list-style-type: none"> <li>Pressure equalization technology to eliminate water penetration</li> <li>Compatible with nearly all Dryvit textures and finishes for aesthetic freedom.</li> <li>Backed by Dryvit's 12-year "through-the-wall" warranty against water intrusion</li> </ul>
<b>Stucco Systems</b>		
<b>StucCoat™ One-Coat System</b>	Dryvit's StucCoat One-Coat System is a complete stucco assembly for residential and commercial buildings. StucCoat One-Coat is a code-compliant assembly that may be installed over various approved sheathing surfaces. This assembly provides improved energy efficiency and higher R-values when combined with Dryvit Continuous Insulation (CI). StucCoat One-Coat is impact resistant, and may be installed as a conventional system coating (scratch & brown) complying with ASTM C926.	<ul style="list-style-type: none"> <li>Improved energy efficiency leading to costs savings</li> <li>Higher R values</li> <li>Impact resistant</li> <li>Can also be installed as a conventional coating system for versatility</li> <li>Can be installed with or without foam insulation</li> </ul>
<b>Commercial Cement Plaster (CCP) Systems</b>	A traditional stucco system over concrete or CMU construction with modern polymer technology applied to the finish. This provides the traditional stucco assembly without the inefficient exterior that has plagued stucco for centuries. Five available stucco systems with increasing durability and water-resistive properties. This choice in stucco systems allows for flexibility depending on the architect's desired performance.	<ul style="list-style-type: none"> <li>Durable exterior to resist weathering, cracking, and aging</li> <li>Water-resistive barrier to protect substrate from erosion and rust</li> <li>Aesthetic variety for design flexibility</li> <li>Improved surface moisture resistance</li> <li>Five systems offered to provide versatility depending on performance needs</li> </ul>
<b>Modulite™ Prefabricated Panel Systems</b>		
<b>Fedderlite® System</b>	A panel system that utilizes embedded reinforcing channels into the continuous insulation. This increases the ease of application by providing a means of panel handling and mechanical attachment to the wall.	<ul style="list-style-type: none"> <li>Ultra-lightweight for easier handling and on-site installation</li> <li>Unique, embedded reinforcing channels provide strength and enhanced handling</li> <li>Can be adhered, or mechanically fastened to approved substrates</li> </ul>
<b>Metalite® System</b>	A prefabricated panel system utilizing an Outsulation® system over a specifically designed light gauge metal frame and proprietary metal pan. This provides increased durability, water-resistance, and flexibility	<ul style="list-style-type: none"> <li>Lightweight for easier handling and installation</li> <li>Industry-unique system</li> <li>Can be applied to irregular surfaces providing increased construction flexibility</li> </ul>
<b>Outsulate® System</b>	A panelized system assembled in a factory-controlled environment and creates optimal application conditions as compared to field-assembled applications. Perfect for tight jobsites that don't allow much for equipment and scaffolding.	<ul style="list-style-type: none"> <li>Perfect for tight jobsites - just craned and joined to the structure</li> <li>Particularly advantageous in cold weather</li> <li>Maximum insulation in a single structural system</li> <li>Lightweight alternative to conventional systems</li> </ul>
<b>Architectural Shapes</b>		
<b>Architectural Shapes</b>	Adds a stately, classical architecture aesthetic to any building without the structural demands, material weight, labor requirement, or environmental impacts of actual stonework.  <b>Available shapes:</b> arches, bands, columns & pilasters, corbels & dentils, cornices, custom trim & signage, panel weep, sills, specialty pieces, starter boards, trim.	<ul style="list-style-type: none"> <li>All shapes are produced in 8 ft. lengths and can be cut to provide length flexibility</li> <li>Additional finishing options for seamless transitions and terminations</li> <li>Extensive colors, textures, and finishes to create the exact aesthetic for your structure</li> </ul>

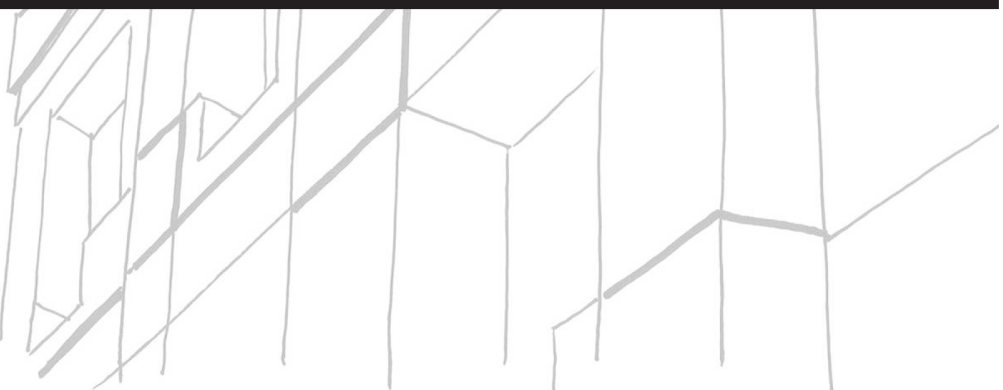



Dryvit is the manufacturer of Outsulation® systems, continuous insulation systems, Stucco systems, air & weather barriers, and building finishes & shapes. Now a part of Tremco Construction Products Group, Dryvit is a large contributor for Tremco's six-sided, all-in-one building products solutions.

Description	Advantages	Best For / Systems
<b>Adhesives &amp; Base Coats</b>		
<b>Genesis®</b> A fiber-reinforced, cement mixture to provide a high-build, exceptionally easy to trowel adhesive, base coat, and leveling coat. Used to adhere insulation board to substrates and as a base coat for mechanically fastened Dryvit Systems. It may also be used as a leveling coat for masonry and cementitious substrates to provide flexibility of substrates for Dryvit Systems.	<ul style="list-style-type: none"> <li>• Excellent durability &amp; adhesion for long-term performance</li> <li>• Trowels easily, thus more production</li> <li>• 3 products in one: adhesive, base coat, and leveling coat</li> <li>• Does not allow moisture buildup</li> <li>• Provides flexural strengths to reduce shrinkage cracks</li> </ul>	<ul style="list-style-type: none"> <li>• Insulation boards &amp; Dryvit-approved substrates</li> <li>• Mechanically fastened Dryvit systems</li> <li>• Masonry</li> <li>• Cementitious substrates</li> </ul>
<b>Primus®</b> A cement mixture to provide an exceptionally easy to trowel adhesive and base coat. Used to adhere insulation board to substrates and as a base coat for mechanically fastened Dryvit Systems. Also available as a single component, just-add-water, ready-to-use dry mix (Primus DM).	<ul style="list-style-type: none"> <li>• Excellent durability &amp; adhesion for long-term performance</li> <li>• Trowels easily, thus more production</li> <li>• 2 products in one: adhesive and base coat</li> <li>• Does not allow moisture buildup</li> </ul>	<ul style="list-style-type: none"> <li>• Insulation boards &amp; Dryvit-approved substrates</li> <li>• Masonry</li> <li>• Cementitious substrates</li> </ul>
<b>Rapidry® DM</b> A fast-setting, fiber-reinforced, cement-based dry blend adhesive and base coat for use with Dryvit Systems during colder weather. It is formulated to use when temperatures are between 35-50 °F (2-10 °C) while providing adequate working time.	<ul style="list-style-type: none"> <li>• Does not allow moisture build up</li> <li>• Excellent durability &amp; adhesion For long-term performance</li> <li>• Can adhere EPS &amp; base coat in The same day</li> <li>• Ready to use, just add water</li> <li>• Trowels easily for more production</li> <li>• Continue work during colder temperatures</li> </ul>	<ul style="list-style-type: none"> <li>• Insulation boards &amp; Dryvit-approved substrates</li> <li>• Cementitious substrates</li> </ul>
<b>Coatings, Stains &amp; Finishes</b>		
<b>Demandit®</b> A high-performance coating with a sheen finish that employs StratoTone™ colorant technology to be offered in a multitude of standard and custom colors. Along with being stain-resistant, it contains the most effective ingredients to resist mold and mildew growth on the coating for a longer-lasting, clean, and stain-free coating.	<ul style="list-style-type: none"> <li>• Increased stain &amp; fade resistance for a longer-lasting color</li> <li>• Resistant to dirt, mold, and mildew growth</li> <li>• Will not trap moisture vapor</li> <li>• Applied by brush, spray, or roll for jobsite flexibility</li> </ul>	<ul style="list-style-type: none"> <li>• EIFS</li> <li>• Concrete</li> <li>• Masonry</li> <li>• Stucco</li> <li>• Wood</li> <li>• Metal</li> </ul>
<b>Reflectit®</b> An acrylic coating able to emulate a metal panel's appearance with significant cost savings as opposed to metal panels. This is one of our most versatile finishes with a large variety of colors, finishes, and textures.	<ul style="list-style-type: none"> <li>• Ability to emulate a metal panel appearance with significant savings</li> <li>• Decreases project schedule</li> <li>• Consistent formulas to shorten lead times</li> <li>• Easy application for labor cost savings</li> </ul>	<ul style="list-style-type: none"> <li>• New or existing Dryvit finishes</li> </ul>
<b>Weatherlastic®</b> A line of textured finishes utilizing DPR (Dirt Pickup Resistant) chemistry and an elastomeric binder to bridge hairline cracks. These finishes are ideal for use as a protective and decorative coat over many substrates. Available in four textures: Quartputz, Sandpebble, Sandpebble Fine, and Adobe.	<ul style="list-style-type: none"> <li>• Bridges hairline cracks for a seamless look</li> <li>• Walls stay cleaner longer with DPR chemistry</li> <li>• Walls resist mildew longer for a cleaner finish</li> <li>• Finish lasts longer with a crack-resistant technology</li> </ul>	<ul style="list-style-type: none"> <li>• Stucco</li> <li>• Concrete</li> <li>• Masonry</li> <li>• CMU</li> <li>• EIFS</li> </ul>
<b>Stone, Masonry &amp; Quartz Finishes</b>		
<b>Ameristone™</b> A dramatic blend of natural aggregates varying in size and color, encased in a clear acrylic binder. It provides the architect and designer with a new level of durability and performance in an elegant stone finish.	<ul style="list-style-type: none"> <li>• 10 standard colors for aesthetic versatility</li> <li>• Excellent color retention for longer-lasting color</li> <li>• Consistent formula for shorter lead times</li> <li>• Greater flexibility for crack resistance and a longer life</li> <li>• Resistant to dirt and the growth of mold and mildew</li> </ul>	<ul style="list-style-type: none"> <li>• Stucco</li> <li>• Concrete</li> <li>• Masonry</li> </ul>
<b>Limestone™</b> Designed to replicate the appearance of limestone blocks without the cost of limestone blocks. It provides the finishing touch that adds lasting color and texture to exterior and interior walls. With DPR (Dirt Pickup Resistance) chemistry, it will remain cleaner for longer.	<ul style="list-style-type: none"> <li>• Inexpensively emulates realistic cut stone aesthetic</li> <li>• Reduces the structural demands for the exterior façade</li> <li>• Resistant to dirt and the growth of mold and mildew</li> </ul>	<ul style="list-style-type: none"> <li>• Masonry</li> <li>• Precast or cast-in-place concrete</li> <li>• Stucco</li> <li>• Other Dryvit-approved substrates</li> </ul>
<b>TerraNeo™</b> Offers a natural granite aggregate finish that establishes an innovative and exciting surface with distinctive features. It provides high-performance attributes that ensure a long-lasting, radiant finish to enhance the building's stature.	<ul style="list-style-type: none"> <li>• Inexpensively emulates labor-intensive granite</li> <li>• 10 standard colors for aesthetic versatility</li> <li>• Excellent color retention for longer-lasting color</li> <li>• Consistent formula for shorter lead times</li> <li>• Greater flexibility for crack resistance and a longer life</li> <li>• Resistant to dirt and the growth of mold and mildew</li> </ul>	<ul style="list-style-type: none"> <li>• Dryvit Exterior Insulation Systems</li> <li>• Cement plaster</li> <li>• Masonry</li> <li>• Tilt-up panels</li> <li>• Precast concrete panels</li> </ul>
<b>Textured Finishes</b>		
<b>StucCoat™ Finishes</b> A high quality, integrally colored finish designed to provide texture and color. Available in four textures: <b>Standard:</b> a rilled texture with large aggregate <b>Fine:</b> a uniform sand-type texture <b>Bold:</b> a larger, uniform aggregate texture without rills <b>Lace:</b> a uniform, smooth application with a random-area trowel for a stucco-like finish.	<ul style="list-style-type: none"> <li>• Offers design freedom to acquire unique aesthetics</li> <li>• Flexible and cleans up with water so the surface is easily maintainable</li> <li>• No mixing of color or painting to save on labor costs</li> <li>• Will not trap moisture vapor for a longer lasting finish</li> </ul>	<ul style="list-style-type: none"> <li>• Cast-in-place concrete</li> <li>• Pre-cast concrete</li> <li>• Stucco</li> <li>• Masonry</li> </ul>
<b>HDP™ Finishes</b> Premixed, acrylic-based finishes in a variety of standard and custom colors. Five finishes include: Quartputz, Sandblast, Sandpebble, Sandpebble Fine, and Limestone.	<ul style="list-style-type: none"> <li>• Hydrophobic finishes repel dirt and water for a cleaner wall appearance</li> <li>• Can also be used for interior applications for design flexibility</li> <li>• Premixed chemistry for labor and time savings</li> </ul>	<ul style="list-style-type: none"> <li>• Interior walls</li> <li>• Dryvit Reinforced Base Coat</li> <li>• Cast-in-place concrete</li> <li>• Pre-cast concrete</li> <li>• Stucco</li> <li>• Masonry</li> </ul>
<b>PMR™ Finishes</b> Proven Mildew Resistance (PMR) are designed to inhibit growth of mildew in difficult mildew-prone environments.  Available in eight textures: Quartputz, Quartputz E, Sandblast, Freestyle, Sandpebble, Sandpebble E, Sandpebble Fine, and Sandpebble Fine E. Available in two smooth coatings: Demandit and Weathercoat.	<ul style="list-style-type: none"> <li>• Proven resistance to the growth of molds and mildew</li> <li>• Ready to use; just add water to save on labor costs</li> <li>• Trowels easily, thus more production</li> <li>• Does not allow moisture buildup to avoid mildew</li> <li>• Design freedom with a multitude of standard and custom colors</li> <li>• Greater flexibility for crack resistance for a longer lasting finish</li> </ul>	<ul style="list-style-type: none"> <li>• Dryvit Reinforced Base Coat</li> <li>• Cast-in-place concrete</li> <li>• Pre-cast concrete</li> <li>• Stucco</li> <li>• Masonry</li> </ul>

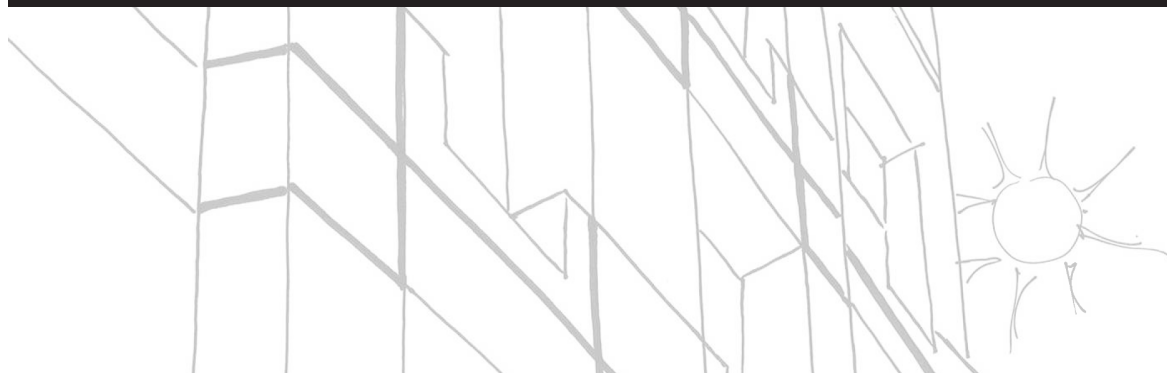

# POWER *of* ONE WARRANTY

## A Comprehensive System. A Single Warranty.

A Tremco CPG building envelope is a comprehensive system, and its components are warranted together in a single warranty document.

We're so confident in the performance of our solutions that if any one or more elements of your Tremco CPG building envelope proves defective, we'll cover the labor and material to fix it.

---

## Protect Your Investments.

Your property is a major investment, and its building envelope is a critical component. You get one chance to get it right... or you can spend many years and a lot of money trying to fix it.

Made up of hundreds, even thousands, of components, a building's enclosure protects interior spaces and occupants from the outside world. That includes shielding against the elements, excessive noise, and providing resistance to other disturbances.

Why cobble together an envelope with materials from dozens of different suppliers when you can choose a Tremco Construction Products Group (CPG) building envelope, designed and tested to work as one continuous system and warranted together in a single document?

---

## Systems Covered:

- Air & Vapor Barriers
- Cladding
- Glazing Systems
- Sealants & Adhesives
- Traffic Coatings
- Waterproofing
- Insulated Concrete Forms

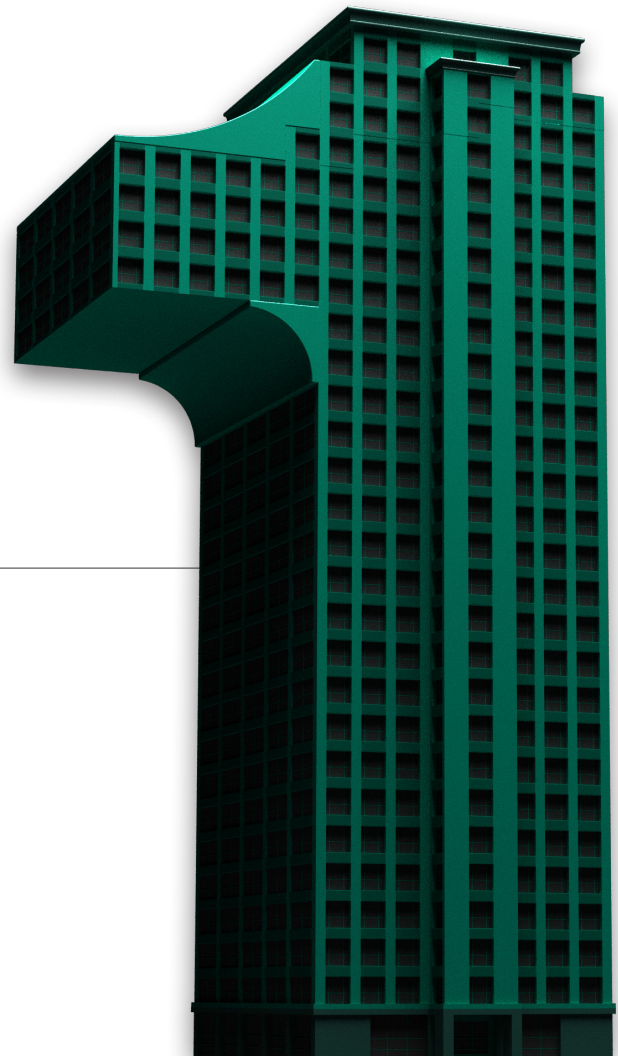



“They were able to give us a comprehensive warranty — covering the entire building — from a single source. That was impossible from anybody else. A great selling point for the owners.”

**500 Pacific Ave.  
Bremerton, Washington**

Dryvit Air Barriers and Prefabricated Panels  
Tremco Traffic Coatings and Sealants

3735 Green Road | Beachwood, OH 44122 | US: 800.852.9068 | CAN: 800.363.3213 | [tremcosealants.com](http://tremcosealants.com)

Tremco Construction Products Group (CPG) brings together Tremco CPG Inc. and its Dryvit and Nudura brands; Willseal; Prebuck LLC; Tremco Barrier Solutions, Inc.; Weatherproofing Technologies, Inc. and its Pure Air Control Services and Canam Building Envelope Specialists offerings; and Weatherproofing Technologies Canada, Inc.

 **TREMCO**  
Construction Products Group

Tremco® is a registered trademark of Tremco CPG Inc.  
Use of the ® symbol indicates registration with the US Patent & Trademark Office and the Canadian Intellectual Property Office.

[tremcocpg.com](http://tremcocpg.com)

